



**EZCURRA**

*S*ecurity

*I*nnovation

*Q*uality



**Blocking Device  
High Security Locks**

# Finishes



**Made in Spain**

**COMPLETELY MADE IN SPAIN**

Ezcurre is appointed as CE/UE  
Authorised Exporter No. ES/20/0120/12

# Index



## Blocking Device High Security Locks

**SB-2000B** \_\_\_ page 4

**SB-2004B** \_\_\_ page 4

**SB-2010/3** \_\_\_ page 5

**SB-2014/3** \_\_\_ page 5

**SB-2075/3** \_\_\_ page 6

**SB-2074/3** \_\_\_ page 6

**SB-3040** \_\_\_ page 7

**SB-3044** \_\_\_ page 7

**SB-9040** \_\_\_ page 8

**SB-9044** \_\_\_ page 8



## Master Keying System

page 9



## High Security Cylinders

**DS-15** \_\_\_ page 10

**DS-20** \_\_\_ page 10

**K-20** \_\_\_ page 11

**K-30** \_\_\_ page 11

**SEA-3** \_\_\_ page 12

**SEA-23** \_\_\_ page 12



## Escutcheons

**420-P** \_\_\_ page 13

**424-P** \_\_\_ page 13

**425-P** \_\_\_ page 13

**430-P** \_\_\_ page 13



## Security Set

page 14



## Accessories

page 15

Apart from their **BLOCKING DEVICE**, every high security lock in this catalogue feature an **ANTIBREACKAGE SYSTEM** which effectively protects the central steel bolts from being forced backwards

This system is **PATENTED** and **CERTIFIED** by an official approved center



# SB-2000B

# SB-2004B

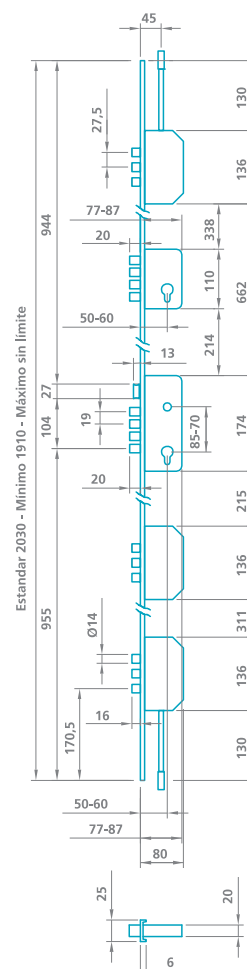
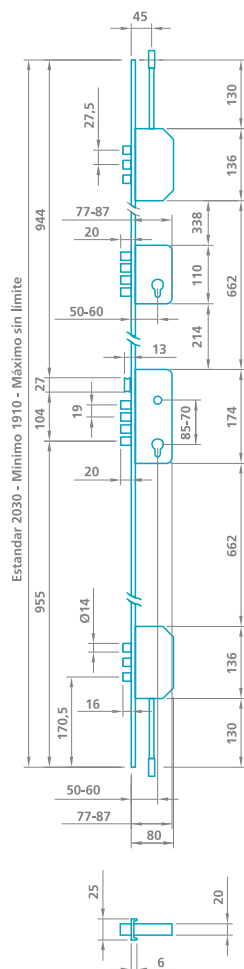

- BLOCKING DEVICE lock with ANTIBREACKAGE SYSTEM
  - Acts as SERVICE KEY
  - Round steel bolts
  - Reversible latch
  - 2 turns
  - Front plate profile: 25 x 6 mm.
  - Cylinders: DS-15, DS-10, K-20, K-30, SEA
  - Backsets: 50/60 mm. Centres: 85/70 mm.
  - Front plate finishes:
- |  | Height (m.)  |
|--|--------------|
| Brass / Chromed brass  | 2,03         |
| "U" brass / "U" chromed brass                                  | 2,03         |
| Golden / Silver finish aluminium                               | 2,03<br>2,11 |
| Golden / Matt Chrome / Nickel / Bronze / Black enamel on steel | 2,03<br>2,11 |
| Stainless steel / Chrome on steel                              | 2,03<br>2,11 |
- Escutcheons: 424-P 425-P  
420-P 430-P
  - Striking plates: Short pieces  
Long pieces: 30/40/45 mm.
- Note: SB-2000B/3 has no upwards / downwards locking points*

- BLOCKING DEVICE lock with ANTIBREACKAGE SYSTEM
  - Acts as SERVICE KEY
  - Round steel bolts
  - Reversible latch
  - 2 turns
  - Front plate profile: 25 x 6 mm.
  - Cylinders: DS-15, DS-10, K-20, K-30, SEA
  - Backsets: 50/60 mm. Centres: 85/70 mm.
  - Front plate finishes:
- |  | Height (m.)  |
|--|--------------|
| Brass / Chromed brass  | 2,03         |
| Golden / Silver finish aluminium                               | 2,03<br>2,11 |
| Golden / Matt Chrome / Nickel / Bronze / Black enamel on steel | 2,03<br>2,11 |
| Stainless steel / Chrome on steel                              | 2,03<br>2,11 |
- Escutcheons: 424-P 425-P  
420-P 430-P
  - Striking plates: Short pieces  
Long pieces: 30/40/45 mm.
- Note: SB-2000B/3 has no upwards / downwards locking points*

# SB-2010/3

# SB-2014/3

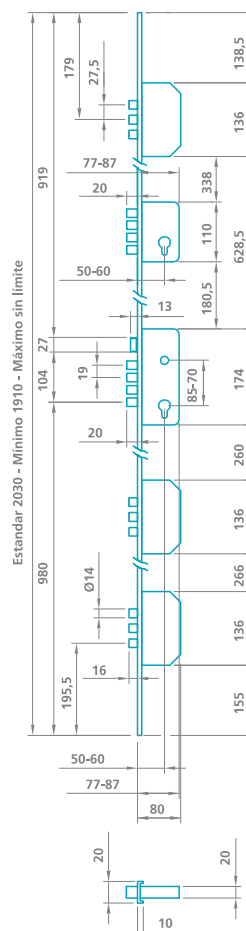
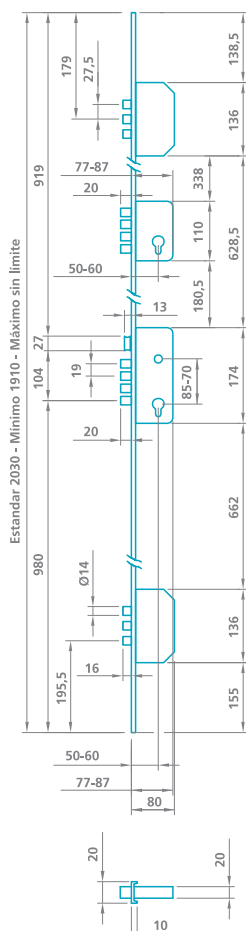

- BLOCKING DEVICE lock with ANTIBREACKAGE SYSTEM
  - Acts as SERVICE KEY
  - Round steel bolts
  - Reversible latch
  - 2 turns
  - Front plate profile: 20 x 10 mm.
  - Cylinders: DS-15, DS-10, K-20, K-30, SEA
  - Backsets: 50 / 60 mm.
  - Centres: 85 / 70 mm.
  - Front plate finishes:
- |  | Height<br>(m.) |
|--|----------------|
| Golden / Matt chrome / Nickel / Bronze / Black enamel on steel | 2,03<br>2,11   |
| Stainless steel / Chrome on steel                              | 2,03<br>2,11   |
- Escutcheons: 424-P 425-P  
420-P 430-P
  - Striking plates: Short pieces  
Long pieces: 30/40/45 mm.

- BLOCKING DEVICE lock with ANTIBREACKAGE SYSTEM
  - Acts as SERVICE KEY
  - Round steel bolts
  - Reversible latch
  - 2 turns
  - Front plate profile: 20 x 10 mm.
  - Cylinders: DS-15, DS-10, K-20, K-30, SEA
  - Backsets: 50 / 60 mm.
  - Centres: 85 / 70 mm.
  - Front plate finishes:
- |  | Height<br>(m.) |
|--|----------------|
| Golden / Matt chrome / Nickel / Bronze / Black enamel on steel | 2,03<br>2,11   |
| Stainless steel / Chrome on steel                              | 2,03<br>2,11   |
- Escutcheons: 424-P 425-P  
420-P 430-P
  - Striking plates: Short pieces  
Long pieces: 40 / 45 mm.

# SB-2075/3

# SB-2074/3

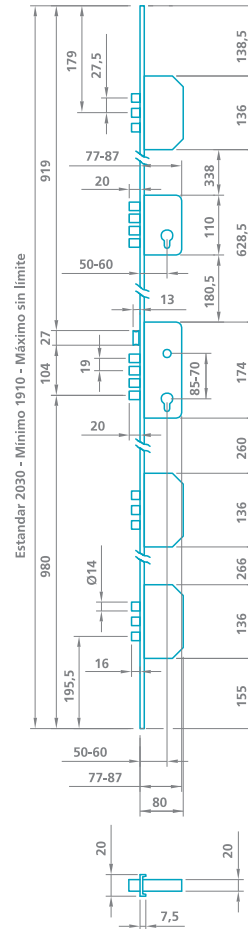
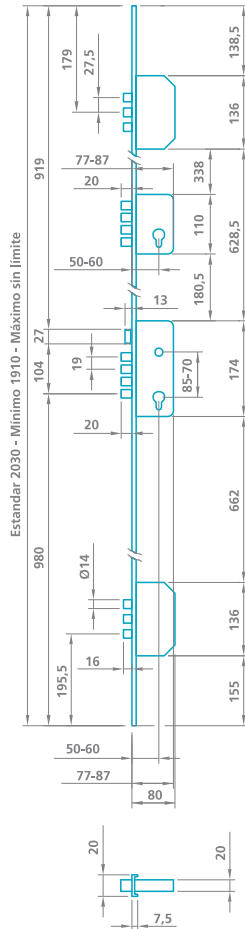

- BLOCKING DEVICE lock with ANTIBREACKAGE SYSTEM
- Acts as SERVICE KEY
- Round steel bolts
- Reversible latch
- 2 turns
- Front plate profile: 20 x 7'5 mm.
- Cylinders: DS-15, DS-10, K-20, K-30, SEA
- Backsets: 50 / 60 mm.
- Centres: 85 / 70 mm.
- Front plate finishes:
 

	Height (m.)
Golden / Matt chrome / Nickel / Bronze / Black enamel on steel	2,03 2,11
Stainless steel / Chrome on steel	2,03 2,11
- Escutcheons: 424-P 425-P  
420-P 430-P
- Striking plates: Short pieces  
Long pieces: 30/40/45 mm.

- BLOCKING DEVICE lock with ANTIBREACKAGE SYSTEM
- Acts as SERVICE KEY
- Round steel bolts
- Reversible latch
- 2 turns
- Front plate profile: 20 x 7'5 mm.
- Cylinders: DS-15, DS-10, K-20, K-30, SEA
- Backsets: 50 / 60 mm.
- Centres: 85 / 70 mm.
- Front plate finishes:
 

	Height (m.)
Golden / Matt chrome / Nickel / Bronze / Black enamel on steel	2,03 2,11
Stainless steel / Chrome on steel	2,03 2,11
- Escutcheons: 424-P 425-P  
420-P 430-P
- Striking plates: Short pieces  
Long pieces: 40 / 45 mm.

# SB-3040

# SB-3044

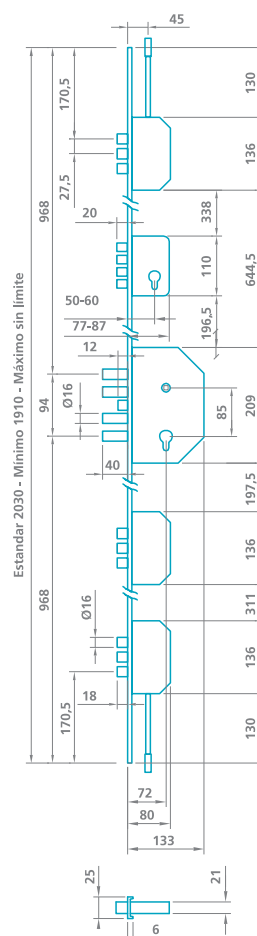
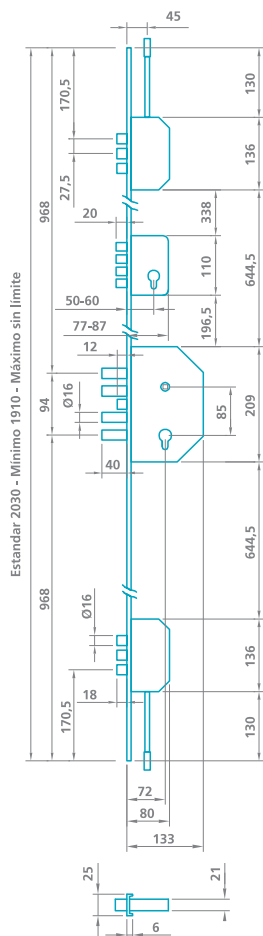

- BLOCKING DEVICE lock with ANTIBREACKAGE SYSTEM
- Acts as SERVICE KEY
- Round steel bolts Ø 16 mm.
- Reversible latch
- 4 turns
- Closed cases
- Front plate profile: 25 x 8 mm.
- Front plate "Z" profile available in aluminium or enamel on steel
- Cylinders: DS-15, DS-10, K-20, K-30, SEA
- Backset: 72 mm.
- Centres: 85 / 70 mm.
- Front plate finishes:

	Height (m.)
Brass / Chromed brass	2,03
Golden / Silver finish aluminium	2,03
Golden / Matt Chrome / Nickel / Bronze / Black enamel on steel	2,03 2,11
Stainless steel / Chrome on steel	2,03 2,11
Golden / Silver finish aluminium "Z"	2,03 2,11
Golden / Matt Chrome / Nickel / Bronze / Black enamel "Z"	2,03 2,11

- Escutcheons: 424-P 425-P  
420-P 430-P
- Striking plates: Short pieces  
Long pieces: 40 / 45 mm.

Note: SB-3040/3 has no upwards / downwards locking points

- BLOCKING DEVICE lock with ANTIBREACKAGE SYSTEM
- Acts as SERVICE KEY
- Round steel bolts Ø 16 mm.
- Reversible latch
- 4 turns
- Closed cases
- Front plate profile: 25 x 8 mm.
- Front plate "Z" profile available in aluminium or enamel on steel
- Cylinders: DS-15, DS-10, K-20, K-30, SEA
- Backset: 72 mm.
- Centres: 85 / 70 mm.
- Front plate finishes:

	Height (m.)
Brass / Chromed brass	2,03
Golden / Silver finish aluminium	2,03
Golden / Matt Chrome / Nickel / Bronze / Black enamel on steel	2,03 2,11
Stainless steel / Chrome on steel	2,03 2,11
Golden / Silver finish aluminium "Z"	2,03 2,11
Golden / Matt Chrome / Nickel / Bronze / Black enamel "Z"	2,03 2,11

- Escutcheons: 424-P 425-P  
420-P 430-P
- Striking plates: Short pieces  
Long pieces: 40 / 45 mm.

Note: SB-3044/3 has no upwards / downwards locking points

# SB-9040

# SB-9044

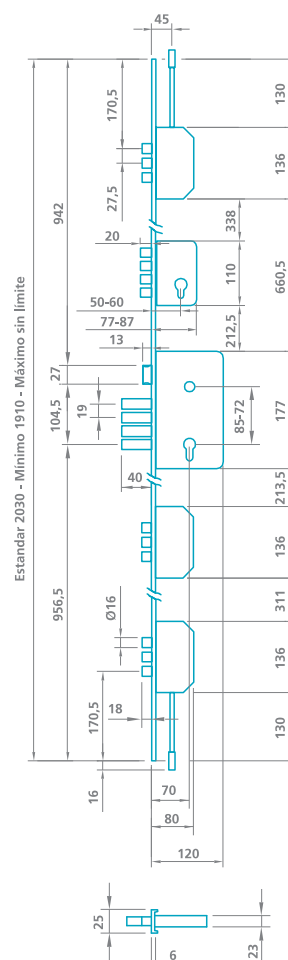
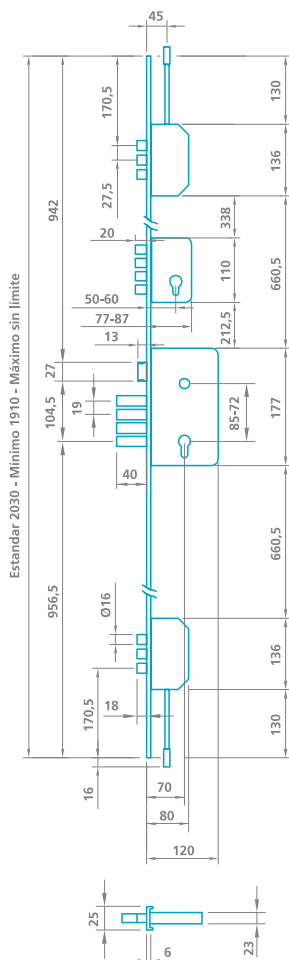

- BLOCKING DEVICE lock with ANTIBREACKAGE SYSTEM
  - Acts as SERVICE KEY
  - Round steel bolts Ø 16 mm.
  - Reversible latch
  - 4 turns
  - Closed cases
  - Front plate profile: 25 x 8 mm.
  - Cylinders: DS-15, DS-10, K-20, K-30, SEA
  - Backset: 70 mm.
  - Centres: 85 / 70 mm.
  - Front plate finishes:
- |  | Height (m.)  |
|--|--------------|
| Brass / Chromed brass  | 2,03         |
| Golden / Matt Chrome / Nickel / Bronze / Black enamel on steel | 2,03<br>2,11 |
| Stainless steel / Chrome on steel                              | 2,03<br>2,11 |
- Escutcheons: 424-P 425-P  
420-P 430-P
  - Striking plates: Short pieces  
Long pieces: 40 / 45 mm.

Note: SB-9040/3 has no upwards / downwards locking points

- BLOCKING DEVICE lock with ANTIBREACKAGE SYSTEM
  - Acts as SERVICE KEY
  - Round steel bolts Ø 16 mm.
  - Reversible latch
  - 4 turns
  - Closed cases
  - Front plate profile: 25 x 8 mm.
  - Cylinders: DS-15, DS-10, K-20, K-30, SEA
  - Backset: 70 mm.
  - Centres: 85 / 70 mm.
  - Front plate finishes:
- |  | Height (m.)  |
|--|--------------|
| Brass / Chromed brass  | 2,03         |
| Golden / Matt Chrome / Nickel / Bronze / Black enamel on steel | 2,03<br>2,11 |
| Stainless steel / Chrome on steel                              | 2,03<br>2,11 |
- Escutcheons: 424-P 425-P  
420-P 430-P
  - Striking plates: Short pieces  
Long pieces: 40 / 45 mm.

Note: SB-9044/3 has no upwards / downwards locking points



## Master keying system

EZCURRA has developed a masterkeying system that provides Comfort, Performance and Security. For comfort, Ezcurra's master keying system affords the possibility to reduce the usual bunch of keys to only one, able to open the most commonly used locks and cylinders. High Performance and Security, due to the precision and excellent technical features of our cylinders, which allow all kind of keying systems, from the simple master key suite to the grand master key one.

In this way, house entrance doors, post boxes, elevators, garages, desk, and so on, all can be easily masterkeyed to user's convenience.

Nowadays housing, condominiums, offices, hospitals and companies of any size enjoy the quality and security of EZCURRA's master keying system.



### Communal Entrance Master keying

Group of Locks each one having its own individual key that gives access to its own door and all communal services i.e.: main entrance, garage, lift, terraces, storerooms, etc.

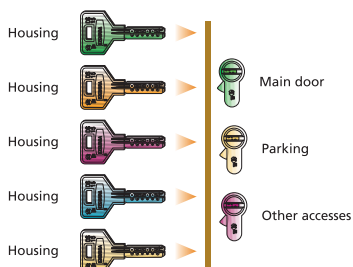

### Simple Master keying

Group of Locks each one having its own individual keys, which opens only that door, and a Master key which opens all the locks. Suitable for offices, warehouses, etc.

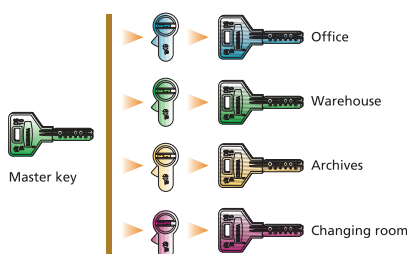

### Group Master keying

Several independent groups of Locks each one having its own Master key, and a Grand Master key, which opens all the doors in the locking plan. Suitable for hotels, administrative buildings, schools, companies, etc.

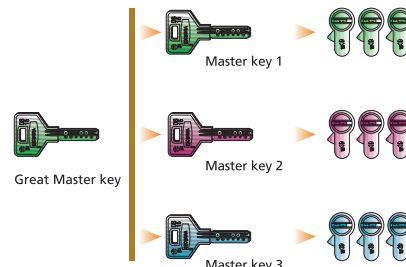

## DS-15

## DS-10

### Common features

- High security double cylinder with european profile.
- Anti - picklock profile.
- Front drilling resistant.
- High keying possibilities.
- Wide range of sizes, finishes and models: knob cylinders, half-cylinders, switch cylinders, double clutch cylinders, etc.
- *Finishes:* Brass/Chrome  
Matt chrome/Black
- **COMPLETELY MADE IN SPAIN**
- Cylinder complies with certification CE UNE-EN 1303:2006



Cylinder DS-15

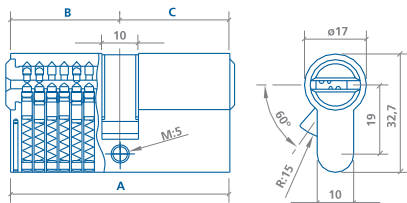

Cylinder DS-10

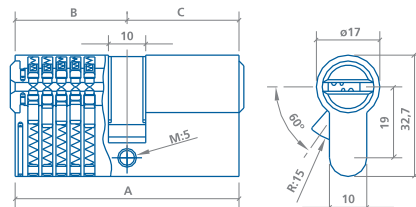

Switch cylinder DS-15

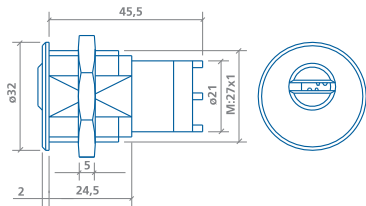

Switch cylinder DS-10

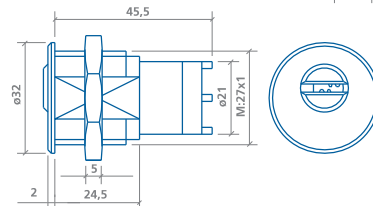

- Double fitting 9 pins in two rows: 3 up + 6 down.
- Front drilling resistance by tempered steel bars.
- 5 Reversible dimple keys on chromed brass.

- Double fitting 10 pins in two rows (5 up + 5 down) + 1 steel ball on the side.
- Front drilling resistance by tempered steel bars in tube and drum.
- 5 Reversible dimple keys on nickel silver.



### sizes

A	B	C	A	B	C	A	B	C	A	B	C
60 mm. (30-30)			● 75 mm. (35-40)			85 mm. (30-55)			90 mm. (30-60)		
65 mm. (30-35)			● 80 mm. (40-40)			● 85 mm. (35-50)			● 90 mm. (35-55)		
● 70 mm. (35-35)			80 mm. (30-50)			● 90 mm. (45-45)			● 95 mm. (40-55)		
70 mm. (30-40)			● 80 mm. (35-45)			● 90 mm. (40-50)			● 100 mm. (50-50)		
75 mm. (30-45)									● 120 mm. (60-60)		

● Available in double clutch version.

## K-20

## K-30

### Common features

- High security cylinder with **17 pins** (12 in two rows + 5 in an extra side row) acting to achieve a sophisticated security system which increases exponentially its **master keying** possibilities.
- **Anti-picklock** and **antibumping** european profile.
- **Front drilling resistance** by tempered steel ring in the drum and tempered steel bar in the tube.
- Wide range of sizes and versions: knob cylinders, double clutch cylinders, half cylinders, switch cylinders, etc.
- Finishes: Brass / Chromed brass / Matt chrome / Black
- **COMPLETELY MADE IN SPAIN**
- Cylinder complies with certification CE UNE-EN 1303:2006

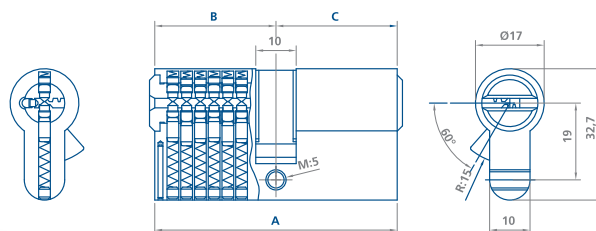
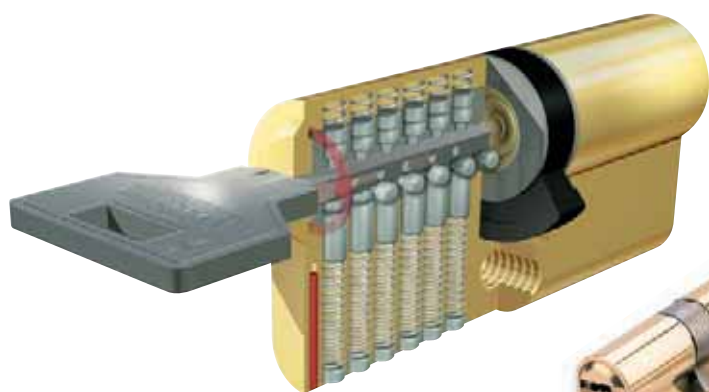

- Triple fitting 17 brass pins in 2 rows of 6 pins + 1 extra row of 5 pins on the side.
- 5 Reversible dimple keys on chromed brass.

- Triple fitting 17 STAINLESS STEEL pins in 2 rows of 6 pins + 1 extra row of 5 STAINLESS STEEL pins on the side.
- 5 Reversible dimple keys on nickel silver.



### sizes

A	B	C	A	B	C	A	B	C	A	B	C		
60 mm.	(30-30)		● 75 mm.	(35-40)		85 mm.	(30-55)		90 mm.	(30-60)		● 100 mm.	(40-60)
65 mm.	(30-35)		● 80 mm.	(40-40)		● 85 mm.	(35-50)		● 90 mm.	(35-55)		● 110 mm.	(55-55)
● 70 mm.	(35-35)		80 mm.	(30-50)		● 90 mm.	(45-45)		● 95 mm.	(40-55)		● 110 mm.	(50-60)
70 mm.	(30-40)		● 80 mm.	(35-45)		● 90 mm.	(40-50)		● 100 mm.	(50-50)		● 120 mm.	(60-60)
75 mm.	(30-45)												

● Available in double clutch version.

# SEA 23 / SEA 3 EUROPROFILE

## Switch cylinder

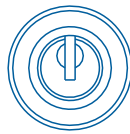
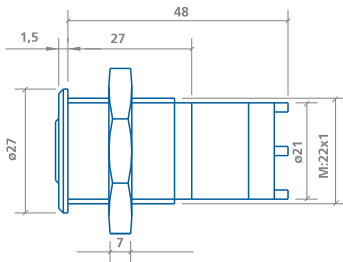

### europofile sizes

A	B	C
60 mm.	(30-30)	
65 mm.	(30-35)	
70 mm.	(35-35)	
70 mm.	(30-40)	
75 mm.	(35-40)	
75 mm.	(30-45)	
80 mm.	(40-40)	
80 mm.	(30-50)	
80 mm.	(35-45)	
85 mm.	(30-55)	
85 mm.	(35-50)	
85 mm.	(40-45)	
90 mm.	(30-60)	
90 mm.	(40-50)	
95 mm.	(40-55)	
100 mm.	(50-50)	
100 mm.	(30-70)	
100 mm.	(40-60)	
110 mm.	(30-80)	
110 mm.	(40-70)	
110 mm.	(50-60)	
120 mm.	(60-60)	
120 mm.	(30-90)	
120 mm.	(40-80)	
120 mm.	(50-70)	

### Security cards



- High security double cylinders SEA-23 and SEA-3.
- Front drilling resistant by tempered steel bars.
- Five reversible nickelsilver keys.
- It combines a double row of suspended pins with an extra row at the flank, performing a perfect multilock system.
- High keying possibilities.
- Wide range of sizes, finishes and models: knob cylinders, half-cylinders, switch cylinders, etc.
- *Finish: Chrome*

## Common features

- Useful protective escutcheons for our whole range of high security european profile locks.
- Specially designed to avoid grasping actions.
- *Finishes:* Golden / Matt Chrome / Nickel / Bronze / Black enamel / Chrome
- Stainless steel in 420-P, 425-P and 430-P

## 420-P

- Including three pieces: *escutcheon, internal plate* and *tempered steel cylinder's cap* with an edge that protects the cylinder from being extracted.

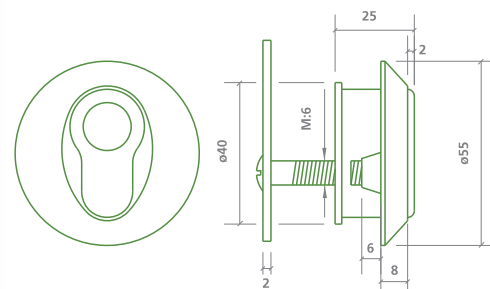

## 424-P

- Double security escutcheon.
- Including three pieces: *escutcheon, internal plate* and *tempered steel cylinder's cap* with an edge that protects the cylinder from being extracted.
- The *escutcheon* is fastened through the *internal plate* by a strong screw fixing system. The *cylinder's cap* is fixed by two screws through the lock.
- Available *steel plate* to be placed between the lock and the door's armouring sheet which provides highest protection of the lock and the cylinder, and avoids taking the cylinder's cap out.
- Available *decorative plate*.

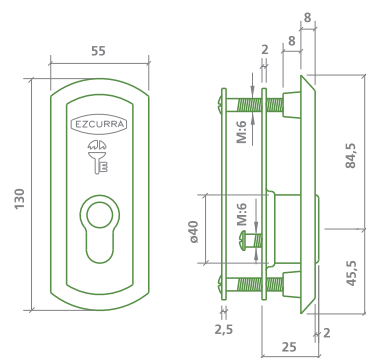

## 425-P

- 420-P escutcheon plus decorative plate.

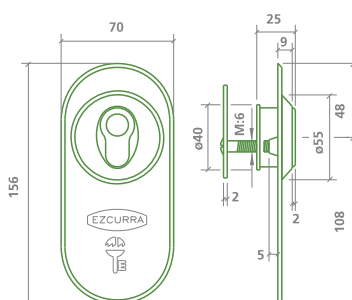

## 430-P

- Including three pieces: *tempered steel escutcheon, internal plate* and *brass cover*.
- Hidden cylinder.
- Available washers for exact assembly.
- *Decorative plate* on request.

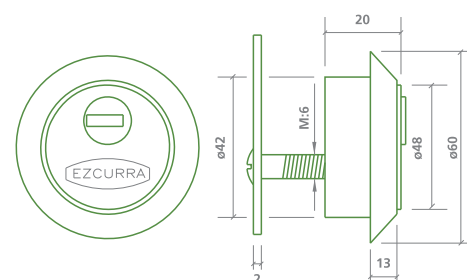

The security set  
made up of:

- **Z profile lock**
- **Angular striking plate**
- **Security hinge**
- **Crosspieces**

provides the door structure with  
great strength, achieving a very  
sturdy security system.





## Long angular striking plate

■ 45 mm.  
x 2,03 / 2,11 m.



## Hinge

■ U+L shaped reversible SECURITY HINGE with 4 bearings, available in the following finishes and sizes:

Golden / Matt Chrome / Nickel  
Bronze / Black enamel on Steel

Width	Height
40 mm.	2.03 m.
45 mm.	2.03 / 2.11 m.



## Crosspieces

■ Security crosspieces and angular profiles available in following finishes and sizes:

Golden / Matt Chrome / Nickel / Bronze  
Black enamel on steel

1 m. x 40 / 45 mm.

Golden / Silver finish aluminium

90 cm. / 1 m. x 40 / 45 mm.

M-type  
Lever protection box



V-type  
Lever protection box



## Boxes for lever protection

### ■ M-type

Protects central as well as accessory bolts from lever actions

### ■ V-type

Apart from protecting the central bolts from lever actions, it is provided with a special device to fit the latch.

**Ezcurra-Esko, S.A.**

P.O.Box 5  
20540 Escoriaza. (Guipúzcoa) Spain



Tel.: +34 943 71 51 00

Fax: +34 943 71 41 00

---

e-mail: [ezcurra@ezcurra.com](mailto:ezcurra@ezcurra.com) • [www.ezcurra.com](http://www.ezcurra.com)





**EZCURRA**

*S*ecurity

*I*nnovation

*Q*uality

**Mortise & Rim Locks. Deadbolts**

**Made in Spain**

**COMPLETELY MADE IN SPAIN**

Ezcurra is appointed as CE/UE  
Authorised Exporter No. ES/20/0120/12

# Index



## Mortise Locks

Cylinder Locks	1100	page 4
	3100	page 4
	4000	page 4
Blocking device locks	3300	page 4
	4300	page 5
Mortise Locks and Latch	1200	page 5
	4200	page 6
	4100	page 6



## Rim Locks

1124	page 7
1125	page 7
1125C	page 7
1125P	page 8
5004	page 8



## Deadbolts

300	page 9
325	page 9
350	page 9
400R	page 10
401	page 10
450R	page 11
451	page 11
500R	page 12
501	page 12
550R	page 13
551	page 13



## Cylinders

Monoblock Cylinder	page 14
--------------------	---------



## Accessories

page 14
---------



## Finishes

page 15
---------



# Cylinder Mortise Locks

**EZCURRA**

# 1100



	A	B
1100 / 35	35	63
1100 / 40	40	68

# 3100



	A	B
3100 / 35	35	62
3100 / 40	40	67
3100 / 45	45	72
3100 / 50	50	77
3100 / 60	60	87
3100 / 70	70	97

# 4000



	A	B
4000 / 30	30	57
4000 / 35	35	62
4000 / 40	40	67
4000 / 45	45	72
4000 / 50	50	77
4000 / 60	60	87
4000 / 70	70	97

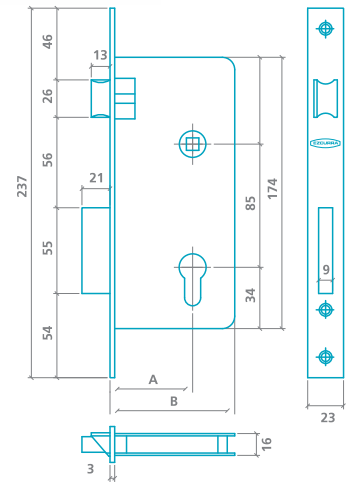
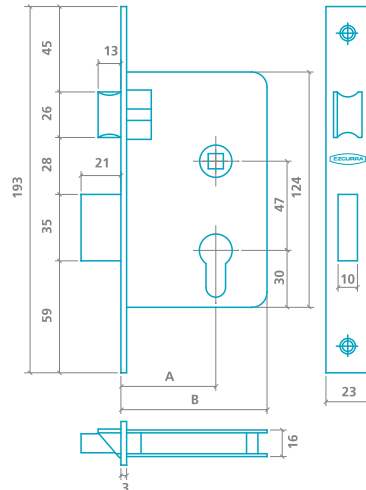
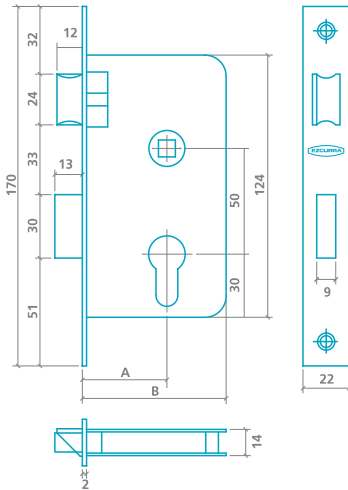

- Cylinder mortise lock
- Steel bolt
- 1 turn
- Centres: 50 mm.
- Reversible Latch
- Europrofile cylinder + 3 keys
- Striking plate
- Escutcheon
- *Finishes:*

Brass / Brassed  
 Chrome  
 Golden / Matt Chrome / Nickel /  
 Bronze / Black enamel

- Cylinder mortise lock
- Steel bolt
- 2 turns
- Centres: 47 mm.
- Reversible Latch
- Europrofile cylinder + 3 keys
- Striking plate
- Escutcheon
- *Finishes:*

Brass / Brassed  
 Chrome  
 Golden / Matt Chrome / Nickel /  
 Bronze / Black enamel  
 Stainless Steel

- Cylinder mortise lock
- Steel bolt
- 2 turns
- Centres: 85 mm.
- Reversible Latch
- Europrofile cylinder + 3 keys
- Striking plate
- Escutcheon
- *Finishes:*

Brass / Brassed  
 Chrome  
 Golden / Matt Chrome / Nickel /  
 Bronze / Black enamel  
 Stainless Steel

## 3300



	A	B
3300 / 35	35	62
3300 / 40	40	67
3300 / 45	45	72
3300 / 50	50	77
3300 / 60	60	87
3300 / 70	70	97

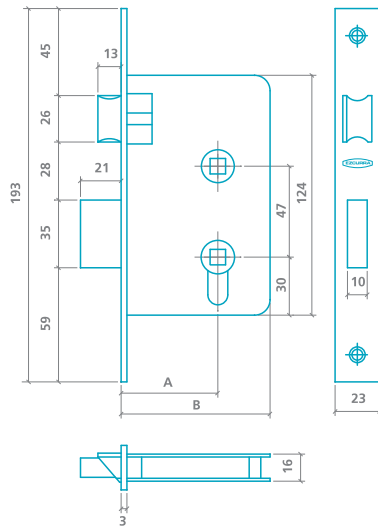

- Mortise lock with inner blocking device
- Steel bolt
- 2 turns
- Centres: 47 mm.
- Reversible Latch
- Inside blocking device
- Striking plate
- *Finishes:*
  - Brass / Brassed
  - Chrome
  - Golden / Matt Chrome / Nickel / Bronze / Black enamel

## 4300

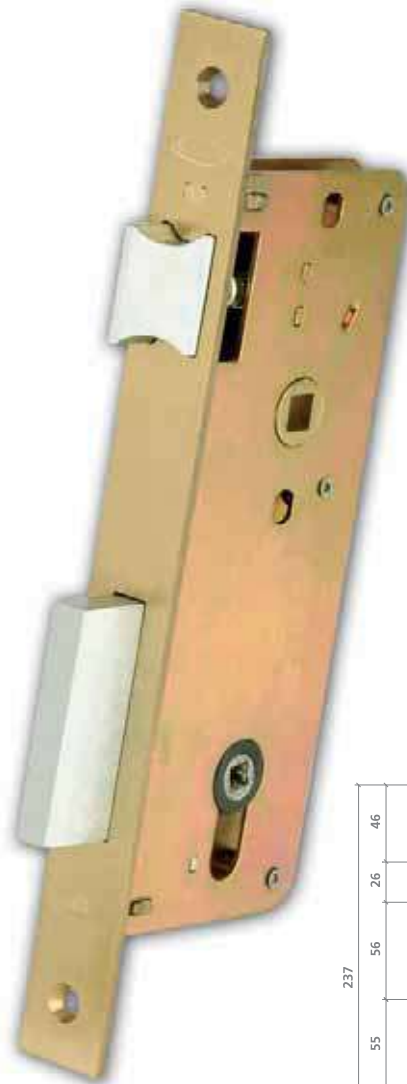

	A	B
4300 / 30	30	57
4300 / 35	35	62
4300 / 40	40	67
4300 / 45	45	72
4300 / 50	50	77
4300 / 60	60	87
4300 / 70	70	97

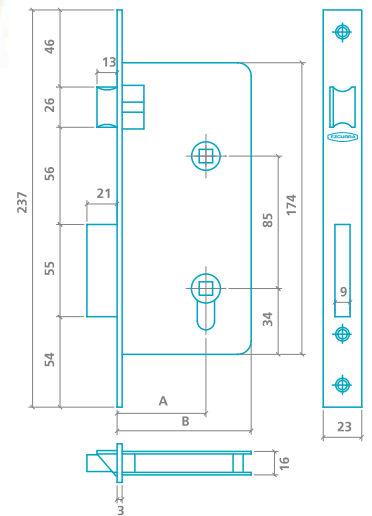

- Mortise lock with inner blocking device
- Steel bolt
- 2 turns
- Centres: 85 mm.
- Reversible Latch
- Inside blocking device
- Striking plate
- *Finishes:*
  - Brass / Brassed
  - Chrome
  - Golden / Matt Chrome / Nickel / Bronze / Black enamel

## 1200



	A	B
1200 / 35	35	63
1200 / 40	40	68

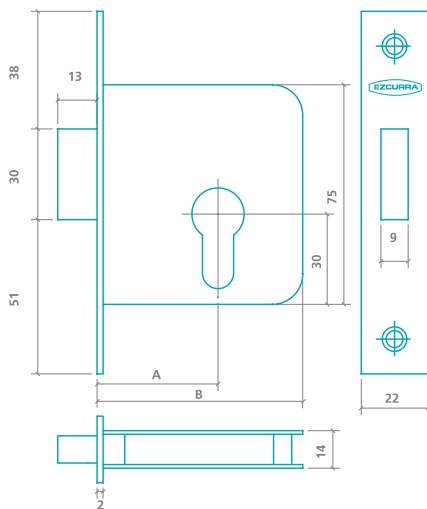

- Cylinder mortise lock
- Steel bolt
- 1 turn
- Europrofile cylinder + 3 keys
- Striking plate
- Escutcheon
- *Finishes:*  
 Brass / Brassed  
 Chrome  
 Golden / Matt Chrome / Nickel /  
 Bronze / Black enamel

## 4200

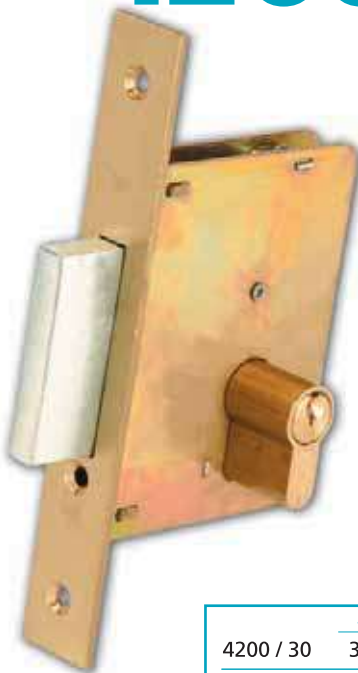

	A	B
4200 / 30	30	57
4200 / 35	35	62
4200 / 40	40	67
4200 / 45	45	72
4200 / 50	50	77
4200 / 60	60	87
4200 / 70	70	97

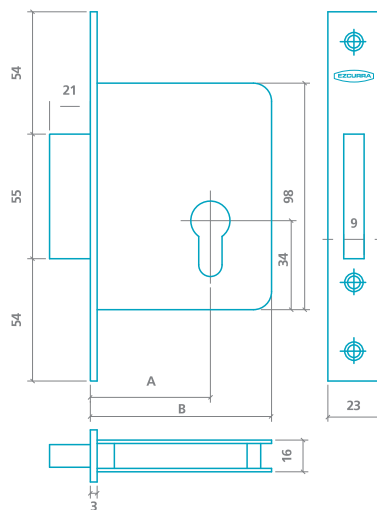

- Cylinder mortise lock
- Steel bolt
- 2 turns
- Europrofile cylinder + 3 keys
- Striking plate
- Escutcheon
- *Finishes:*  
 Brass / Brassed  
 Chrome  
 Golden / Matt Chrome / Nickel /  
 Bronze / Black enamel

## 4100



	A	B
4100 / 30	30	57
4100 / 35	35	62
4100 / 40	40	67
4100 / 45	45	72
4100 / 50	50	77
4100 / 60	60	87
4100 / 70	70	97

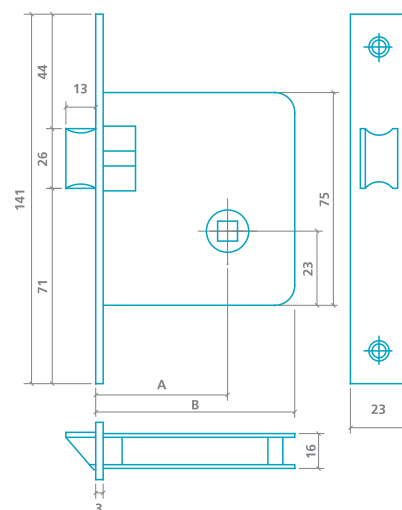

- Mortise Latch
- Reversible latch
- Spindle bar 8 mm.
- Striking plate
- *Finishes:*  
 Brass / Brassed  
 Chrome  
 Golden / Matt Chrome / Nickel /  
 Bronze / Black enamel

# 1124

# 1125

# 1125C



	A	B
1124 / 80	40	80
1124 / 100	50	100
1124 / 120	60	120
1124 / 140	70	140

	A	B
1125 / 80	40	80
1125 / 100	50	100
1125 / 120	60	120
1125 / 140	70	140

	A	B
1125C / 80	40	80
1125C / 100	50	100
1125C / 120	60	120
1125C / 140	70	140

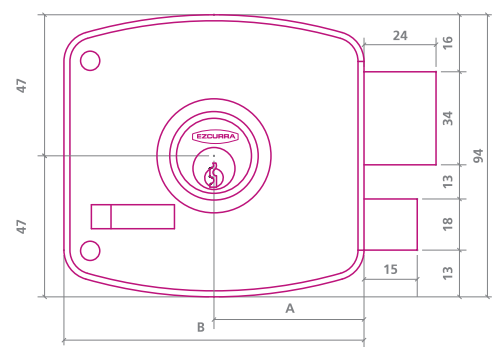
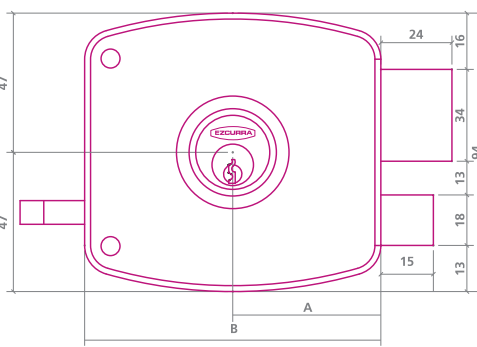
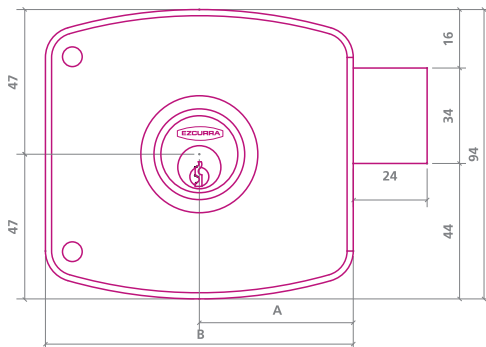

- Rim lock with double round cylinder
- Steel bolt
- 2 turns
- Round cylinder + 3 keys
- Striking plate
- Escutcheon
- *Finishes:*  
Golden enamel / Chrome

- Rim lock with double round cylinder
- Steel bolt
- 2 turns
- Latch
- Inner draw back pull
- Round cylinder + 3 keys
- Striking plate
- Escutcheon
- *Finishes:*  
Golden enamel / Chrome

- Rim lock with double round cylinder
- Steel bolt
- 2 turns
- Latch
- Inner draw back pull
- Round cylinder + 3 keys
- Striking plate
- Escutcheon
- *Finishes:*  
Golden enamel / Chrome

# 1125P

# 5004



	A	B
1125P / 80	40	80
1125P / 100	50	100
1125P / 120	60	120
1125P / 140	70	140

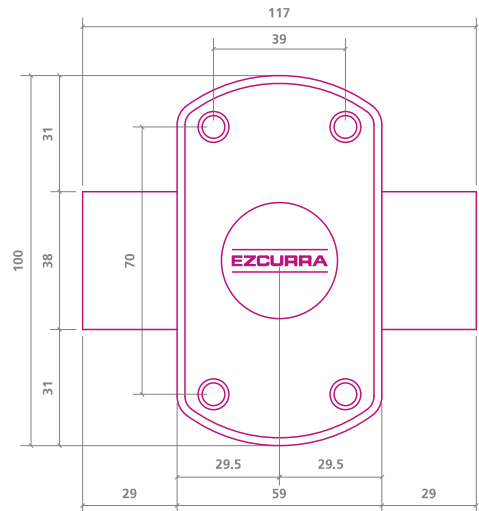
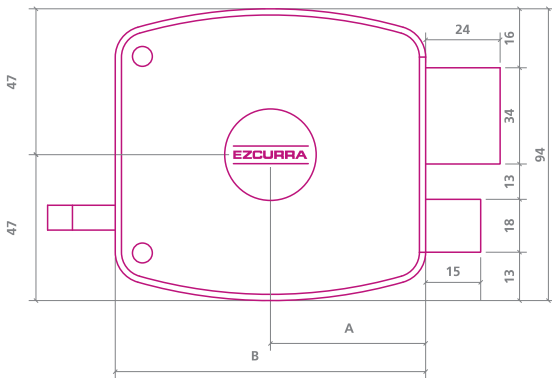

- Rim lock with round cylinder and knob
- Steel bolt
- 2 turns
- Latch
- Inner draw back pull and knob
- Round cylinder + 3 keys
- Striking plate
- Escutcheon
- *Finishes:*  
Golden enamel / Chrome

- Deadbolt with round cylinder outside and knob inside
- Steel bolt
- 2 turns
- Round cylinder + 3 keys
- Striking plate
- Escutcheon
- *Finishes:*  
Golden enamel / Chrome



# 300

# 325

# 350

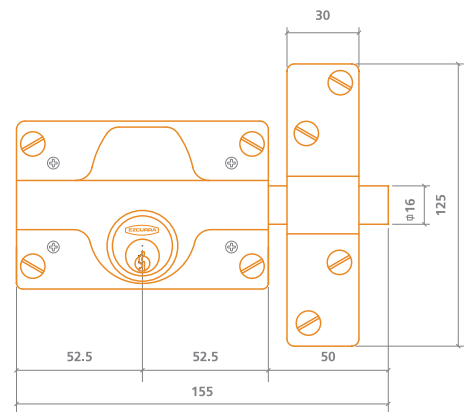
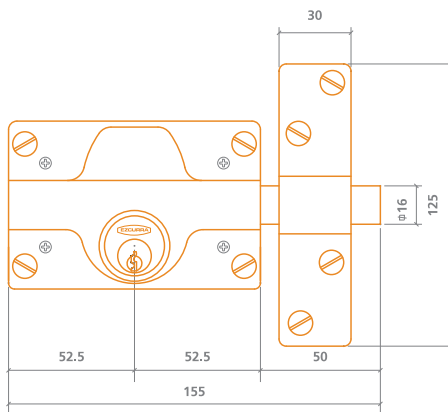
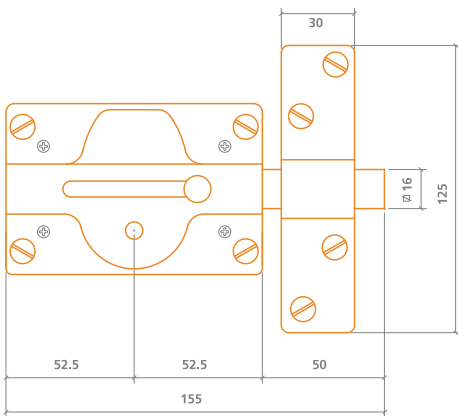

Deadbolt with cylinder outside

Steel bolt

4 turns

Round cylinder + 3 keys

Escutcheon

Finishes:

Brassed / Chrome

Golden / Matt Chrome / Nickel /

Bronze / Black enamel

Deadbolt with cylinder outside

Steel bolt

4 turns

Round cylinder + 3 keys

Escutcheon

Finishes:

Brassed / Chrome

Golden / Matt Chrome / Nickel /

Bronze / Black enamel

Deadbolt with cylinder outside

Steel bolt

4 turns

Round cylinder + 3 keys

Escutcheon

Finishes:

Brassed / Chrome

Golden / Matt Chrome / Nickel /

Bronze / Black enamel

# 400R

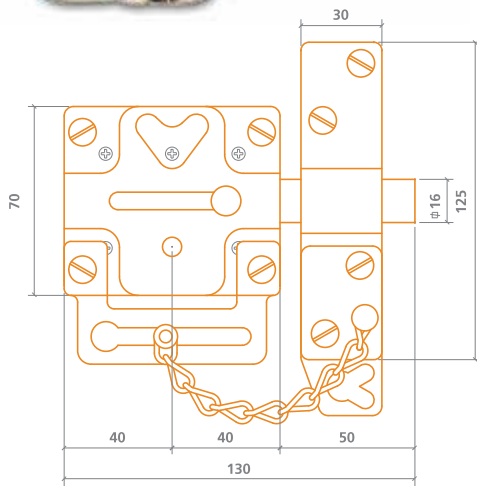

- Deadbolt with round cylinder outside and clutch
- Steel bolt
- 4 turns
- Inner clutch & blocking device
- Round cylinder + 3 keys
- Escutcheon
- *Finishes:*  
Brassed / Chrome / Embossed enamel
- Without Chain is available under Ref. 400

# 401

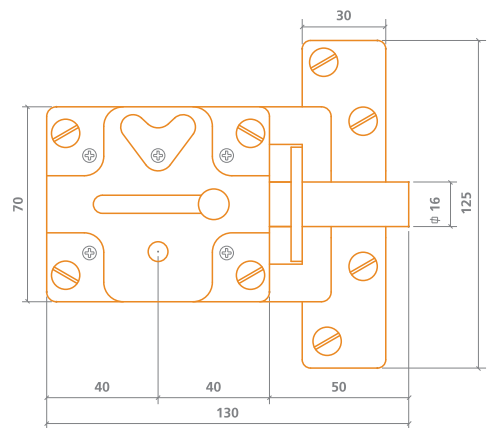
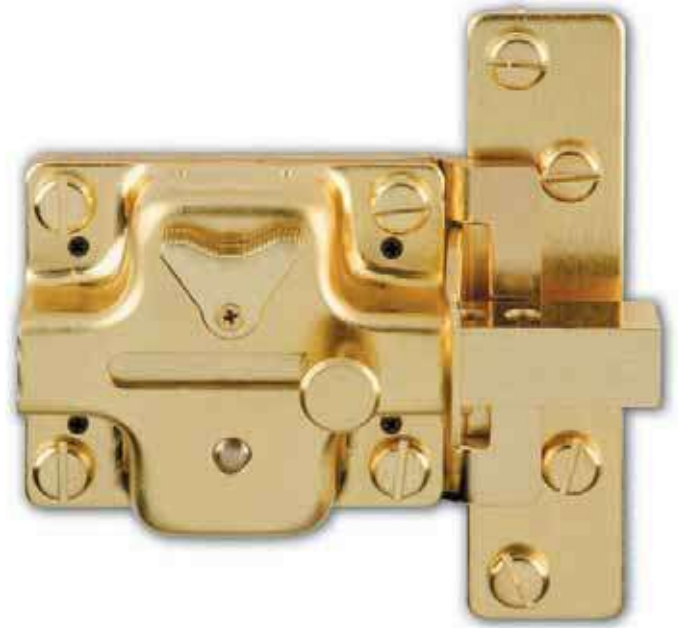

- Deadbolt with round cylinder outside and clutch
- Antibreakage System
- Steel bolt
- 4 turns
- Inner clutch & blocking device
- Round cylinder + 3 keys
- Escutcheon
- *Finishes:*  
Brassed / Chrome / Embossed enamel
- With Chain is available under Ref. 401R

## 450R

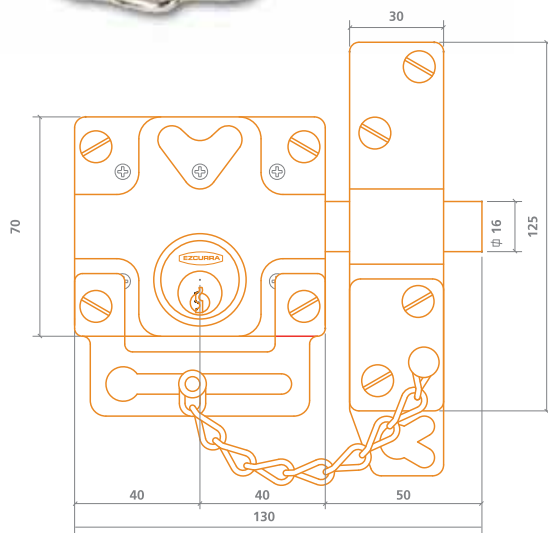

- Deadbolt with double round cylinder and clutch
- Steel bolt
- 4 turns
- Inner Clutch
- Round cylinder + 3 keys
- Escutcheon
- *Finishes:*  
Brassed / Chrome / Embossed enamel
- Without Chain is available under Ref.: 450

## 451

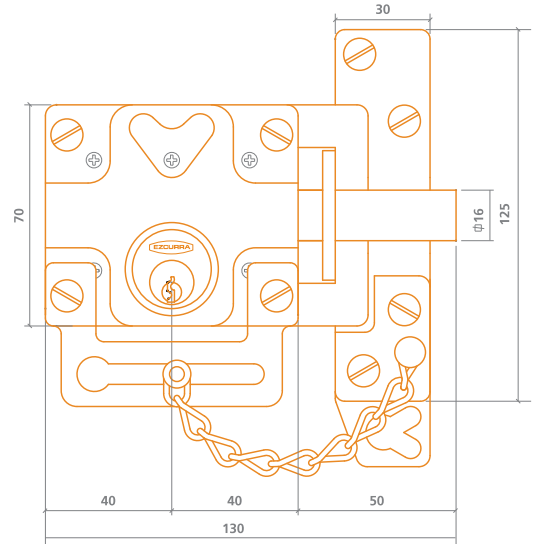

- Deadbolt with double round cylinder and clutch
- Antibreakage system
- Steel bolt
- 4 turns
- Inner clutch
- Round cylinder + 3 keys
- Escutcheon
- *Finishes:*  
Brassed / Chrome / Embossed enamel
- With Chain is available under Ref. 451R

# 500R-DS

# 501

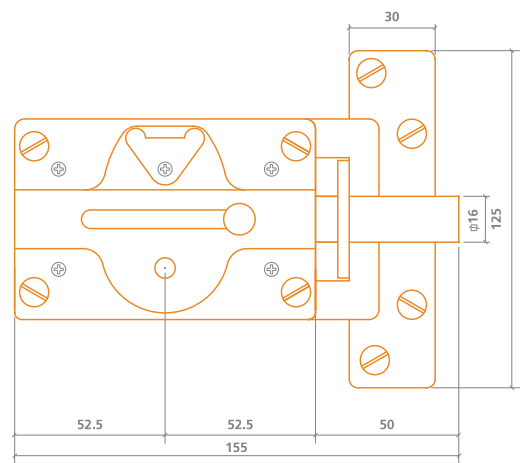
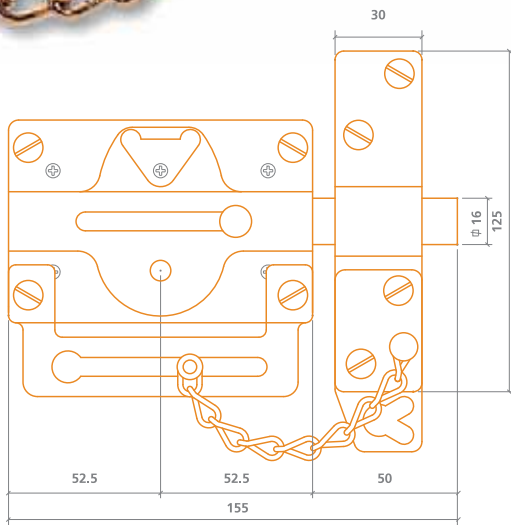
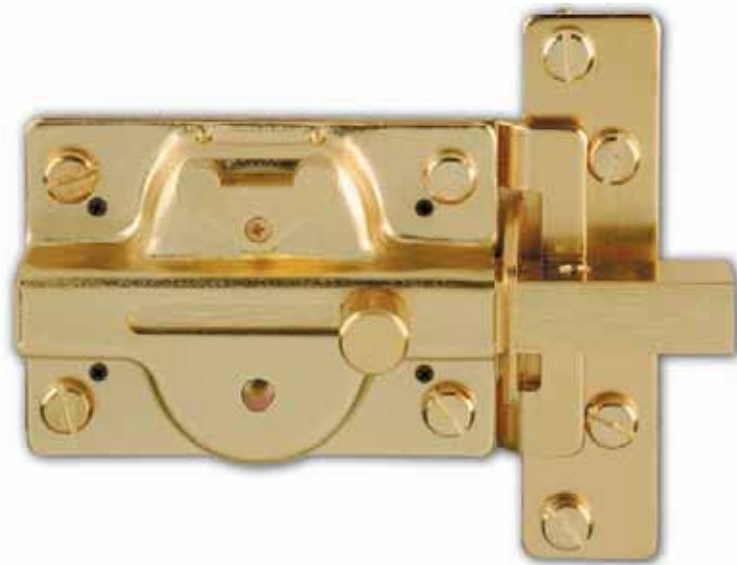

- Deadbolt with security cylinder DS outside and clutch
- Steel bolt
- 4 turns
- Inner clutch & blocking device
- Security Cylinder DS-15
- Escutcheon
- *Finishes:*  
Brassed / Chrome / Embossed enamel
- *Options:*  
Without Chain is available under Ref. 500-DS  
With Round cylinder & Chain is available under Ref. 500R  
With Round cylinder & Without Chain is available under Ref. 500

- Deadbolt with round cylinder outside and clutch
- Antibreakage system
- Steel bolt
- 4 turns
- Inner clutch & blocking device
- Round cylinder + 3 keys
- Escutcheon
- *Finishes:*  
Brassed / Chrome / Embossed enamel
- With Chain is available under Ref. 501R

# 550R

# 551

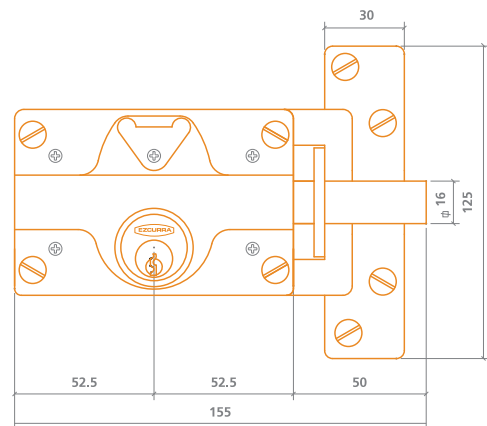
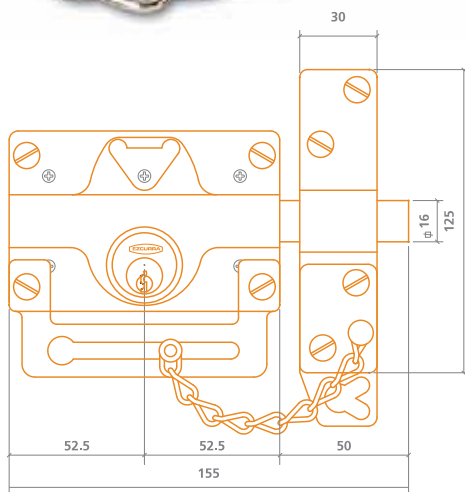
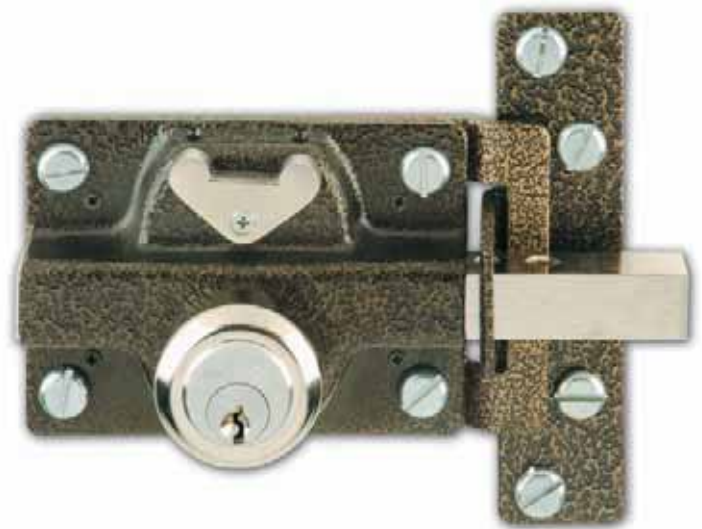

- Deadbolt with round double cylinder and clutch
- Steel bolt
- 4 turns
- Inner Clutch
- Round cylinder + 3 keys
- Escutcheon
- *Finishes:*  
Brassed / Chrome / Embossed enamel
- Without Chain is available under Ref. 550

- Deadbolt with round double cylinder and clutch
- Antibreakage system
- Steel bolt
- 4 turns
- Inner Clutch
- Round cylinder + 3 keys
- Escutcheon
- *Finishes:*  
Brassed / Chrome / Embossed enamel
- With Chain is available under Ref. 551R

# Monoblock Cylinder

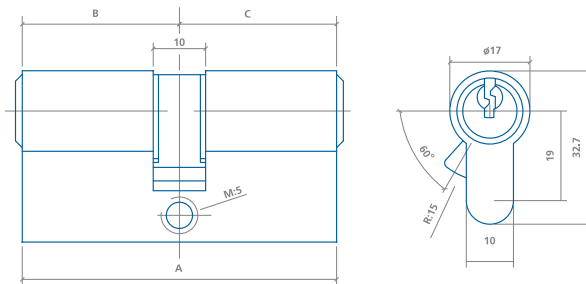

sizes

	A	B	C
C-60	60	30	30
C-70	70	35	35
D-70	70	30	40
C-80	80	40	40
D-80	80	30	50

Accessories



Striking plates



Escutcheons

## Finishes



## **Ezcurra-Esko, S.A.**

Apartado (P.O.Box) 5  
20540 Escoriaza. (Guipúzcoa) Spain



Tel.: +34 943 71 51 00  
Fax: +34 943 71 41 00

---

e-mail: [ezcurra@ezcurra.com](mailto:ezcurra@ezcurra.com) • [www.ezcurra.com](http://www.ezcurra.com)





**EZCURRA**

*S*ecurity

*I*nnovation

*Q*uality

**Special Security Locks for Armored Doors**

— with **Antibreakage System** —

# Index



<b>One Point Double Security Locks</b>	<b>70.B.00</b>	page 4
	<b>70.C.00</b>	page 4
	<b>70.D.00.F</b>	page 5
	<b>70.M.00.F</b>	page 5



<b>Multipoint Double Security Locks</b>	<b>70.B.00.FL</b>	page 6
	<b>70.C.00.FL</b>	page 6
	<b>70.D.00.FL</b>	page 7
	<b>70.M.00.FL</b>	page 7



<b>Cylinders</b>	<b>DS-15</b>	page 8
	<b>DS-10</b>	page 8
	<b>Borjas</b>	page 9



<b>Accessories</b>		page 10
--------------------	--	---------

## New

Every high security lock in this catalogue features an ANTIBREAKAGE SYSTEM, which effectively protects the central steel bolts from being forced backwards.

This system is PATENTED and CERTIFIED by an official approved centre.



## 70.B.00

## 70.C.00

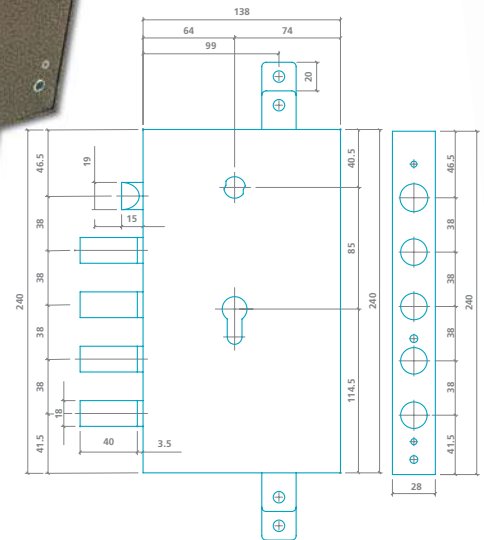
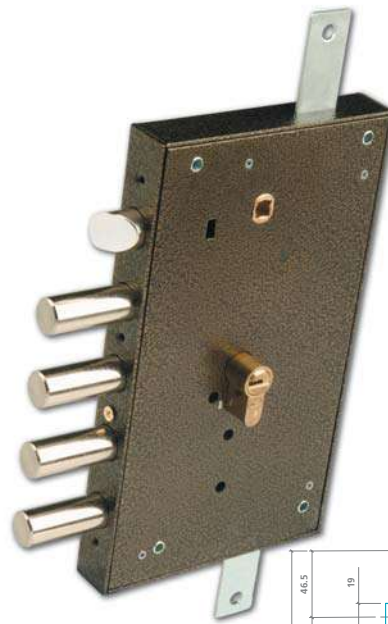
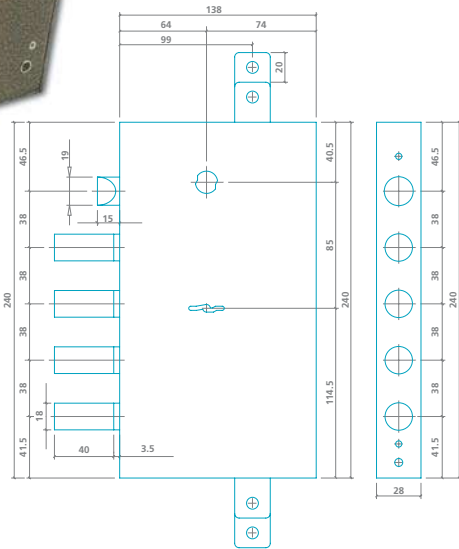
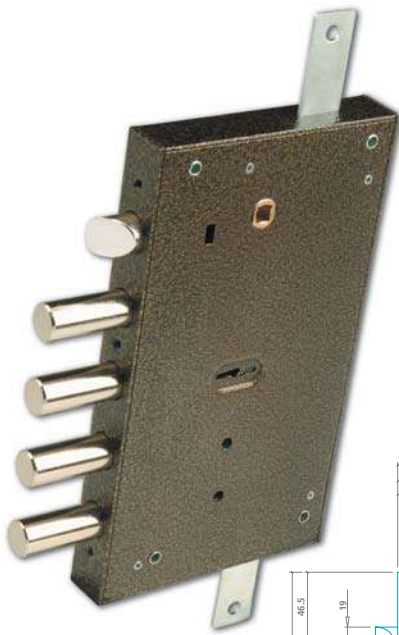

- ANTIBREAKAGE system
- Special Security Lever Lock by 6 independent lever tumblers
- Lever block protected by 3 mm. thick steel plate
- Round steel bolts Ø18 mm.
- 4 Turns
- Reversible Latch
- Backset 64 mm.
- Closed case
- Front & Striking plate 400 x 35 mm. available
- Fitting Up & down locking points
- Opposite side locking point available
- Available version with Service Key
- *Finishes:*
  - Brass
  - Chromed brass
- Security Escutcheon

- ANTIBREAKAGE system
- Special Security Cylinder Lock
- High Security Cylinder: DS-15, DS-10
- Round steel bolts Ø18 mm.
- 4 Turns
- Reversible Latch
- Backset 64 mm.
- Closed case
- Front & Striking plate 400 x 35 mm. available
- Fitting up & down locking points
- Opposite side locking point available
- *Finishes:*
  - Brass
  - Chromed brass
- Security Escutcheon

# 70.D.00.F 70.M.00.F

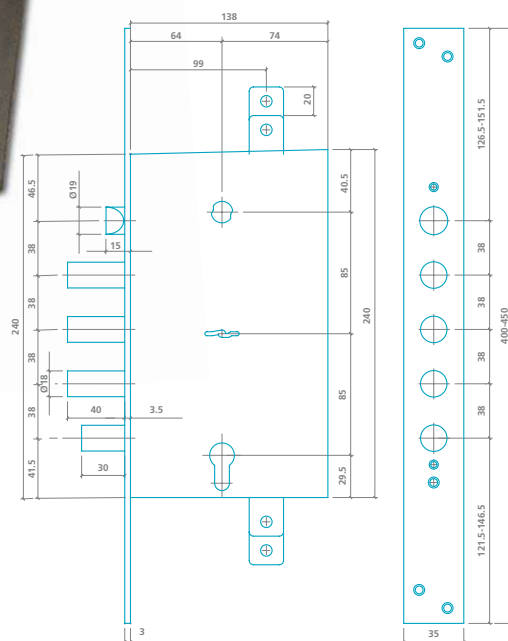
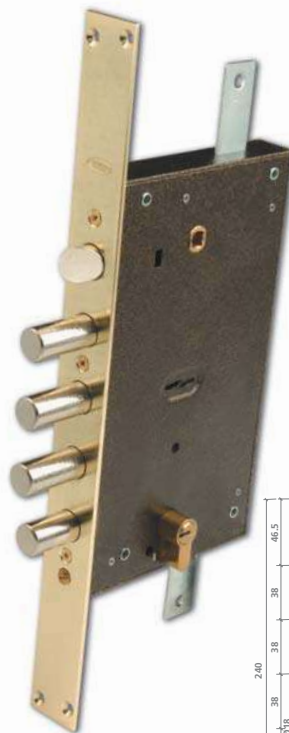
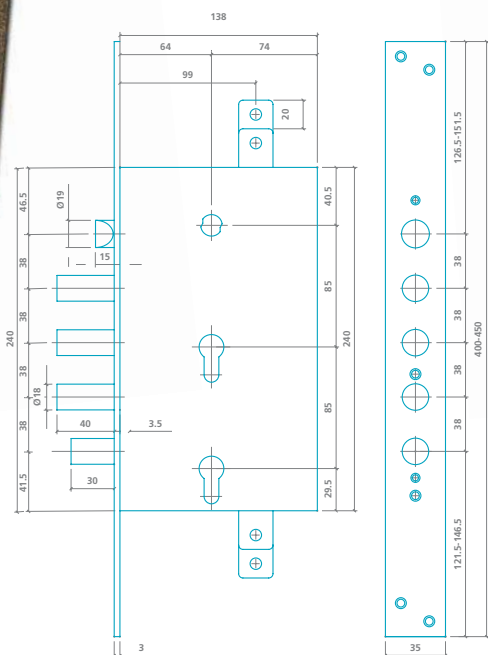

- ANTIBREAKAGE system
- Special Security Double Cylinder Lock; lower cylinder block the lock
- 2 x High Security Cylinder DS-15, DS-10
- Round steel bolts Ø18 mm.
- 4 Turns
- Reversible Latch
- Backset 64 mm.
- Closed case
- Front & Striking plate 400 x 35 mm. available
- Fitting up & down locking points
- Opposite side locking point available
- *Finishes:*
  - \_\_\_\_\_ Brass
  - \_\_\_\_\_ Chromed brass
- Security Escutcheon

- ANTIBREAKAGE system
- Special Security Lever & Cylinder Lock
- Multifunction Locking system:
  - Main system by 6 independent lever tumblers
  - Secondary system by High Security Cylinder DS-15 / DS-10 with blocking function
- Lever block protected by 3 mm. thick steel plate
- Round steel bolts Ø18 mm.
- 4 Turns
- Reversible Latch
- Backset 64 mm.
- Closed case
- Front & Striking plate 400 x 35 mm. available
- Fitting up & down locking points
- Opposite side locking point available
- *Finishes:*
  - \_\_\_\_\_ Brass
  - \_\_\_\_\_ Chromed brass.
- Security Escutcheon

## 70.B.00.FL

## 70.C.00.FL

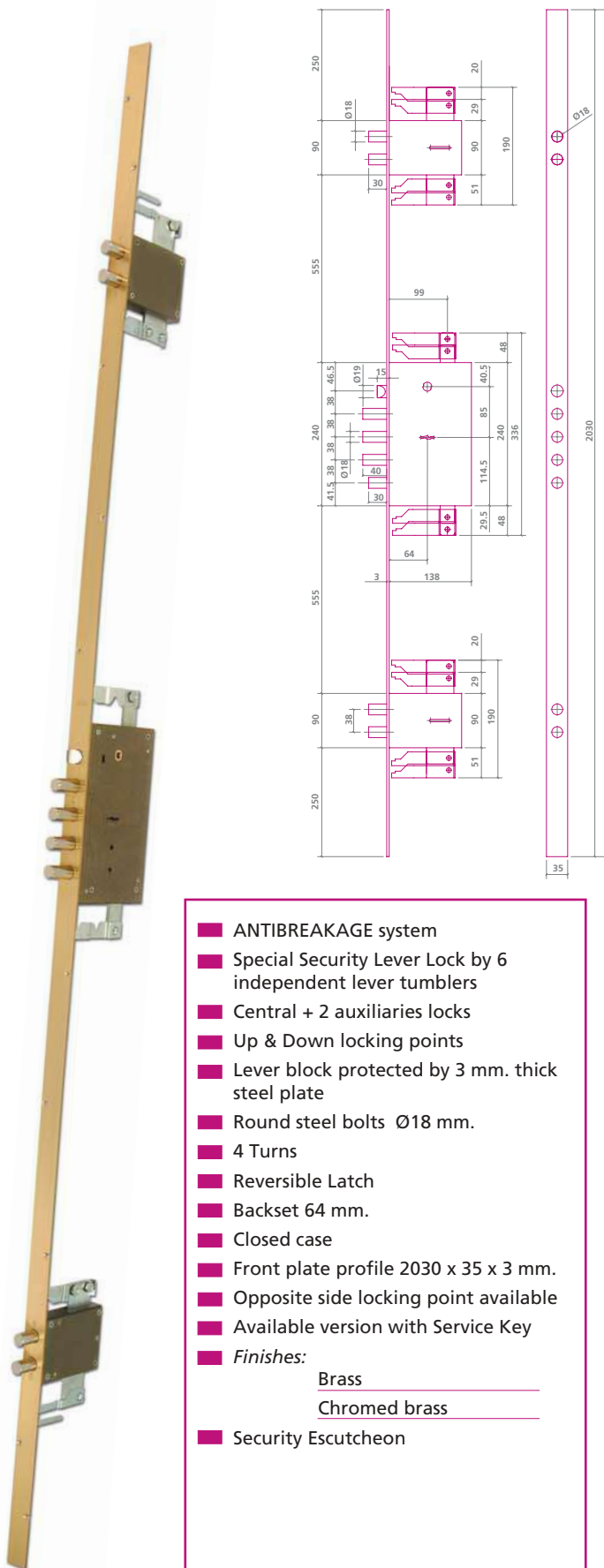

- ANTIBREAKAGE system
- Special Security Lever Lock by 6 independent lever tumblers
- Central + 2 auxiliaries locks
- Up & Down locking points
- Lever block protected by 3 mm. thick steel plate
- Round steel bolts Ø18 mm.
- 4 Turns
- Reversible Latch
- Backset 64 mm.
- Closed case
- Front plate profile 2030 x 35 x 3 mm.
- Opposite side locking point available
- Available version with Service Key
- *Finishes:*
  - Brass
  - Chromed brass
- Security Escutcheon

Ref.: 70.B.00.FL/3 without up & down locking points.

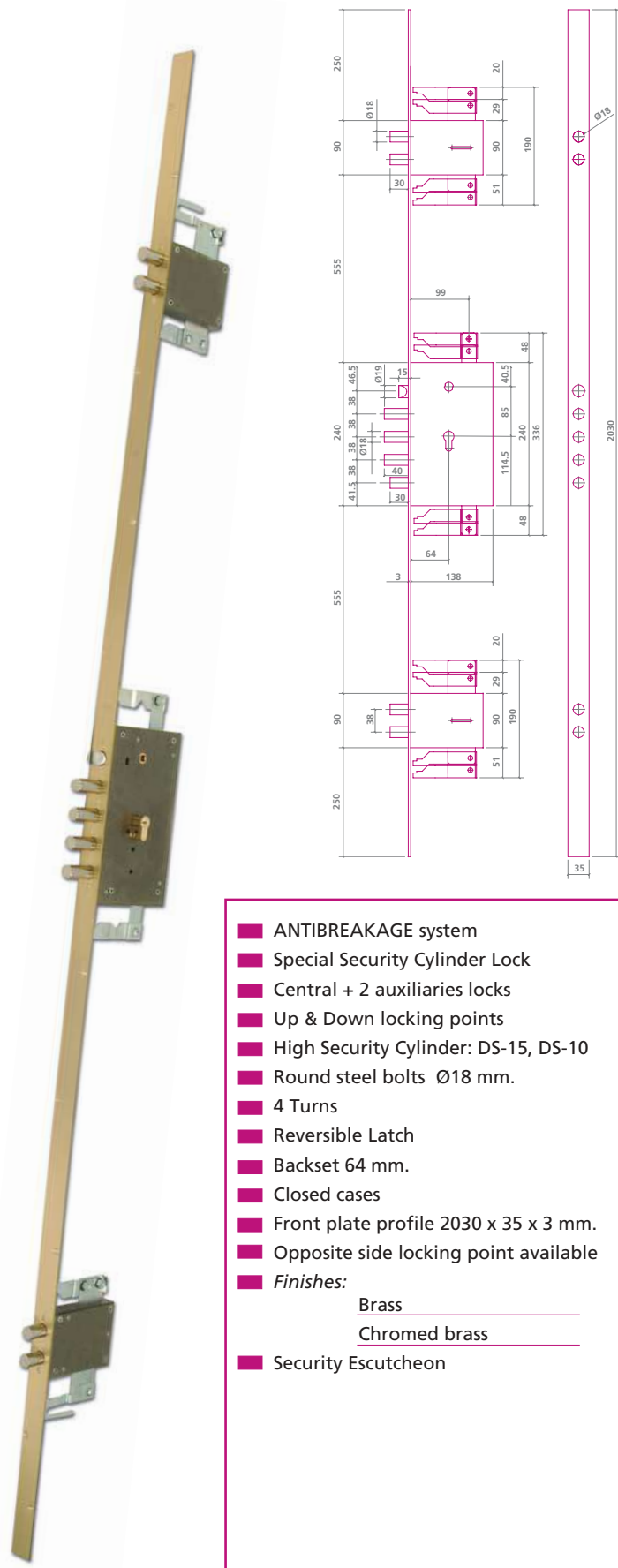

- ANTIBREAKAGE system
- Special Security Cylinder Lock
- Central + 2 auxiliaries locks
- Up & Down locking points
- High Security Cylinder: DS-15, DS-10
- Round steel bolts Ø18 mm.
- 4 Turns
- Reversible Latch
- Backset 64 mm.
- Closed cases
- Front plate profile 2030 x 35 x 3 mm.
- Opposite side locking point available
- *Finishes:*
  - Brass
  - Chromed brass
- Security Escutcheon

Ref.: 70.C.00.FL/3 without up & down locking points.

## 70.D.00.FL

## 70.M.00.FL

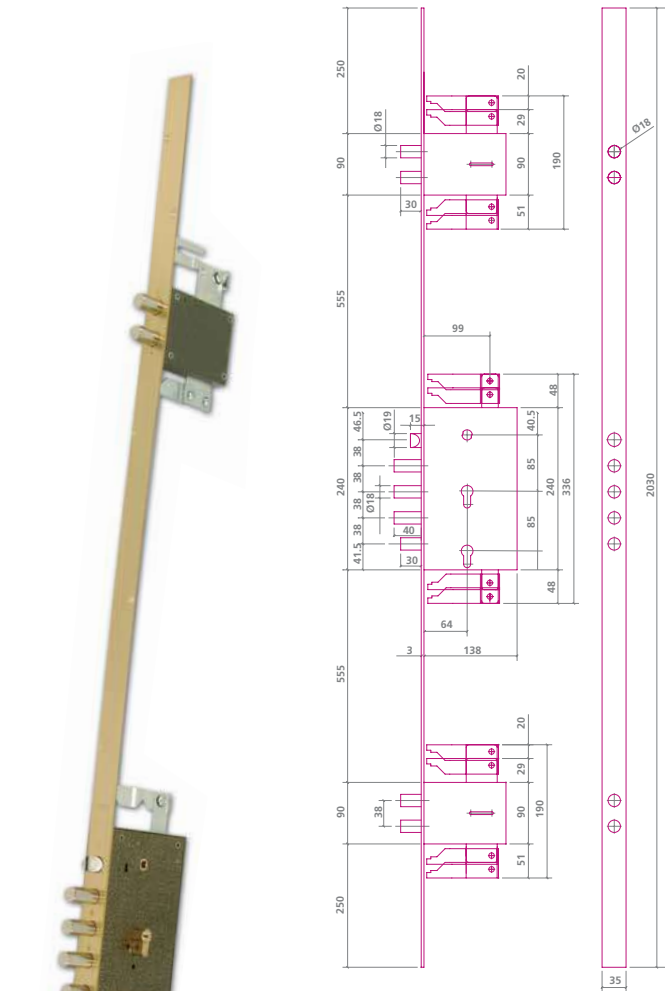

- ANTIBREAKAGE system
- Special Security Double Cylinder Lock; lower cylinder block the lock
- Central + 2 auxiliaries locks
- Up & Down locking points
- 2 High Security Cylinder DS-15, DS-10.
- Round steel bolts Ø18 mm.
- 4 Turns
- Reversible Latch
- Backset 64 mm.
- Closed cases
- Front plate profile 2030 x 35 x 3 mm.
- Opposite side locking point available
- *Finishes:*
  - Brass
  - Chromed brass
- Security Escutcheon

Ref.: 70.D.00.FL/3 without up & down locking points.

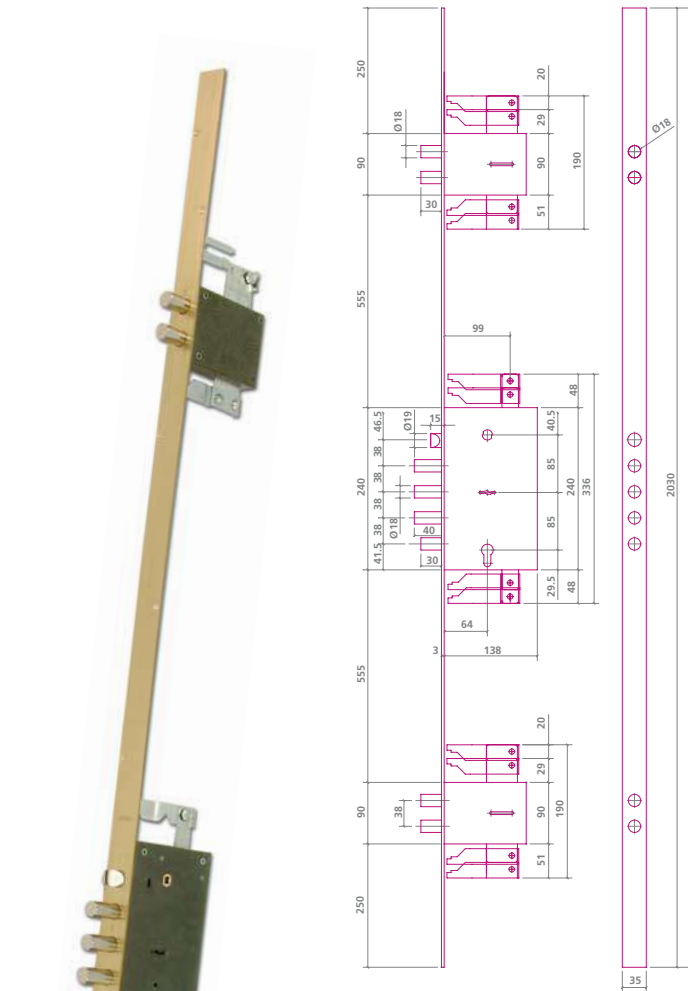

- ANTIBREAKAGE system
- Special Security Lever & Cylinder Lock
- Central + 2 auxiliaries locks
- Up & Down locking points
- Multifunction Locking system:
  - Secondary system by High Security Cylinder DS-15 / DS-10 with blocking function.
  - Lever block protected by 3 mm. thick steel plate.
- Round steel bolts Ø18 mm.
- 4 Turns
- Reversible Latch
- Backset 64 mm.
- Closed cases
- Front plate profile 2030 x 35 x 3 mm.
- Opposite side locking point available
- *Finishes:*
  - Brass
  - Chromed brass
- Security Escutcheon

Ref.: 70.M.00.FL/3 without up & down locking points.

**EZCURRA**

# DS-15

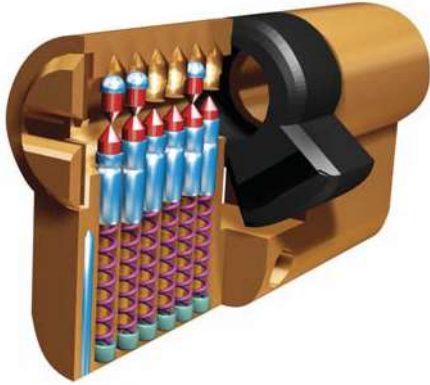

**DS-15 Cylinder**

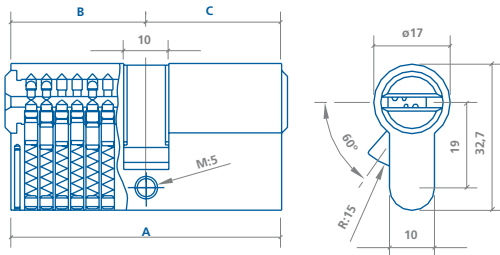

**DS-15 Switch cylinder**

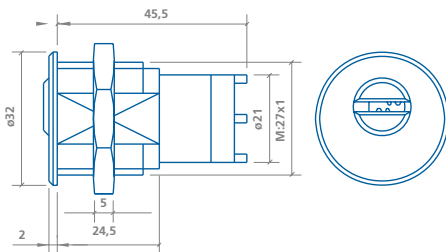

- High security double cylinder with european profile.
- Front drilling resistant by tempered steel bars.
- Anti - picklock profile.
- Five reversible chromed brass keys.
- Double fitting 6 pin cylinder offering excellent technical features.
- High keying possibilities.
- Wide range of sizes, finishes and models : knob cylinders, half-cylinders, switch cylinders, double clutch cylinders, etc.
- Computerized manufacturing process in highly technological machines.
- *Finishes:*    Brass/Chrome  
                     Matt chrome

## Security cards



## sizes

A	B	C	A	B	C	A	B	C
60 mm. (30-30)			65 mm. (30-35)			● 70 mm. (35-35)		
70 mm. (30-40)			● 75 mm. (35-40)			● 80 mm. (40-40)		
80 mm. (30-50)			● 90 mm. (40-50)			90 mm. (30-60)		
● 100 mm. (50-50)			● 110 mm. (55-55)			● 110 mm. (50-60)		
● 120 mm. (60-60)								

● Available in double clutch version.

**EZCURRA**

# DS-10

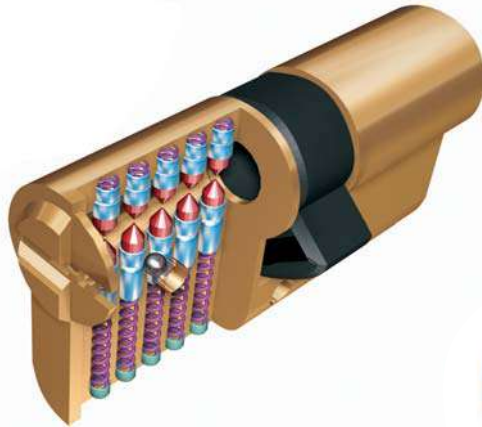

**DS-10 Cylinder**

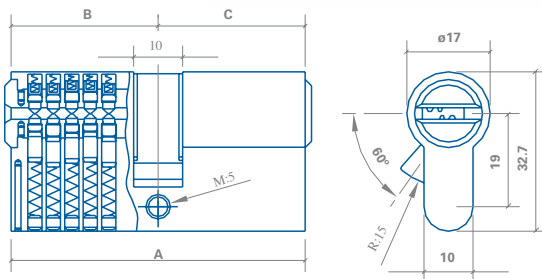

**DS-10 Switch cylinder**

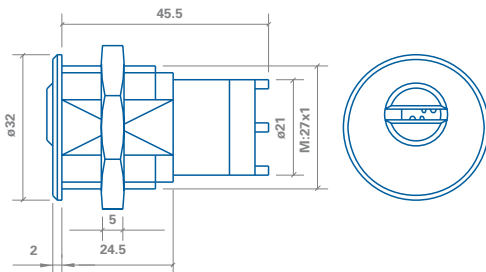

**Security cards**



- High security double cylinder with european profile.
- Front drilling resistant by tempered steel bars.
- Anti - picklock profile.
- Five reversible nickelsilver keys.
- Double pin row featuring on both sides, plus an extra locking device placed at the side, achieving a sophisticated security system.
- High keying possibilities.
- Wide range of sizes, finishes and models: knob cylinders, half-cylinders, switch cylinders, double clutch cylinders, etc.
- **Finishes:** Brass/Chrome  
Matt chrome

**sizes**

A	B	C	A	B	C	A	B	C
60 mm. (30-30)			65 mm. (30-35)			● 70 mm. (35-35)		
70 mm. (30-40)			● 75 mm. (35-40)			● 80 mm. (40-40)		
80 mm. (30-50)			● 90 mm. (40-50)			90 mm. (30-60)		
● 100 mm. (50-50)			● 110 mm. (55-55)			● 110 mm. (50-60)		
● 120 mm. (60-60)								

● Available in double clutch version.





**S 70  
Lever set**



**S 70 key  
short and long**



**Borja**



**Cylinder**



**Borja + cylinder**



**double cylinder**

## S 70 Escutcheons

## Key Guide plate set

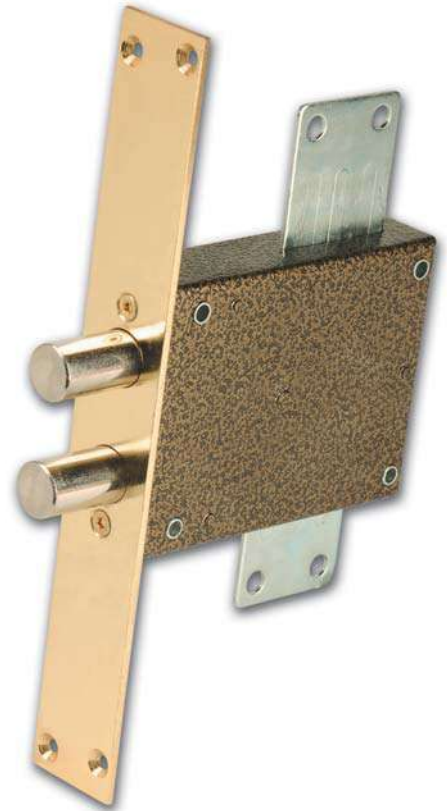

## Hooks



## Auxiliary locks

■ Front and Striking Plate available.

## Guides and Anti-dust protectors

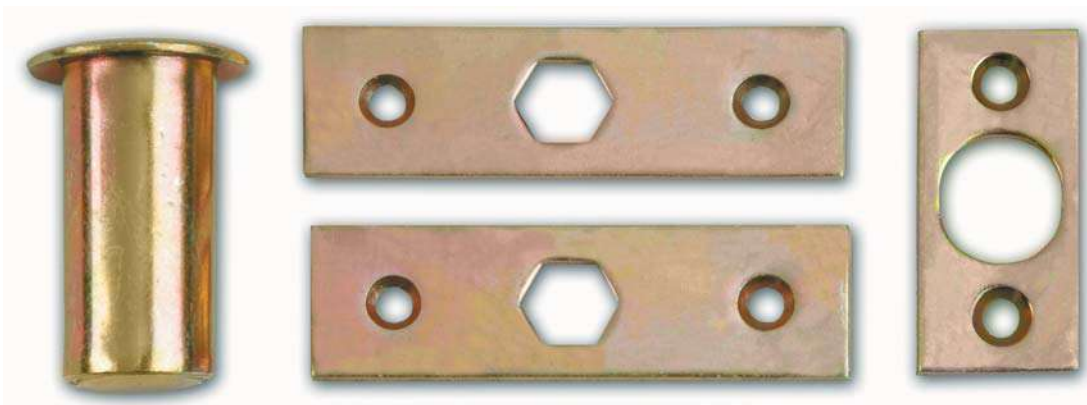

**Ezcurra-Esko, S.A.**

P.O.Box 5  
20540 Escoriaza. (Guipúzcoa) Spain



Tel.: +34 943 71 51 00  
Fax: +34 943 71 41 00

---

e-mail: [ezcurra@ezcurra.com](mailto:ezcurra@ezcurra.com) • [www.ezcurra.com](http://www.ezcurra.com)



**EZCURRA**



*Security*

*Innovation*

*Quality*

**High Security Locks,  
Antibreakage System**



# Index



<b>Multipoint security locks</b>	<b>2000B</b>	page 3
	<b>2000</b>	page 3
	<b>2010</b>	page 4
	<b>2075</b>	page 4
	<b>2000B-Z</b>	page 5
	<b>2004B-Z</b>	page 5
	<b>2004B</b>	page 6
	<b>2014</b>	page 6



<b>One-point security locks</b>	<b>700B</b>	page 7
	<b>701B</b>	page 7
	<b>703B</b>	page 7
	<b>700A</b>	page 8
	<b>720</b>	page 8



<b>Fire resistant multipoint security locks</b>	<b>RF-2000B</b>	page 9
	<b>RF-2010</b>	page 9
	<b>RF-2075</b>	page 9



<b>Fire resistant one-point security locks</b>	<b>RF-700B</b>	page 10
	<b>RF-700A</b>	page 10



<b>Cylinders</b>	<b>DS-15</b>	page 11
	<b>DS-10</b>	page 12
	<b>SEB-3</b>	page 13
	<b>SEB-23</b>	page 13



<b>Escutcheons</b>	<b>410-P</b>	page 14
	<b>420-P</b>	page 14
	<b>424-P</b>	page 14
	<b>425-P</b>	page 14
	<b>430-P</b>	page 14



<b>Accessories</b>		page 15
--------------------	--	---------

## New

Every high security lock in this catalogue features an ANTIBREAKAGE SYSTEM, which effectively protects the central steel bolts from being forced backwards.

This system is PATENTED and CERTIFIED by an official approved centre.



# 2000B

# 2000

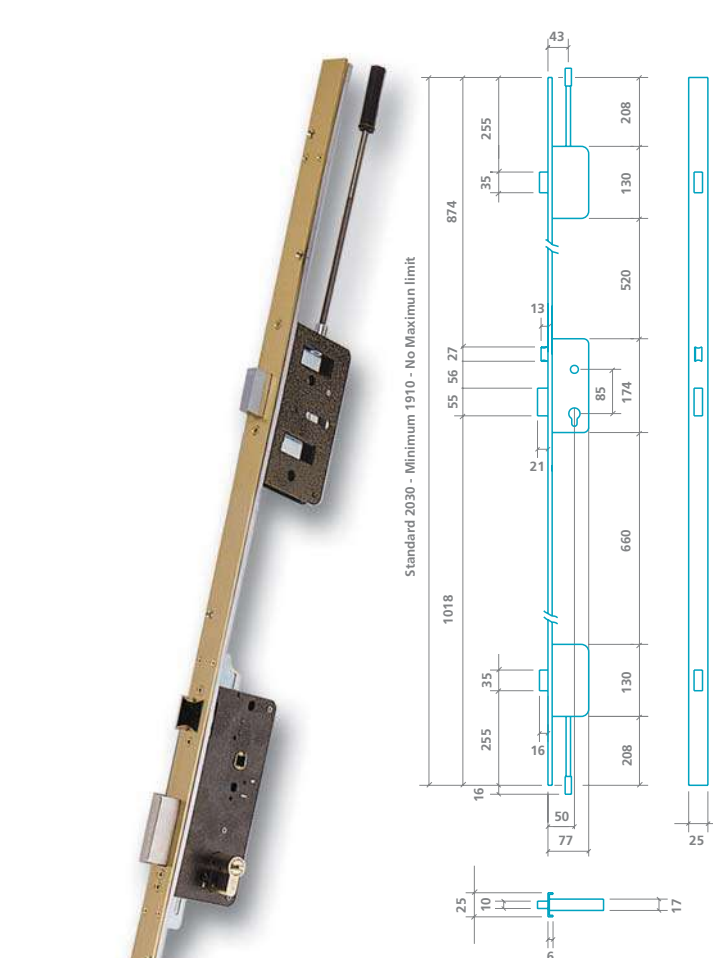
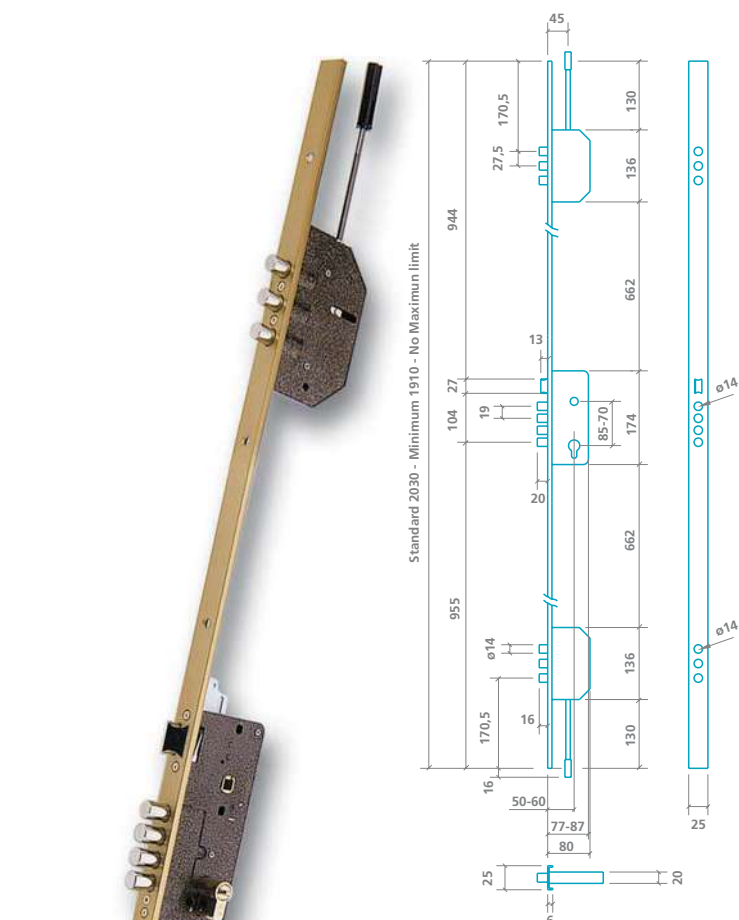

- ANTIBREAKAGE system
- Round steel bolts
- Reversible latch
- 2 turns
- Front plate profile: 25 x 6 mm.
- Cylinders: DS-15 DS-10 SEA
- Backsets: 50 / 60 mm.
- Distances: 85 / 70 mm.
- Front plate finishes:

	Height: (m.)
Brass / Chromed brass	2.03
«U» Brass / «U» Chromed brass	2.03
Gold finish Alum. / Silver finish Alum.	2.03 2.11
Golden Enamel / Black	2.03 2.11
Chrome / Matt chrome	2.03 2.11
Stainless steel / Bronze	2.03 2.11

- Escutcheons: 410-P 420-P  
424-P 425-P  
430-P
- Striking plates: Short pieces  
Long pieces: 30 / 40 / 45 mm
- ANTIPANIC version available

Note: 2000B/3 lock has no upwards / downwards locking points.

- ANTIBREAKAGE system
- Rectangular steel bolts
- Reversible latch
- 2 turns
- Front plate profile: 25 x 6 mm.
- Cylinders: DS-15 DS-10 SEA
- Backset: 50 mm.
- Front plate finishes:

	Height: (m.)
Brass / Chromed brass	2.03
«U» Brass / «U» Chromed brass	2.03
Gold finish Alum. / Silver finish Alum.	2.03

- Escutcheons: 410-P 420-P  
424-P 425-P  
430-P
- Striking plates: Short pieces  
Long pieces: 40 / 45 mm.

Note: 2000/3 lock has no upwards / downwards locking points.

## 2010

## 2075

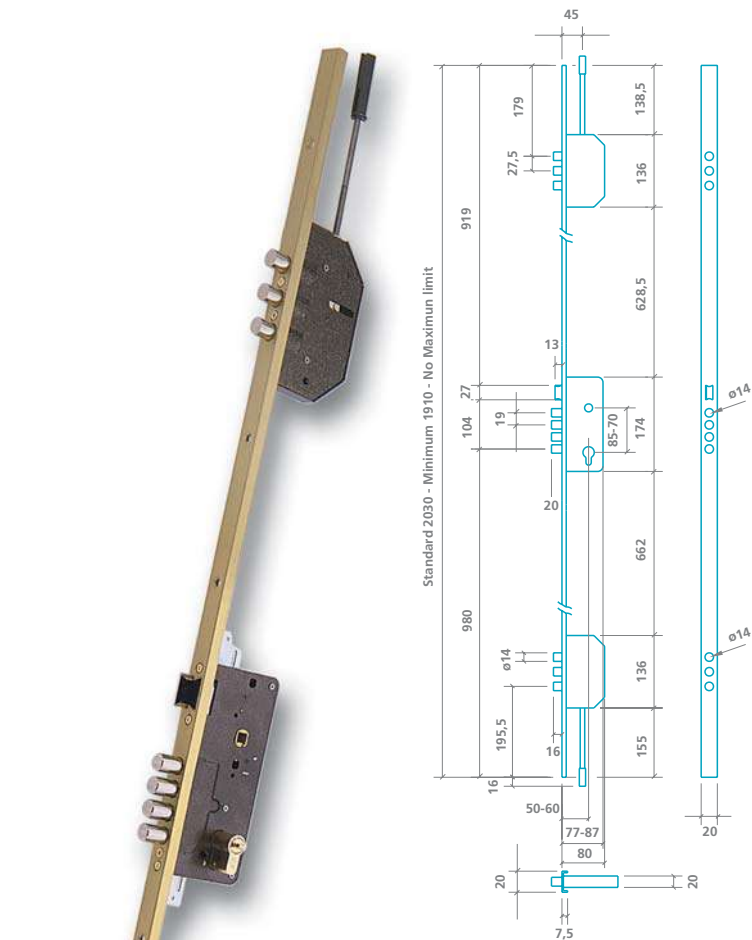
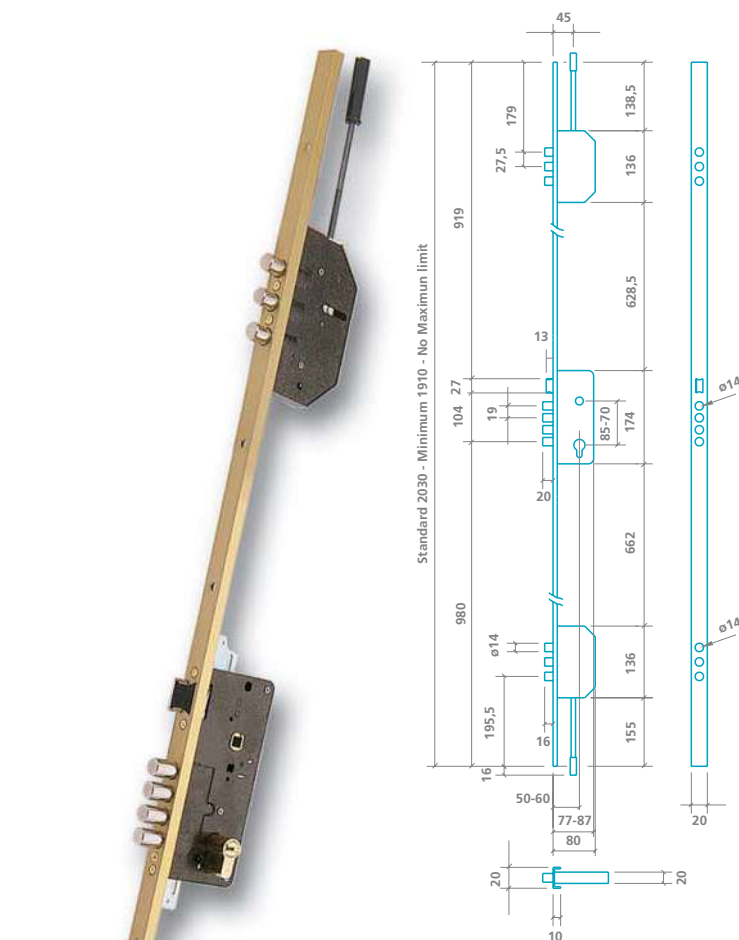

- ANTIBREAKAGE system
- Round steel bolts
- Reversible latch
- 2 turns
- *Front plate profile:* 20 x 10 mm.
- *Cylinders:* DS-15 DS-10
- *Backsets:* 50 / 60 mm.
- *Distances:* 85 / 70 mm.
- *Front plate finishes:*

	Height: (m.)
Golden Enamel / Black	2.03 2.11
Chrome / Matt chrome	2.03 2.11
Stainless Steel / Bronze	2.03 2.11

- *Escutcheons:* 410-P 420-P  
424-P 425-P  
430-P
- *Striking plates:* Short pieces  
Long pieces: 40 / 45 mm.
- ANTIPANIC version available

Note: 2010/3 lock has no upwards / downwards locking points.

- ANTIBREAKAGE system
- Round steel bolts
- Reversible latch
- 2 turns
- *Front plate profile:* 20 x 7.5 mm.
- *Cylinders:* DS-15 DS-10
- *Backsets:* 50 / 60 mm.
- *Distances:* 85 / 70 mm.
- *Front plate finishes:*

	Height: (m.)
Golden Enamel / Black	2.03 2.11
Chrome / Matt chrome	2.03 2.11
Stainless Steel / Bronze	2.03 2.11

- *Escutcheons:* 410-P 420-P  
424-P 425-P  
430-P
- *Striking plates:* Short pieces  
Long pieces: 40 / 45 mm.
- ANTIPANIC version available.

Note: 2075/3 lock has no upwards / downwards locking points.

# 2000B-Z

# 2004B-Z

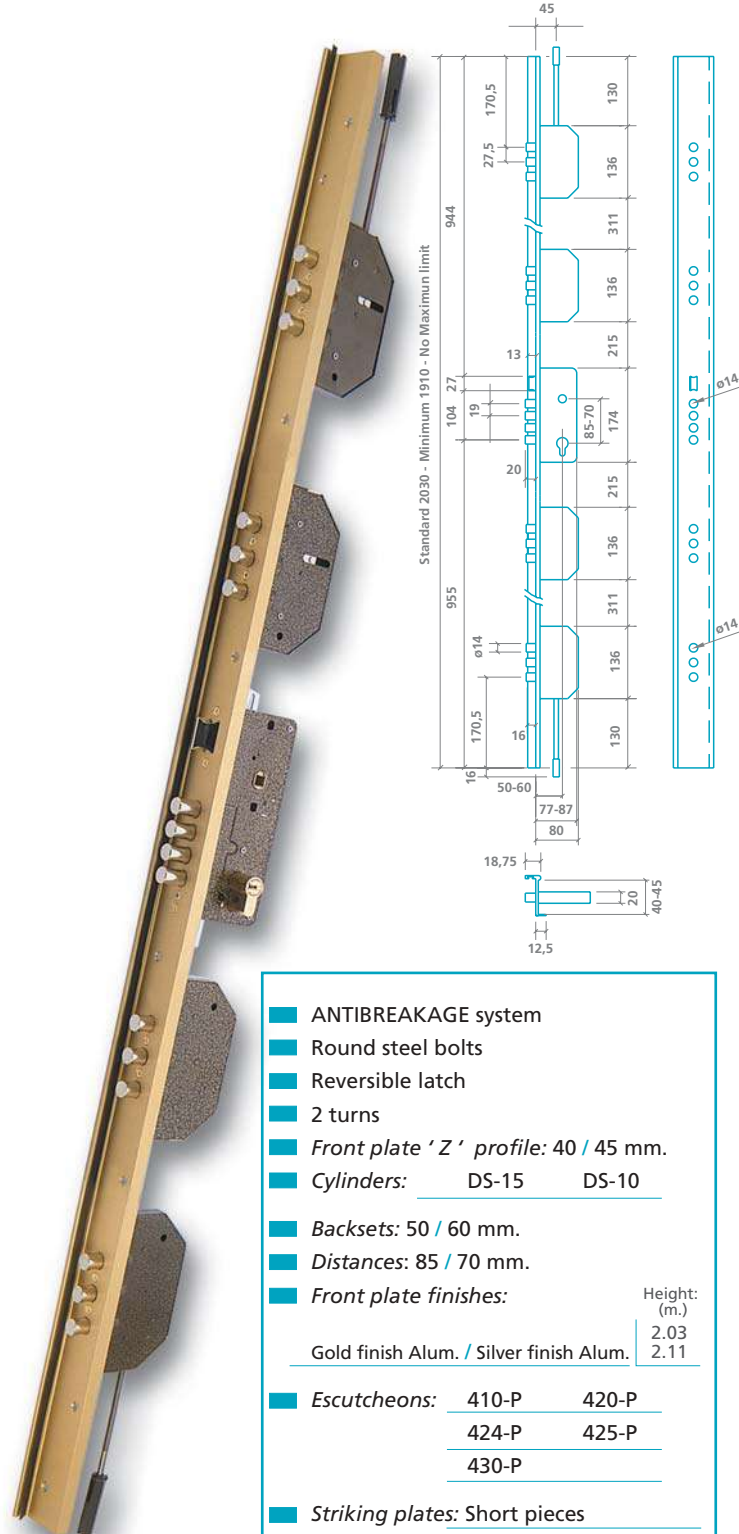
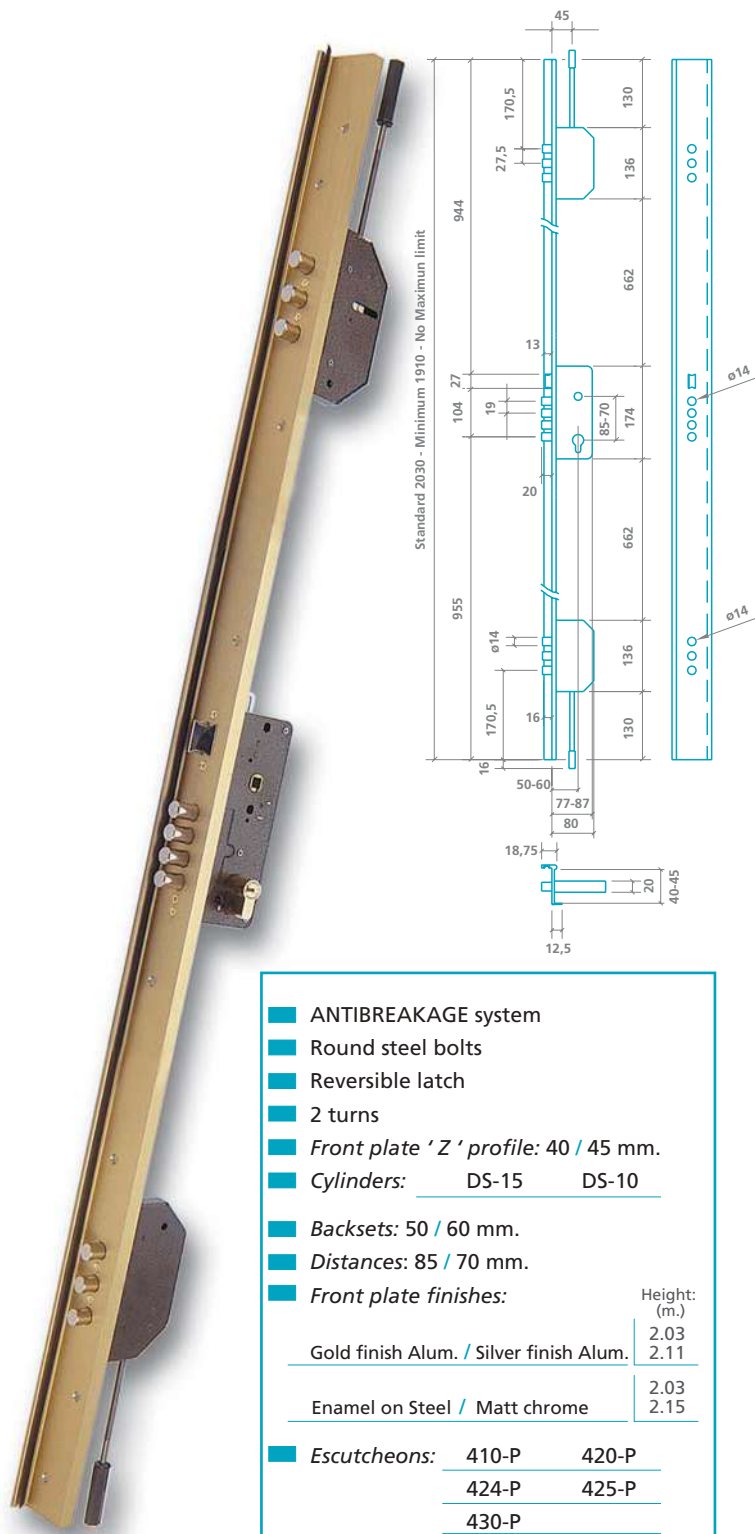

- ANTIBREAKAGE system
- Round steel bolts
- Reversible latch
- 2 turns
- Front plate 'Z' profile: 40 / 45 mm.
- Cylinders: DS-15    DS-10
- Backsets: 50 / 60 mm.
- Distances: 85 / 70 mm.
- Front plate finishes:
 

Gold finish Alum. / Silver finish Alum.	Height: (m.)
	2.03
	2.11
Enamel on Steel / Matt chrome	2.03
	2.15
- Escutcheons: 410-P    420-P  
424-P    425-P  
430-P
- Striking plates: Short pieces  
Long pieces: 40 / 45 mm.
- ANTIPANIC version available

Notes: **2000B-Z/3** lock has no upwards / downwards locking points.  
Enamel on steel and matt chrome do not include isolating rubber profile.

- ANTIBREAKAGE system
- Round steel bolts
- Reversible latch
- 2 turns
- Front plate 'Z' profile: 40 / 45 mm.
- Cylinders: DS-15    DS-10
- Backsets: 50 / 60 mm.
- Distances: 85 / 70 mm.
- Front plate finishes:
 

Gold finish Alum. / Silver finish Alum.	Height: (m.)
	2.03
	2.11
- Escutcheons: 410-P    420-P  
424-P    425-P  
430-P
- Striking plates: Short pieces  
Long pieces: 40 / 45 mm.
- ANTIPANIC version available

Note: **2004B-Z/3** lock has no upwards / downwards locking points



## 2004B

## 2014

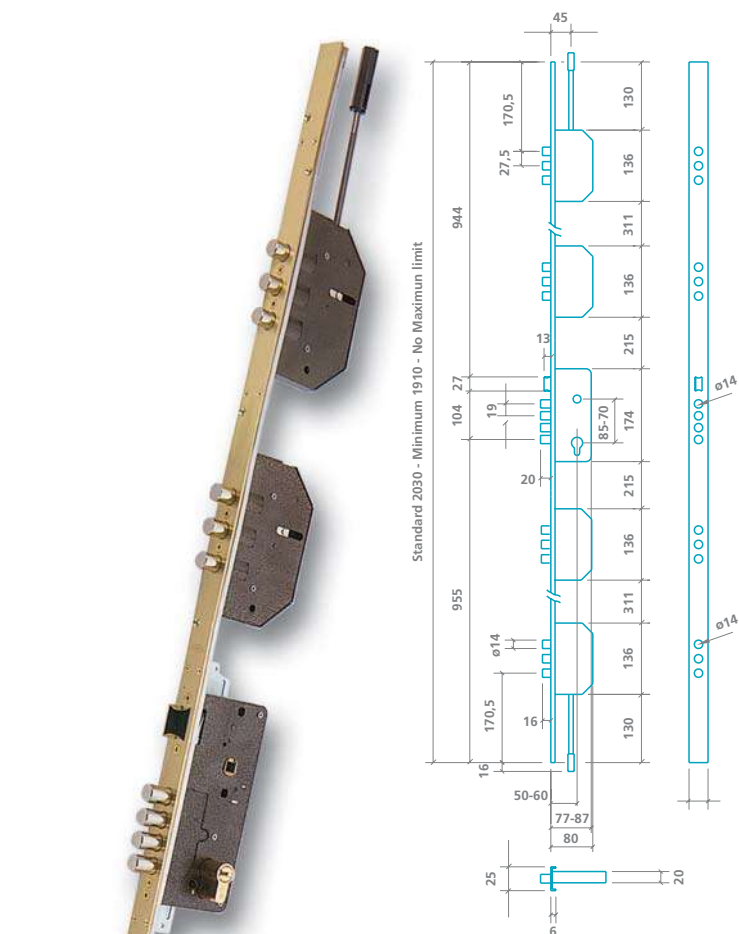

- ANTIBREAKAGE system
- Round steel bolts
- Reversible latch
- 2 turns
- *Front plate profile:* 25 x 6 mm.
- *Cylinders:* DS-15 DS-10
- *Backsets:* 50 / 60 mm.
- *Distances:* 85 / 70 mm.
- *Front plate finishes:*

	Height: (m.)
Brass / Chromed brass	2.03
Gold finish Alum. / Silver finish Alum.	2.03
- *Escutcheons:*

410-P	420-P
424-P	425-P
430-P	
- *Striking plates:* Short pieces  
Long pieces: 40 / 45 mm.
- ANTIPANIC version available

Note: 2004B/3 lock has no upwards / downwards locking points

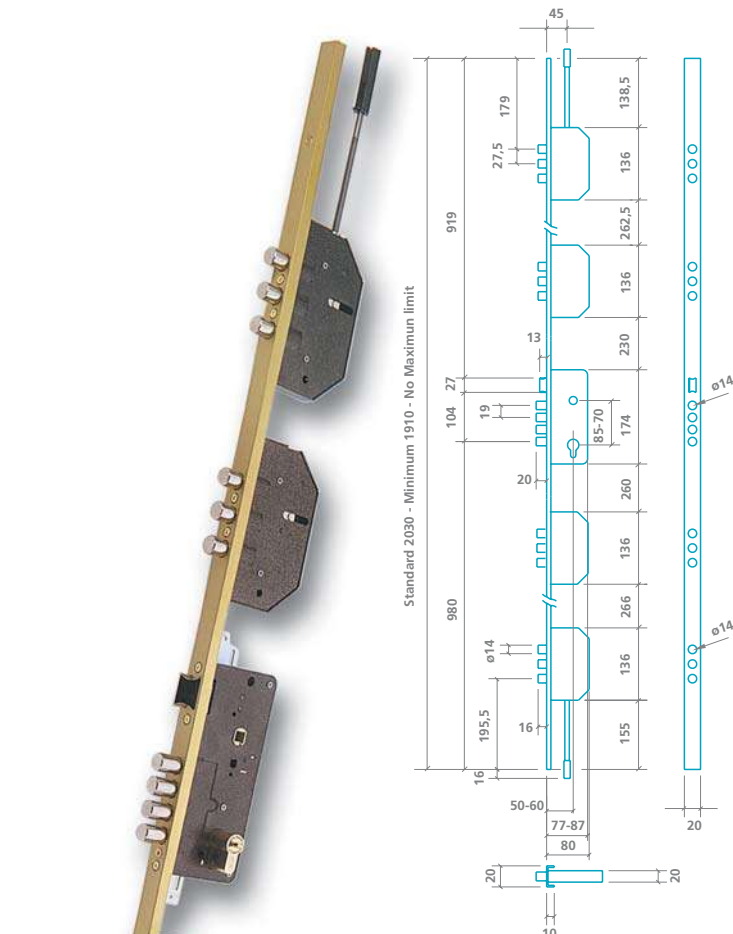

- ANTIBREAKAGE system
- Round steel bolts
- Reversible latch
- 2 turns
- *Front plate profile:* 20 x 10 mm.
- *Cylinders:* DS-15 DS-10
- *Backsets:* 50 / 60 mm.
- *Distances:* 85 / 70 mm.
- *Front plate finishes:*

	Height: (m.)
Golden enamel / Black	2.03
Chrome / Matt chrome	2.03
Bronze	2.03
- *Escutcheons:*

410-P	420-P
424-P	425-P
430-P	
- *Striking plates:* Short pieces  
Long pieces: 40 / 45 mm.
- ANTIPANIC version available

Note: 2014/3 lock has no upwards / downwards locking points

# 700B

# 701B

# 703B

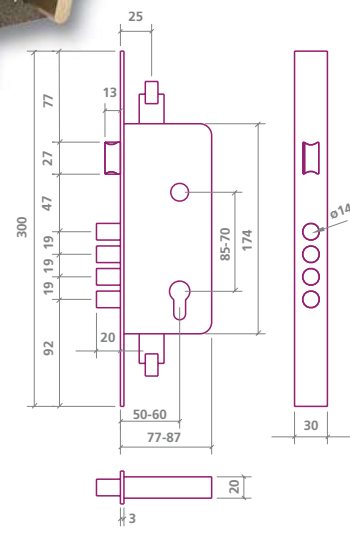
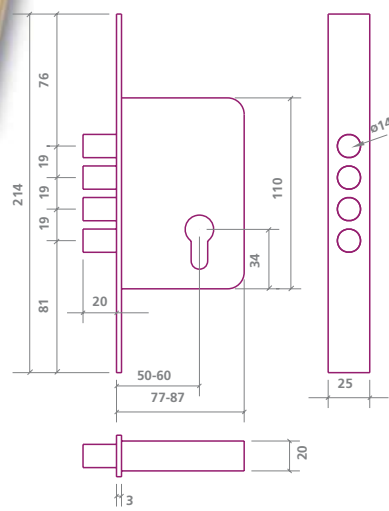
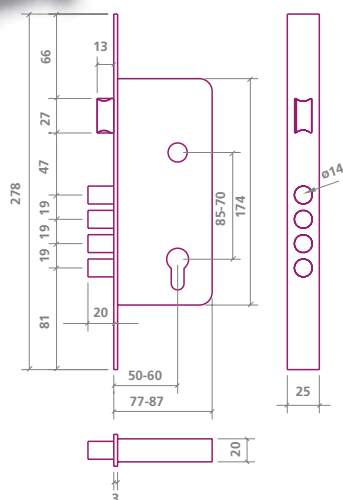

- ANTIBREAKAGE system
- Round steel bolt
- Reversible latch
- 2 turns
- *Front plate:* 25 x 3 mm.
- *Cylinders:* DS-15 DS-10
- *Backsets:* 50 / 60 mm.
- *Distances:* 85 / 70 mm.
- *Front plate finishes:*
- Brass / Chromed brass
- Gold finish Alum / Silver finish Alum.
- Golden enamel / Black
- Chrome / Matt chrome
- Stainless Steel / Bronze
- *Escutcheons:* 410-P 420-P
- 424-P 425-P
- 430-P
- Short striking plate
- Round edged plates available

- ANTIBREAKAGE system
- Round steel bolt
- 2 turns
- *Front plate:* 25 x 3 mm.
- *Cylinders:* DS-15 DS-10
- *Backsets:* 50 / 60 mm.
- *Front plate finishes:*
- Brass / Chromed brass
- Gold finish Alum / Silver finish Alum.
- Golden enamel / Black
- Chrome / Matt chrome
- Bronze
- *Escutcheons:* 410-P 420-P
- 424-P 425-P
- 430-P
- Short striking plate
- Round edged plates available

- ANTIBREAKAGE system
- 3 locking points through up and downwards threaded bars
- Round steel bolt
- Reversible latch
- 2 turns
- *Front plate:* 30 x 3 mm.
- *Cylinders:* DS-15 DS-10
- *Backsets:* 50 / 60 mm.
- *Distances:* 85 / 70 mm.
- *Front plate finishes:*
- Brass / Chromed brass
- *Escutcheons:* 410-P 420-P
- 424-P 425-P
- 430-P
- Short striking plate

## 700A

## 720

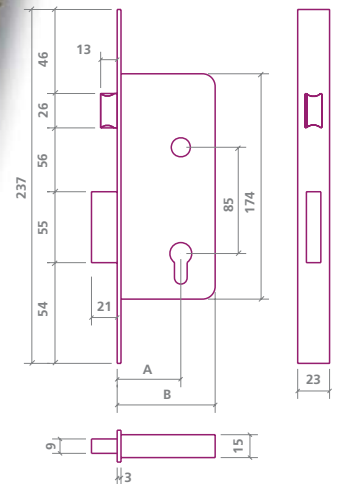
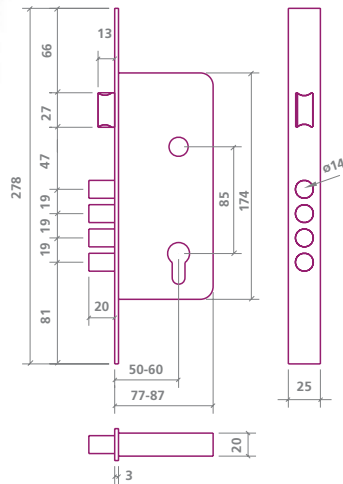

- ANTIPANIC lock
- Round steel bolt
- Reversible latch
- 2 turns
- Front plate: 25 x 3 mm.
- Cylinders: DS-15      DS-10
- Backsets: 50 / 60 mm.
- Front plate finishes:
 

Brass / Chromed brass
Gold finish Alum / Silver finish Alum.
Golden enamel / black
Chrome / Matt chrome
Stainless Steel / Bronze
- Escutcheons: 

410-P	420-P
424-P	425-P
430-P	
- Short striking plate
- Round edged plates available

- Reversible latch
- Steel bolt
- 2 turns
- Front plate: 23 x 3 mm.
- Cylinders: DS-15      DS-10
- Backsets: 

35 / 40 / 45 /
50 / 60 / 70 mm.
- Front plate finishes:
 

Brass / Chromed brass
Golden enamel / Black
Chrome / Matt chrome
Bronze
- Escutcheons: 

410-P	420-P
424-P	425-P
430-P	
- Short striking plate
- Round edged plates available



# RF-700B

# RF-700A

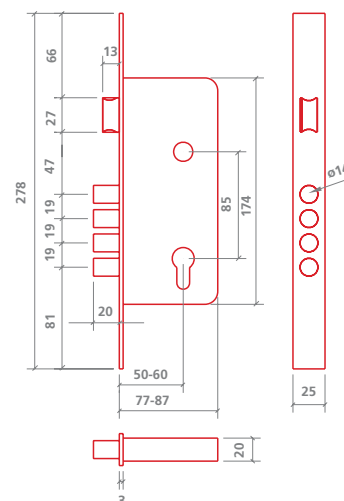
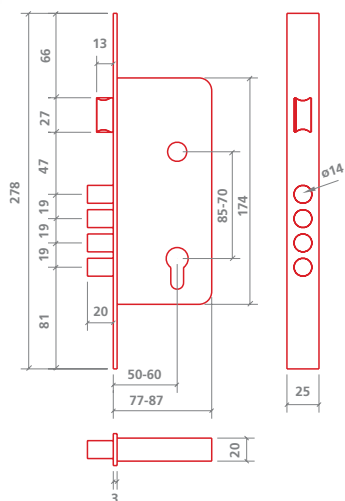

- ANTIBREAKAGE system
- Round steel bolts
- Reversible steel latch
- 2 turns
- Front plate: 25 x 3 mm.
- Cylinders: DS-15      DS-10
- Backsets: 50 / 60 mm.
- Distances: 85 / 70 mm.
- Front plate finishes:
 

Golden enamel / Black
Chrome / Matt chrome
Stainless Steel / Bronze
- Escutcheons: 410-P    420-P  

424-P	425-P
430-P	
- Short striking plate
- Round edged plates available

- ANTIPANIC lock
- Round steel bolts
- Reversible steel latch
- 2 turns
- Front plate: 25 x 3 mm.
- Cylinders: DS-15      DS-10
- Backsets: 50 / 60 mm.
- Front plate finishes:
 

Golden enamel / Black
Chrome / Matt chrome
Stainless Steel / Bronze
- Escutcheons: 410-P    420-P  

424-P	425-P
430-P	
- Short striking plate
- Round edged plates available

# DS-15

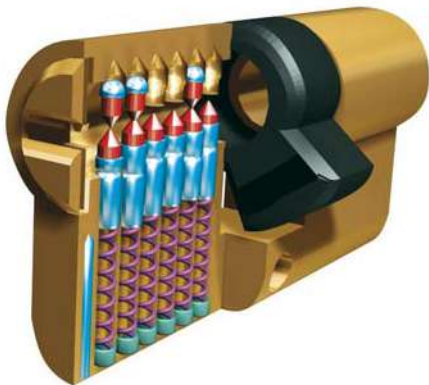

**DS-15 Cylinder**

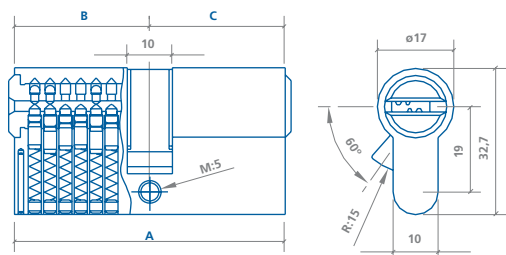

**DS-15 Switch cylinder**

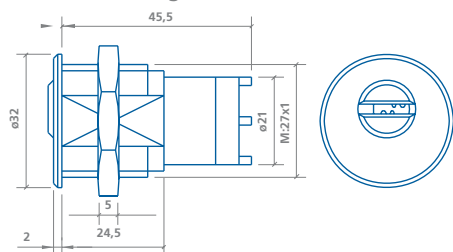

- High security double cylinder with european profile.
- Front drilling resistant by tempered steel bars.
- Anti - picklock profile.
- Five reversible chromed brass keys.
- Double fitting 6 pin cylinder offering excellent technical features.
- High keying possibilities.
- Wide range of sizes, finishes and models : knob cylinders, half-cylinders, switch cylinders, double clutch cylinders, etc.
- Computerized manufacturing process in highly technological machines.
- **Finishes:** Brass/Chrome  
Matt chrome

## Security cards



## sizes

A	B	C	A	B	C	A	B	C
60 mm. (30-30)			65 mm. (30-35)			● 70 mm. (35-35)		
70 mm. (30-40)			● 75 mm. (35-40)			● 80 mm. (40-40)		
80 mm. (30-50)			● 90 mm. (40-50)			90 mm. (30-60)		
● 100 mm. (50-50)			● 110 mm. (55-55)			● 110 mm. (50-60)		
● 120 mm. (60-60)								

● Available in double clutch version.

# DS-10

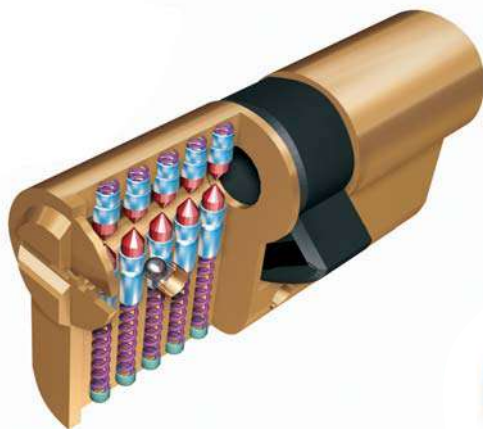

**DS-10 Cylinder**

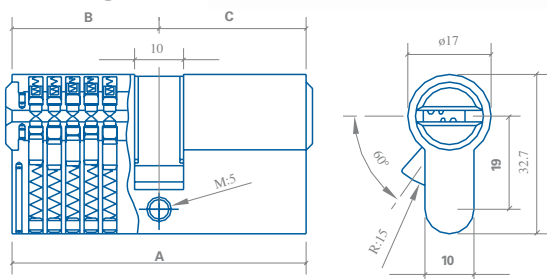

**DS-10 Switch cylinder**

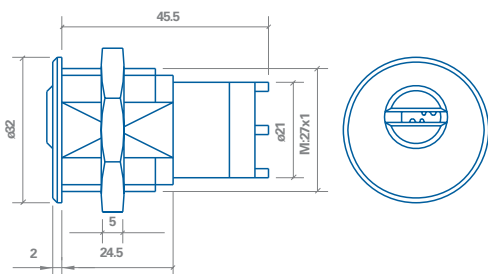

**Security cards**



- High security double cylinder with european profile.
- Front drilling resistant by tempered steel bars.
- Anti - picklock profile.
- Five reversible nickelsilver keys.
- Double pin row featuring on both sides, plus an extra locking device placed at the side, achieving a sophisticated security system.
- High keying possibilities.
- Wide range of sizes, finishes and models: knob cylinders, half-cylinders, switch cylinders, double clutch cylinders, etc.
- **Finishes:** Brass/Chrome  
Matt chrome

**sizes**

A	B	C	A	B	C	A	B	C
60 mm. (30-30)			65 mm. (30-35)			● 70 mm. (35-35)		
70 mm. (30-40)			● 75 mm. (35-40)			● 80 mm. (40-40)		
80 mm. (30-50)			● 90 mm. (40-50)			90 mm. (30-60)		
● 100 mm. (50-50)			● 110 mm. (55-55)			● 110 mm. (50-60)		
● 120 mm. (60-60)								

● Available in double clutch version.

# SEA 3 / SEA 23



SEA 3 / SEA 23 Cylinder

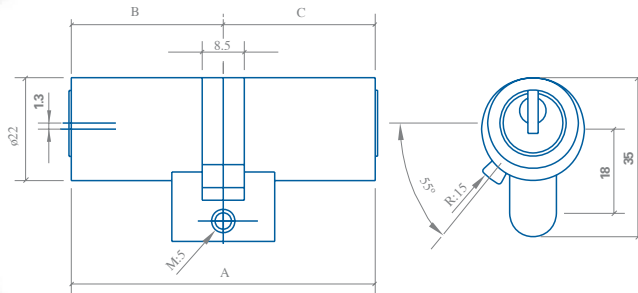

SEA 3 / SEA 23 Switch cylinder

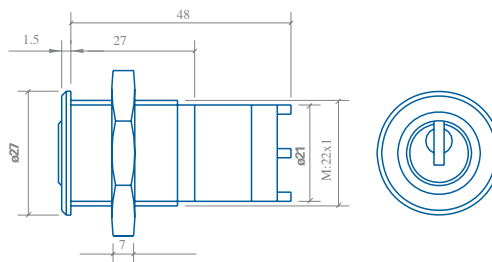

- High security double cylinder with 22 mm swiss profile.
- Front drilling resistant by tempered steel bars.
- Five reversible nickelsilver keys.
- It combines a double row of suspended pins with an extra row at the flank, performing a perfect multilock system.
- High keying possibilities.
- Wide range of sizes, finishes and models : knob cylinders, half-cylinders, switch cylinders, double clutch cylinders, etc.
- *Finishes:* Brass/Chrome

Security cards



sizes			sizes		
A	B	C	A	B	C
65 mm.	(32.5-32.5)		75 mm.	(32.5-42.5)	
85 mm.	(42.5-42.5)		85 mm.	(32.5-52.5)	



## Common features

- Useful protective escutcheons for our whole range of european & swiss cylinder mortise security locks.
- Specially designed to avoid grasping actions.
- Available Finishes:
  - Golden enamel
  - Chrome
  - Matt Chrome
  - Stainless Steel in 420-P & 425-P
  - Black / Bronze

## 410-P

- Including two pieces: *escutcheon* and *internal plate* with inside fixing system.

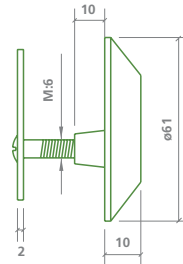

## 420-P

- Including three pieces: *escutcheon*, *internal plate* and *tempered steel cylinder's cap* with an edge that protects the cylinder from being extracted.

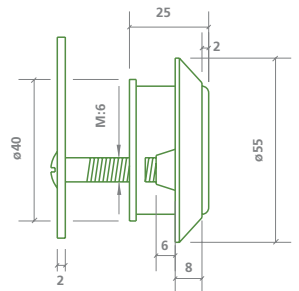
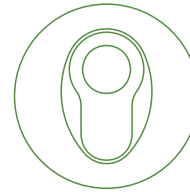

## 424-P

- Double security escutcheon.
- Including three pieces: *escutcheon*, *internal plate* and *tempered steel cylinder's cap* with an edge that protects the cylinder from being extracted.
- The *escutcheon* is fastened through the *internal plate* by a strong screw fixing system. The *cylinder's cap* is fixed by two screws through the lock.
- Available *steel plate* to be placed between the lock and the door's armouring sheet which provides highest protection of the lock and the cylinder, and avoids taking the cylinder's cap out.
- Available *decorative plate*.

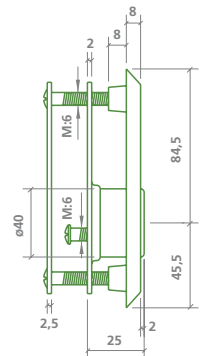
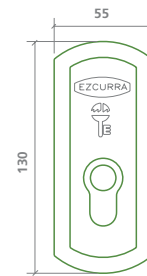

## 425-P

- 420-P escutcheon plus decorative plate.

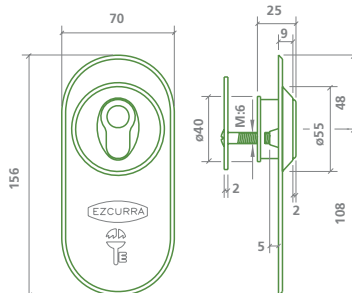

## 430-P

- Including three pieces: *tempered steel escutcheon*, *internal plate* and *brass cover*.
- Hidden cylinder.
- Available washers for exact assembly.
- *Decorative plate* on request.

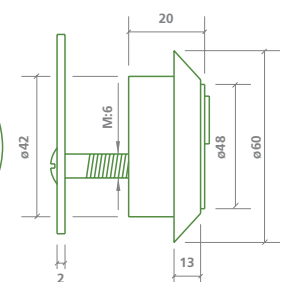
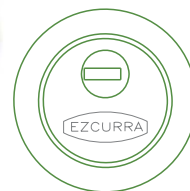



**M-type**  
Lever protection box



**V-type**  
Lever protection box



**long angular**  
Striking plate

45 mm.  
X 2,03 / 2,11 / 2,15 m.



## Hinges

U-shaped security hinges, available in enamel on steel and matt chrome with following sizes:

Width	Height
40 mm.	2.03 m.
45 mm.	2.03 / 2.11 / 2.15 m.



## Profiles for doors and frames

Security door and frame profiles, available in following finishes and sizes:

Enamel on steel / Matt chrome  
1 m. x 40 / 45 mm.

Gold finish Alum. / Silver finish Alum.  
90 cm. / 1 m. x 40 / 45 mm.

## Boxes for lever protection

### M - type

It protects the central bolts from lever actions.

### V - type

It protects the central bolts from lever actions.

It is provided with a special device to fit the latch.

**Ezcurra-Esko, S.A.**

P.O.Box 5  
20540 Escoriaza. (Guipúzcoa) Spain



Tel.: +34 943 71 51 00  
Fax: +34 943 71 41 00

---

e-mail: [ezcurra@ezcurra.com](mailto:ezcurra@ezcurra.com) • [www.ezcurra.com](http://www.ezcurra.com)



**EZCURRA**

*Security*

*Innovation*

*Quality*



**High Security Cylinder Locks**

# Finishes

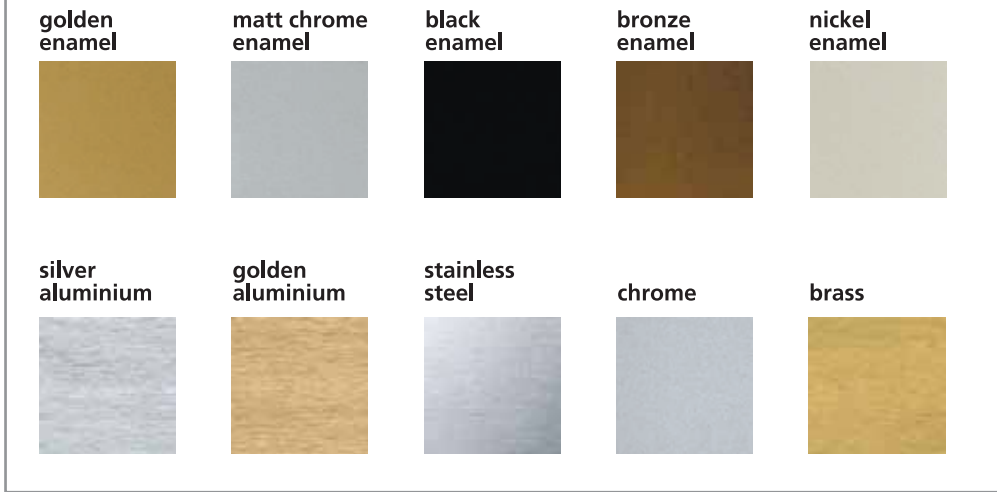

**Made in Spain**

**COMPLETELY MADE IN SPAIN**

Ezcurre is appointed as CE/UE  
Authorised Exporter No. ES/20/0120/12

# Index



Master keying systems ..... page 4



High security cylinders ..... DS-15 ..... page 5  
DS-20 ..... page 5  
K-20 ..... page 6  
K-30 ..... page 6  
SEA-23 ..... page 7  
SEA-3 ..... page 7



High security locks ..... 303 ..... page 8  
307 ..... page 8  
305 ..... page 8  
3040 ..... page 9  
3044 ..... page 9  
3040-Z ..... page 10  
3044-Z ..... page 10  
700 ..... page 11  
701 ..... page 11  
703 ..... page 11  
903/943 ..... page 12  
907/947 ..... page 12  
9040 ..... page 13  
9044 ..... page 13



Escutcheons ..... 410-P ..... page 14  
420-P ..... page 14  
424-P ..... page 14  
425-P ..... page 14  
430-P ..... page 14



Accessories ..... page 15

## New

Every high security lock in this catalogue features an ANTIBREAKAGE SYSTEM, which effectively protects the central steel bolts from being forced backwards.

This system is PATENTED and CERTIFIED by an official aproved centre.



## Master keying system

EZCURRA has developed a masterkeying system that provides Comfort, Performance and Security. For comfort, Ezcurra's master keying system affords the possibility to reduce the usual bunch of keys to only one, able to open the most commonly used locks and cylinders. High Performance and Security, due to the precision and excellent technical features of our cylinders, which allow all kind of keying systems, from the simple master key suite to the grand master key one.

In this way, house entrance doors, post boxes, elevators, garages, desk, and so on, all can be easily masterkeyed to user's convenience.

Nowadays housing, condominiums, offices, hospitals and companies of any size enjoy the quality and security of EZCURRA's master keying system.



### Comunal Entrance Master keying

Group of Locks each one having its own individual key that gives access to its own door and all communal services i.e.: main entrance, garage, lift, terraces, storerooms, etc.

### Simple Master keying

Group of Locks each one having its own individual keys, which opens only that door, and a Master key which opens all the locks. Suitable for offices, warehouses, etc.

### Group Master keying

Several independent groups of Locks each one having its own Master key, and a Grand Master key, which opens all the doors in the locking plan. Suitable for hotels, administrative buildings, schools, companies, etc.

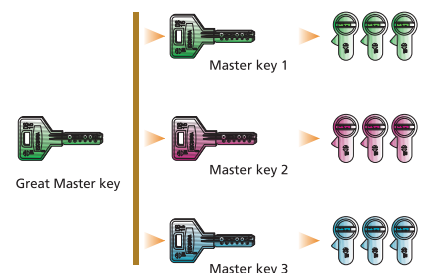
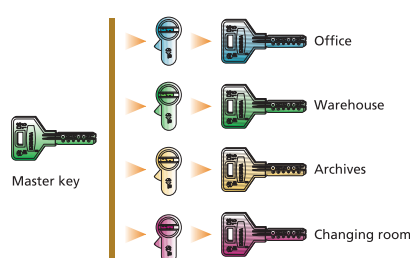
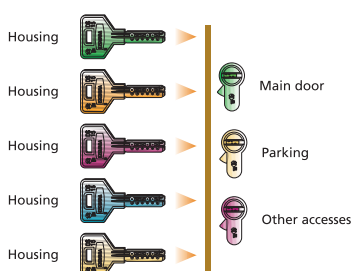

## DS-15

## DS-10

### Common features

- High security double cylinder with european profile.
- Anti - picklock profile.
- Front drilling resistant.
- High keying possibilities.
- Wide range of sizes, finishes and models: knob cylinders, half-cylinders, switch cylinders, double clutch cylinders, etc.
- *Finishes:* Brass/Chrome  
Matt chrome/Black
- **COMPLETELY MADE IN SPAIN**
- Cylinder complies with certification CE UNE-EN 1303:2006

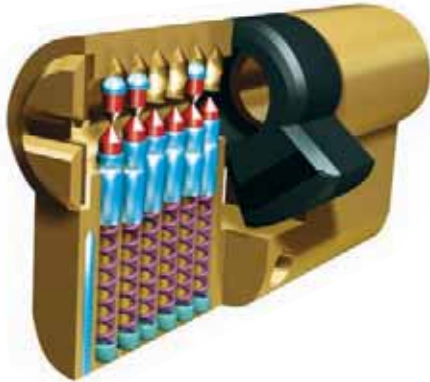

Cylinder DS-15

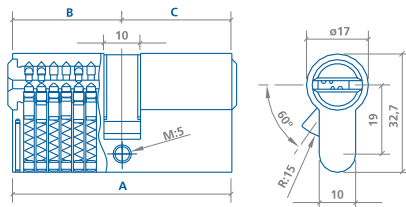

Cylinder DS-10

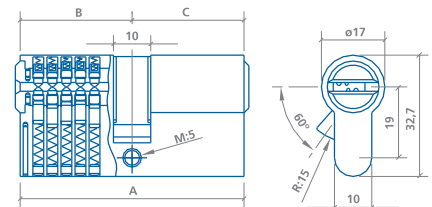

Switch cylinder DS-15

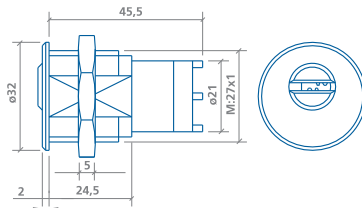

Switch cylinder DS-10

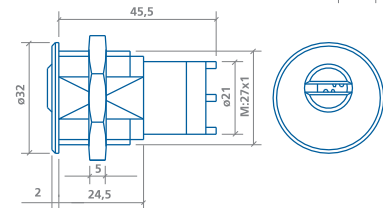

- Double fitting 9 pins in two rows: 3 up + 6 down.
- Front drilling resistance by tempered steel bars.
- 5 Reversible dimple keys on chromed brass.

- Double fitting 10 pins in two rows (5 up + 5 down) + 1 steel ball on the side.
- Front drilling resistance by tempered steel bars in tube and drum.
- 5 Reversible dimple keys on nickel silver.



### sizes

A	B	C	A	B	C	A	B	C	A	B	C	A	B	C
60 mm.	(30-30)		● 75 mm.	(35-40)		85 mm.	(30-55)		90 mm.	(30-60)		● 100 mm.	(40-60)	
65 mm.	(30-35)		● 80 mm.	(40-40)		● 85 mm.	(35-50)		● 90 mm.	(35-55)		● 110 mm.	(55-55)	
● 70 mm.	(35-35)		80 mm.	(30-50)		● 90 mm.	(45-45)		● 95 mm.	(40-55)		● 110 mm.	(50-60)	
70 mm.	(30-40)		● 80 mm.	(35-45)		● 90 mm.	(40-50)		● 100 mm.	(50-50)		● 120 mm.	(60-60)	
75 mm.	(30-45)													

● Available in double clutch version.



# K-20

# K-30

### Common features

- High security cylinder with **17 pins** (12 in two rows + 5 in an extra side row) acting to achieve a sophisticated security system which increases exponentially its **master keying** possibilities.
- **Anti-picklock** and **antibumping** european profile.
- **Front drilling resistance** by tempered steel ring in the drum and tempered steel bar in the tube.
- Wide range of sizes and versions: knob cylinders, double clutch cylinders, half cylinders, switch cylinders, etc.
- Finishes: Brass / Chromed brass / Matt chrome / Black
- **COMPLETELY MADE IN SPAIN**
- Cylinder complies with certification CE UNE-EN 1303:2006

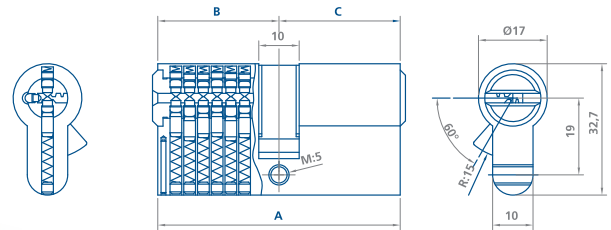
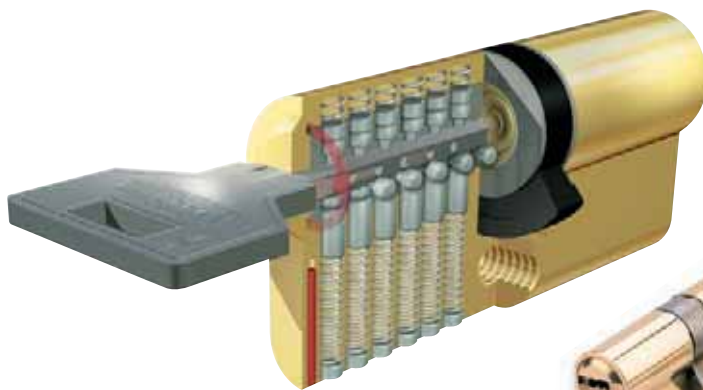

- Triple fitting 17 brass pins in 2 rows of 6 pins + 1 extra row of 5 pins on the side.
- 5 Reversible dimple keys on chromed brass.

- Triple fitting 17 STAINLESS STEEL pins in 2 rows of 6 pins + 1 extra row of 5 STAINLESS STEEL pins on the side.
- 5 Reversible dimple keys on nickel silver.



### sizes

A	B	C	A	B	C	A	B	C	A	B	C	
60 mm. (30-30)			● 75 mm. (35-40)			85 mm. (30-55)			90 mm. (30-60)			● 100 mm. (40-60)
65 mm. (30-35)			● 80 mm. (40-40)			● 85 mm. (35-50)			● 90 mm. (35-55)			● 110 mm. (55-55)
● 70 mm. (35-35)			80 mm. (30-50)			● 90 mm. (45-45)			● 95 mm. (40-55)			● 110 mm. (50-60)
70 mm. (30-40)			● 80 mm. (35-45)			● 90 mm. (40-50)			● 100 mm. (50-50)			● 120 mm. (60-60)
75 mm. (30-45)												

● Available in double clutch version.

# SEA 3 / SEA 23



SEA 3 / SEA 23 Cylinder

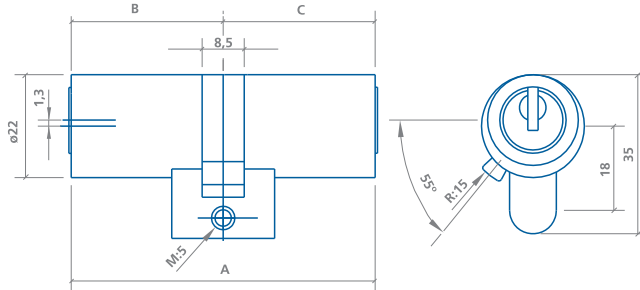

SEA 3 / SEA 23 Switch cylinder

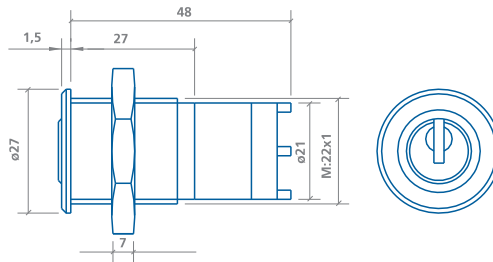

Security cards



- High security double cylinder with 22 mm. swiss profile or europrofile.
- Front drilling resistant by tempered steel bars.
- Five reversible nickelsilver keys.
- It combines a double row of suspended pins with an extra row at the flank, performing a perfect multilock system.
- High keying possibilities.
- Wide range of sizes, finishes and models: knob cylinders, half-cylinders, switch cylinders, etc.
- *Finishes:* SWISS PROFILE: Brass / Chrome  
EUROPROFILE: Chrome

swiss profile sizes

A	B	C
65 mm.	(32,5-32,5)	
75 mm.	(32,5-42,5)	
85 mm.	(42,5-42,5)	
85 mm.	(32,5-52,5)	
95 mm.	(32,5-52,5)	
95 mm.	(42,5-62,5)	
105 mm.	(52,5-52,5)	
105 mm.	(32,5-72,5)	
105 mm.	(42,5-62,5)	
115 mm.	(32,5-82,5)	
115 mm.	(42,5-72,5)	
115 mm.	(52,5-62,5)	
125 mm.	(62,5-62,5)	
125 mm.	(32,5-92,5)	
125 mm.	(42,5-82,5)	
125 mm.	(52,5-72,5)	

europrofile sizes

A	B	C
60 mm.	(30-30)	
65 mm.	(30-35)	
70 mm.	(35-35)	
70 mm.	(30-40)	
75 mm.	(35-40)	
75 mm.	(30-45)	
80 mm.	(40-40)	
80 mm.	(30-50)	
80 mm.	(35-45)	
85 mm.	(30-55)	
85 mm.	(35-50)	
85 mm.	(40-45)	
90 mm.	(30-60)	
90 mm.	(40-50)	
95 mm.	(40-55)	
100 mm.	(50-50)	
100 mm.	(30-70)	
100 mm.	(40-60)	
110 mm.	(30-80)	
110 mm.	(40-70)	
110 mm.	(50-60)	
120 mm.	(60-60)	
120 mm.	(30-90)	
120 mm.	(40-80)	
120 mm.	(50-70)	

## 303

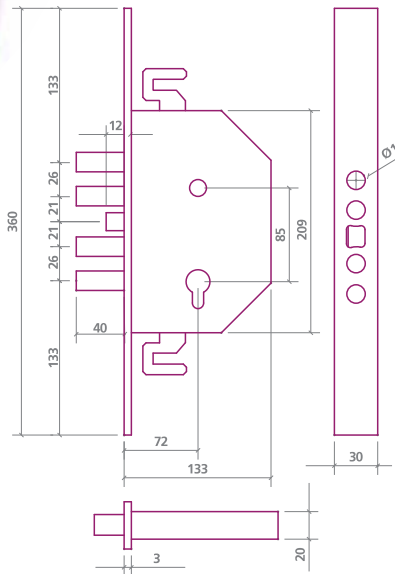

## 307

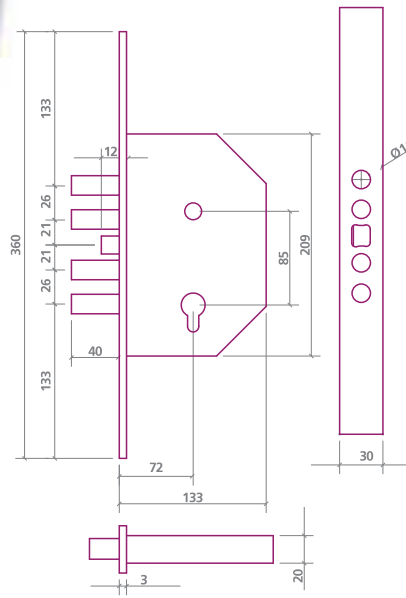

## 305

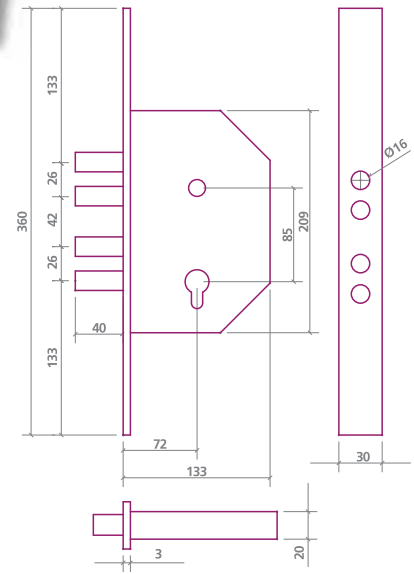

- ANTIBREAKAGE System
- Round steel bolts Ø16 mm.
- Reversible latch
- 4 Turns
- Up & down locking points with transmission rods
- Closed case
- Front plate profile 30 x 3 mm.
- Security Cylinder: DS-15, DS-10, K-20, K-30, SEA
- Backset: 72 mm. / Centres: 85 mm.
- Finishes: Brass / Chromed brass  
Golden / Matt Chrome /  
Nickel / Bronze /  
Black enamel on steel
- Short striking plate
- Security Escutcheon: 

410-P	420-P
424-P	425-P
430-P	

- ANTIBREAKAGE System
- Round steel bolts Ø16 mm.
- Reversible latch
- 4 Turns
- Closed case
- Front plate profile 30 x 3 mm.
- Security Cylinder: DS-15, DS-10, K-20, K-30, SEA
- Backset: 72 mm. / Centres: 85 mm.
- Finishes: Brass / Chromed brass  
Golden / Matt Chrome /  
Nickel / Bronze /  
Black enamel on steel
- Short striking plate
- Security Escutcheon: 

410-P	420-P
424-P	425-P
430-P	

- ANTIBREAKAGE System
- Round steel bolts Ø16 mm.
- 4 Turns
- Closed case
- Front plate profile 30 x 3 mm.
- Security Cylinder: DS-15, DS-10, K-20, K-30, SEA
- Backset: 72 mm. / Centres: 85 mm.
- Finishes: Brass / Chromed brass  
Golden / Matt Chrome  
Nickel / Bronze  
Black enamel on steel
- Short striking plate
- Security Escutcheon: 

410-P	420-P
424-P	425-P
430-P	

# 3040

# 3044

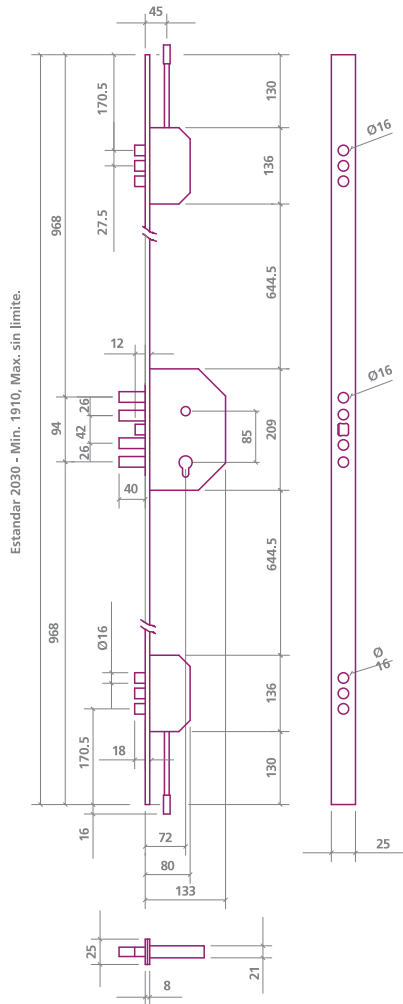

- ANTIBREAKAGE System
  - Central + 2 auxiliary locks
  - Round steel bolts Ø16 mm.
  - Reversible latch
  - 4 Turns
  - Up & down locking points
  - Closed cases
  - Front plate profile 25 x 8 mm.
  - Security Cylinder: DS-15, DS-10, K-20, K-30, SEA
  - Backset: 72 mm. / Centres: 85 mm.
  - Finishes: Brass / Chromed brass  
Golden / Matt Chrome / Nickel  
Bronze / Black enamel on steel  
Golden / Silver finish on aluminium  
Stainless steel
  - Striking plate: Short pieces.  
Long pieces: 40 / 45 mm.
  - Security Escutcheon: 

410-P	420-P
424-P	425-P
430-P	
- Ref.: 3040/3 without up & downwards locking points.

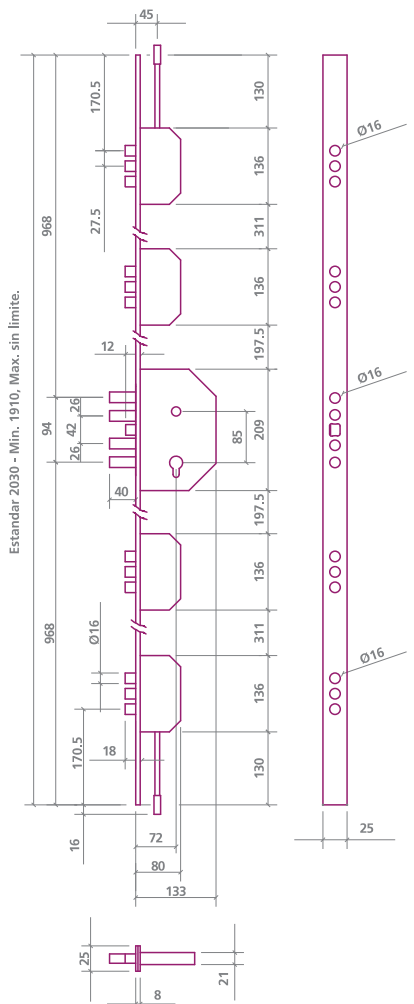
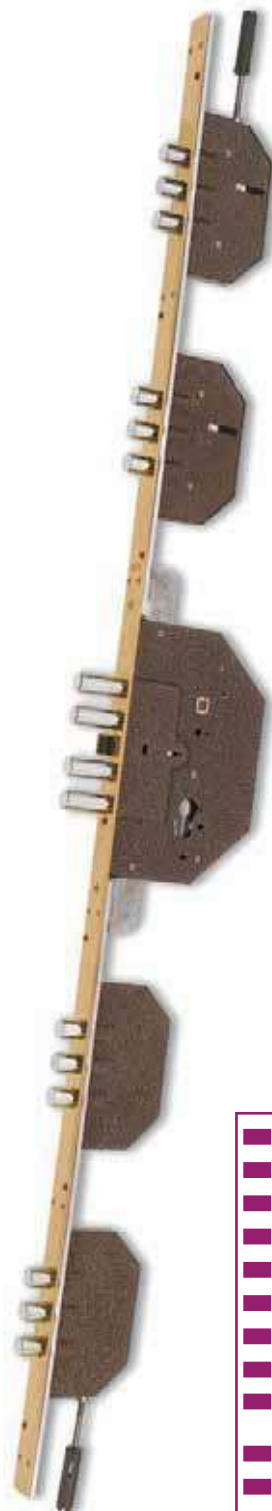

- ANTIBREAKAGE System
  - Central + 4 auxiliary locks
  - Round steel bolts Ø16 mm.
  - Reversible latch
  - 4 Turns
  - Up & down locking points
  - Closed cases
  - Front plate profile 25 x 8 mm.
  - Security Cylinder: DS-15, DS-10, K-20, K-30, SEA
  - Backset: 72 mm. / Centres: 85 mm.
  - Finishes: Brass / Chromed brass  
Golden / Matt Chrome / Nickel  
Bronze / Black enamel on steel  
Golden / Silver finish on aluminium  
Stainless steel
  - Striking plate: Short pieces.  
Long pieces: 40 / 45 mm.
  - Security Escutcheon: 

410-P	420-P
424-P	425-P
430-P	
- Ref.: 3044/3 without up & downwards locking points.

## 3040-Z

## 3044-Z

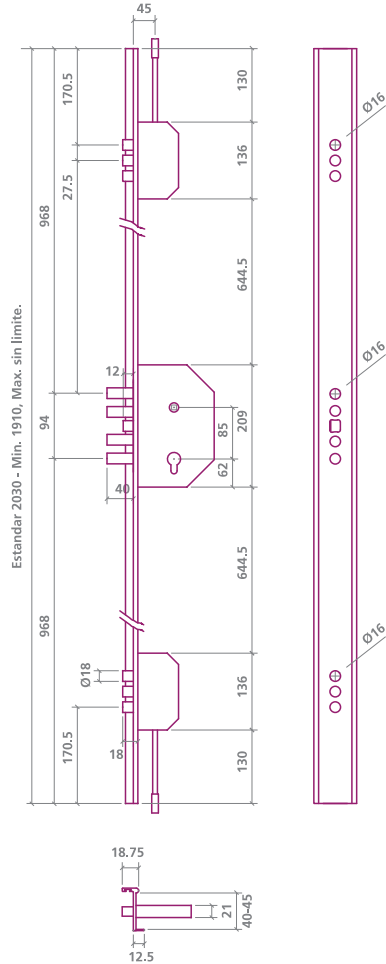

- ANTIBREAKAGE System
  - Central + 2 auxiliary locks
  - Round steel bolts Ø16 mm.
  - Reversible latch
  - 4 Turns
  - Up & down locking points
  - Closed cases
  - Front plate Z profile: 40 / 45 mm.
  - Security Cylinder: DS-15, DS-10, K-20, K-30, SEA
  - Backset: 72 mm. / Centres: 85 mm.
  - Finishes: Golden / Matt Chrome / Nickel Bronze / Black enamel on aluminium  
Golden / Matt Chrome / Nickel Bronze / Black enamel on steel  
Golden  
Silver finish aluminium
  - Long angular striking plate
  - Security Escutcheon: 410-P 420-P  
424-P 425-P  
430-P
- Ref.: 3040Z/3 without up & downwards locking points.  
Steel models do not include isolating rubber profile.

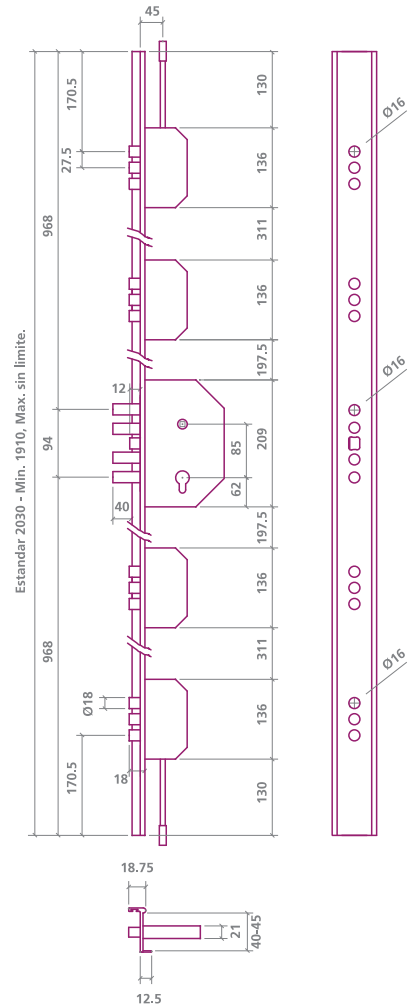

- ANTIBREAKAGE System
  - Central + 2 auxiliary locks
  - Round steel bolts Ø16 mm.
  - Reversible latch
  - 4 Turns
  - Up & down locking points
  - Closed cases
  - Front plate Z profile: 40 / 45 mm.
  - Security Cylinder: DS-15, DS-10, K-20, K-30, SEA
  - Backset: 72 mm. / Centres: 85 mm.
  - Finishes: Golden / Matt Chrome / Nickel Bronze / Black enamel on aluminium  
Golden / Matt Chrome / Nickel Bronze / Black enamel on steel  
Golden  
Silver finish aluminium
  - Long angular striking plate
  - Security Escutcheon: 410-P 420-P  
424-P 425-P  
430-P
- Ref.: 3044Z/3 without up & down locking points.  
Steel models do not include isolating rubber profile.

## 700

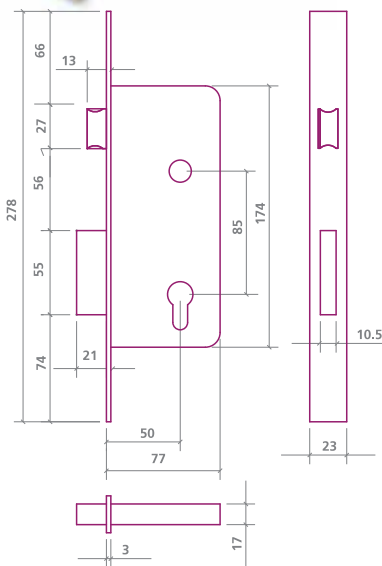

- Cylinder High Security Lock
- Rectangular steel bolt
- Reversible Latch
- 2 Turns
- Front plate profile 23 x 3 mm.
- Security Cylinder: DS-15, DS-10, K-20, K-30, SEA
- Backset: 50 mm. / Centres: 85 mm.
- Finishes: Brass / Chromed brass
- Short striking plate
- Security Escutcheon: 

410-P	420-P
424-P	425-P
430-P	

## 701

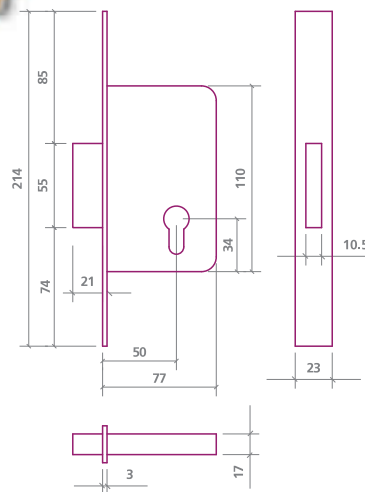

- Cylinder High Security Lock
- Rectangular steel bolt
- 2 Turns
- Front plate profile 23 x 3 mm.
- Security Cylinder: DS-15, DS-10, K-20, K-30, SEA
- Backset: 50 mm.
- Finishes: Brass / Chromed brass
- Short striking plate
- Security Escutcheon: 

410-P	420-P
424-P	425-P
430-P	

## 703

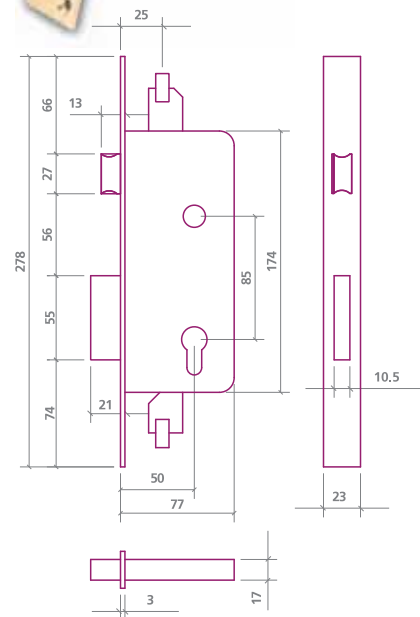

- Cylinder High Security Lock
- Rectangular steel bolt
- Reversible latch
- 2 Turns
- Up & down locking point with threaded bars
- Front plate profile 30 x 3 mm.
- Security Cylinder: DS-15, DS-10, K-20, K-30, SEA
- Backset: 50 mm. / Centres: 85 mm.
- Finishes: Brass / Chromed brass
- Short striking plate
- Security Escutcheon: 

410-P	420-P	424-P
425-P	430-P	

## 943

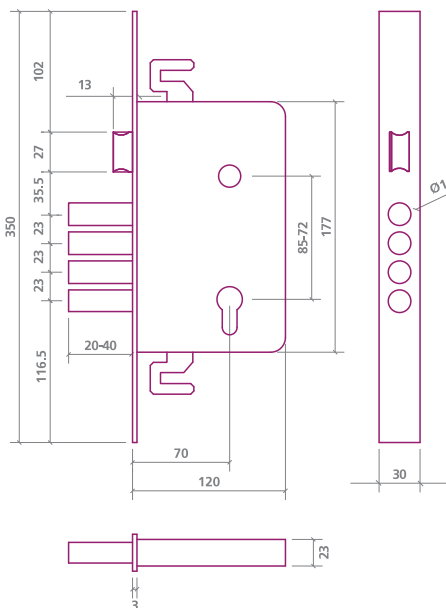
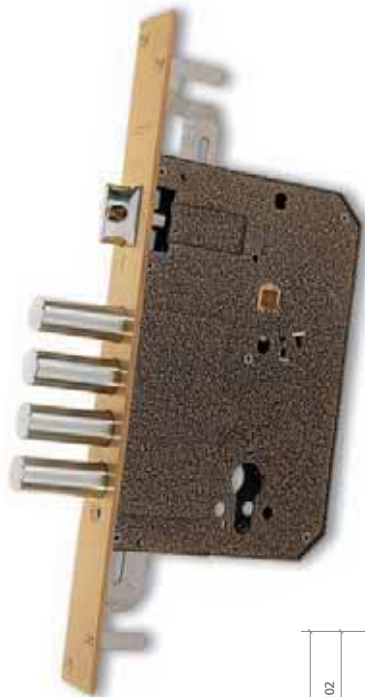

- Cylinder High Security Lock
- Round steel bolts Ø16 mm.
- Reversible latch
- 4 Turns
- Up & down locking points
- Closed case
- Front plate profile: 30 x 3 mm.
- Security Cylinder: DS-15, DS-10, K-20, K-30, SEA
- Backset: 70 mm.
- Centres: 85 / 72 mm.
- Finishes: Brass / Chromed brass  
Golden / Matt Chrome / Nickel  
Bronze / Black enamel on steel
- Short striking plate
- Escutcheon: 410-P    420-P    424-P  
                  425-P    430-P

## 947

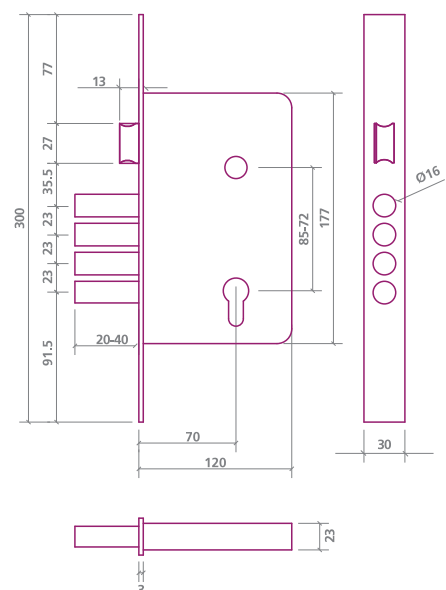

- Cylinder High Security Lock
- Round steel bolts Ø16 mm.
- Reversible latch
- 4 Turns
- Closed case
- Front plate profile: 30 x 3 mm.
- Security Cylinder: DS-15, DS-10, K-20, K-30, SEA
- Backset: 70 mm.
- Centres: 85 / 72 mm.
- Finishes: Brass / Chromed brass  
Golden / Matt Chrome / Nickel  
Bronze / Black enamel on steel
- Short striking plate
- Escutcheon: 410-P    420-P    424-P  
                  425-P    430-P

## 9040

## 9044

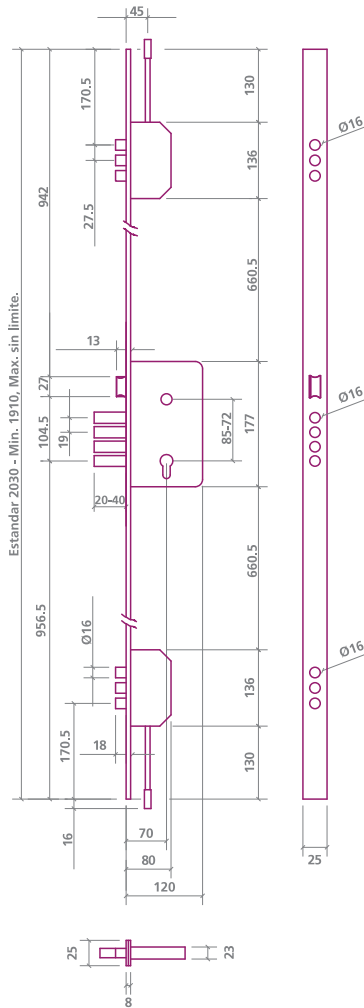

- Cylinder High Security Lock
- Central + 2 auxiliary locks
- Round steel bolts Ø16 mm.
- Reversible latch
- 4 Turns
- Up & down locking points
- Closed cases
- Front plate profile: 25 x 8 mm.
- Security Cylinder: DS-15, DS-10, K-20, K-30, SEA
- Backset: 70 mm.
- Centres: 85 / 72 mm.
- Finishes: Brass / Chromed brass  
Golden / Matt Chrome / Nickel  
Bronze / Black enamel on steel  
Stainless steel
- Striking plate: Short pieces  
Long pieces: 40 / 45 mm.
- Escutcheon: 410-P 420-P 424-P  
425-P 430-P

Ref.: 9040/3 without up & downwards locking points.

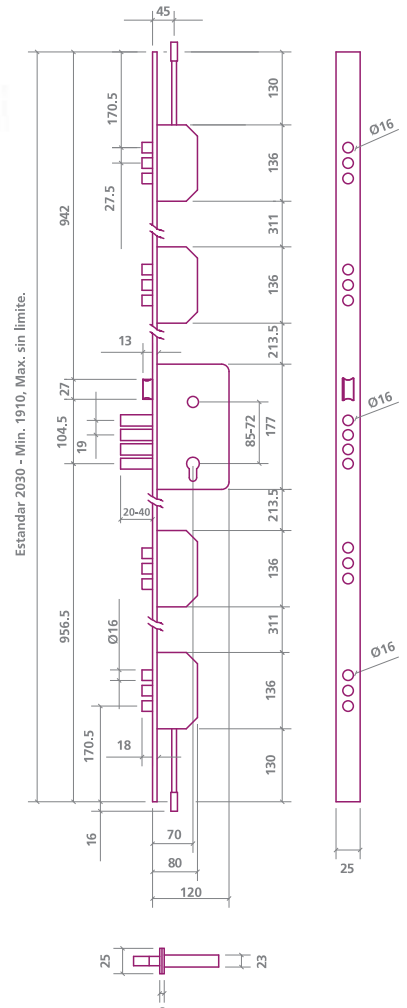

- Cylinder High Security Lock
- Central + 4 auxiliary locks
- Round steel bolts Ø16 mm.
- Reversible latch
- 4 Turns
- Up & down locking points
- Closed cases
- Front plate profile: 25 x 8 mm.
- Security Cylinder: DS-15, DS-10, K-20, K-30, SEA
- Backset: 70 mm.
- Centres: 85 / 72 mm.
- Finishes: Brass / Chromed brass  
Golden / Matt Chrome / Nickel  
Bronze / Black enamel on steel  
Stainless steel
- Striking plate: Short pieces  
Long pieces: 40 / 45 mm.
- Escutcheon: 410-P 420-P 424-P  
425-P 430-P

Ref.: 9044/3 without up & downwards locking points.



**EZCURRA**

## Common features

- Useful protective escutcheons for our whole range of european & swiss cylinder mortise security locks.
- Specially designed to avoid grasping actions.
- Available Finishes:  
Golden / Matt Chrome  
Nickel / Bronze  
Black enamel  
Chrome  
Stainless steel in 420-P,  
425-P & 430-P

## 410-P

- Including two pieces: *escutcheon* and *internal plate* with inside fixing system.

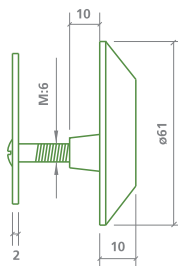
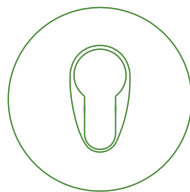

## 420-P

- Including three pieces: *escutcheon*, *internal plate* and *tempered steel cylinder's cap* with an edge that protects the cylinder from being extracted.

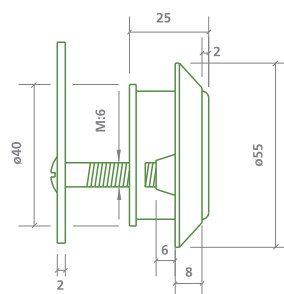
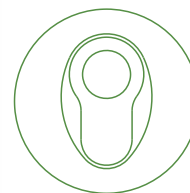

## 424-P

- Double security escutcheon.
- Including three pieces: *escutcheon*, *internal plate* and *tempered steel cylinder's cap* with an edge that protects the cylinder from being extracted.
- The *escutcheon* is fastened through the *internal plate* by a strong screw fixing system. The *cylinder's cap* is fixed by two screws through the lock.
- Available *steel plate* to be placed between the lock and the door's armouring sheet which provides highest protection of the lock and the cylinder, and avoids taking the cylinder's cap out.
- Available *decorative plate*.

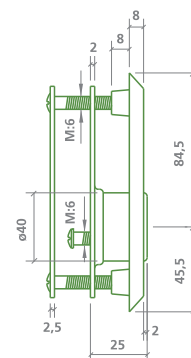
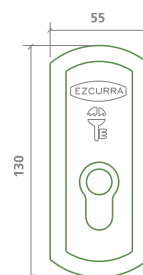

## 425-P

- 420-P escutcheon plus decorative plate.

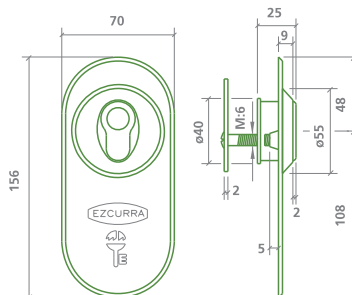

## 430-P

- Including three pieces: *tempered steel escutcheon*, *internal plate* and *brass cover*.
- Hidden cylinder.
- Available washers for exact assembly.
- Decorative plate* on request.

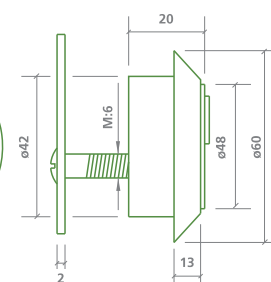



M-type  
Lever protection box

V-type  
Lever protection box

## Boxes for lever protection

### M-type

It protects the central bolts from lever actions.

### V-type

It protects the central bolts from lever actions.

It is provided with a special device to fit the latch.



## long angular Striking Plate

45 mm.  
X 2,03 / 2,11 / 2,15 m.

## Guides and Anti-dust protectors



## Hinge

U+L shaped reversible SECURITY HINGE with 4 bearings, available in the following finishes and sizes:

Golden / Matt Chrome / Nickel Bronze / Black enamel on steel

Width	Height
40 mm.	2.03 m.
45 mm.	2.03 / 2.11 m.

## Profiles for doors and frames

Security crosspieces and angular profiles available in following finishes and sizes:

Golden / Matt Chrome / Nickel Bronze / Black enamel on steel  
1 m. x 40 / 45 mm.

Golden / Silver finish aluminium  
90 cm. / 1 m. x 40 / 45 mm.

## **Ezcurra-Esko, S.A.**

Apartado (P.O.Box) 5  
20540 Escoriaza. (Guipúzcoa) Spain



Tel.: +34 943 71 51 00  
Fax: +34 943 71 41 00

---

e-mail: [ezcurra@ezcurra.com](mailto:ezcurra@ezcurra.com) • [www.ezcurra.com](http://www.ezcurra.com)



**EZCURRA**

*S*ecurity

*I*nnovation

*Q*uality

**High Security Lever Locks**

# Index



**Multipoint high security lever locks** \_\_\_\_\_ **B-2000B** \_\_\_\_\_ page 4  
**B-2040B** \_\_\_\_\_ page 4  
**B-2044B** \_\_\_\_\_ page 4



**One-point high security lever locks** \_\_\_\_\_ **803B** \_\_\_\_\_ page 5  
**805B** \_\_\_\_\_ page 5  
**807B** \_\_\_\_\_ page 5  
**843B** \_\_\_\_\_ page 6  
**845B** \_\_\_\_\_ page 6  
**847B** \_\_\_\_\_ page 6



**Accessories** \_\_\_\_\_ page 7



# B-2000B

# B-2040B

# B-2044B

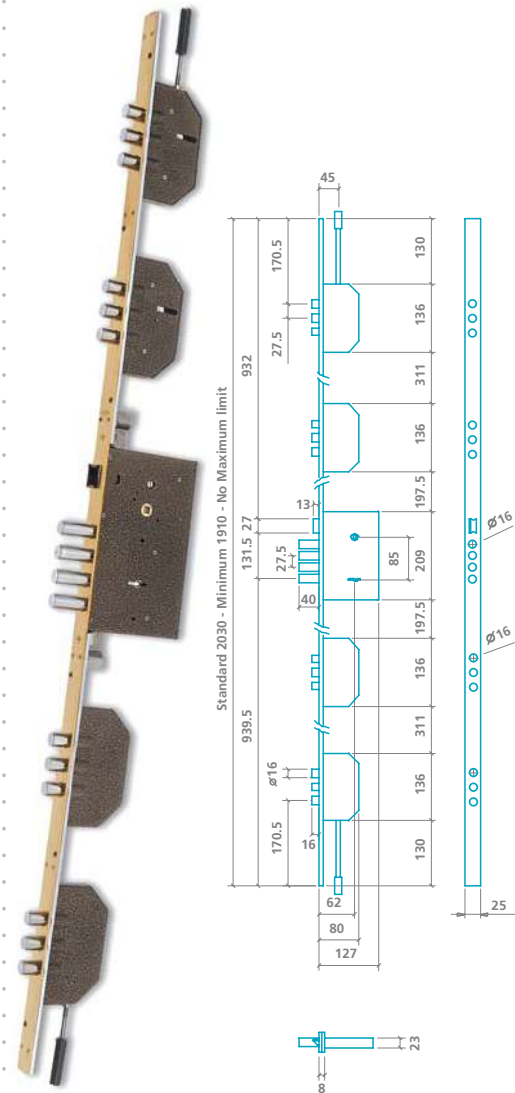
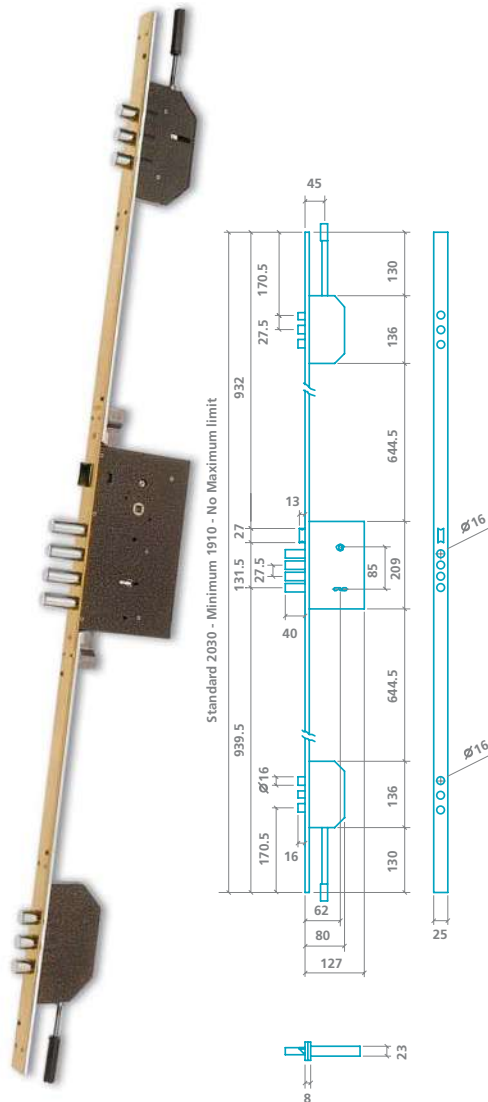
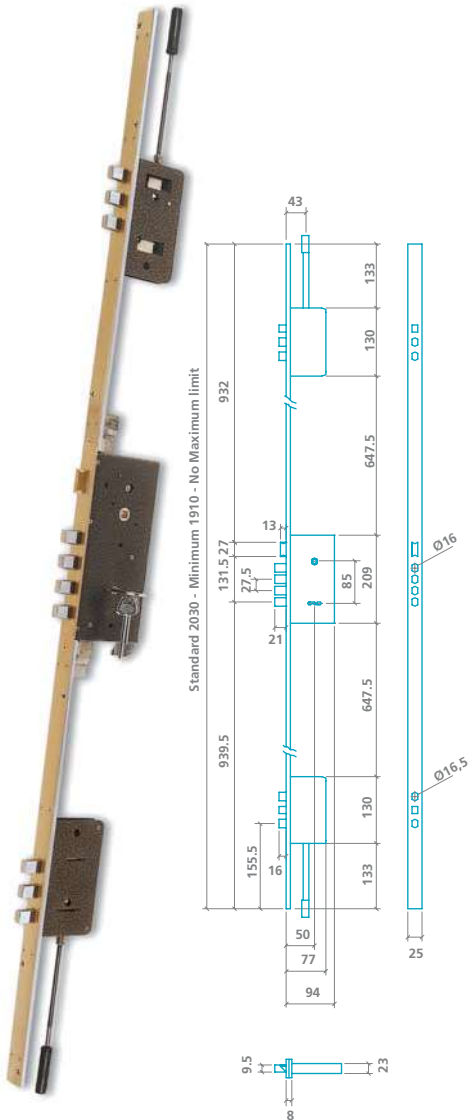

- High Security Lock with double effect lever system
- Central + 2 auxiliary locks
- Square steel bolts
- Reversible Latch
- 2 Turns
- Up & downwards locking points
- Closed cases
- Front plate profile 25 x 8 mm.
- Backset: 50 mm.
- Finishes: Brass
- Chromed brass
- Striking plate: Short pieces
- Long pieces: 40 / 45 mm.
- Escutcheon

Ref.: B-2000B/3 without up & downwards locking points.

- High Security Lock with double effect lever system
- Central + 2 auxiliary locks
- Round steel bolts Ø16 mm.
- Reversible Latch
- 4 Turns
- Up & downwards locking points
- Closed cases
- Front plate profile 25 x 8 mm.
- Backset: 62 mm.
- Finishes: Brass
- Chromed brass
- Striking plate: Short pieces
- Long pieces: 40 / 45 mm.
- Escutcheon

Ref.: B-2040B/3 without up & downwards locking points.

- High Security Lock with double effect lever system
- Central + 4 auxiliary locks
- Round steel bolts Ø16 mm.
- Reversible Latch
- 4 Turns
- Up & downwards locking points
- Closed cases
- Front plate profile 25 x 8 mm.
- Backset: 62 mm.
- Finishes: Brass
- Chromed brass
- Striking plate: Short pieces
- Long pieces: 40 / 45 mm.
- Escutcheon

Ref.: B-2044B/3 without up & downwards locking points.

# 803B

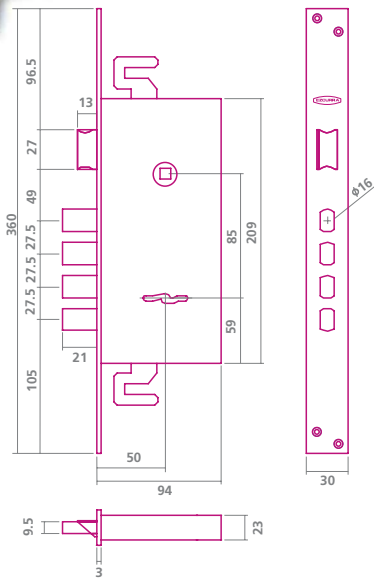

# 805B

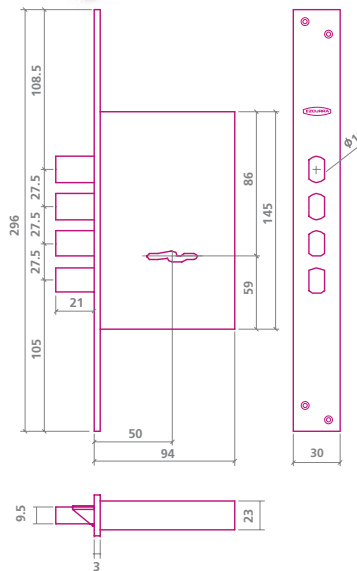

# 807B

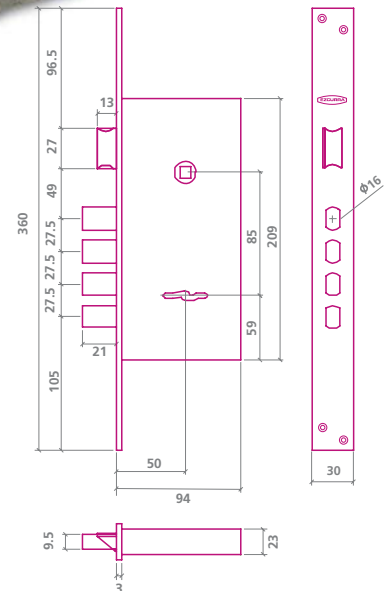

- High Security Lock with double effect lever system
- Square steel bolts
- Reversible Latch
- 2 Turns
- Up & down locking points with transmission rods
- Closed case
- Front plate profile 30 x 3 mm.
- Backset: 50 mm.
- Finishes: Brass  
Chromed brass
- Striking plate
- Escutcheon

- High Security Lock with double effect lever system
- Square steel bolts
- Reversible Latch
- 2 Turns
- Closed case
- Front plate profile 30 x 3 mm.
- Backset: 50 mm.
- Finishes: Brass  
Chromed brass
- Striking plate
- Escutcheon

- High Security Lock with double effect lever system
- Square steel bolts
- Reversible Latch
- 2 Turns
- Closed case
- Front plate profile 30 x 3 mm.
- Backset: 50 mm.
- Finishes: Brass  
Chromed brass
- Striking plate
- Escutcheon

# 843B

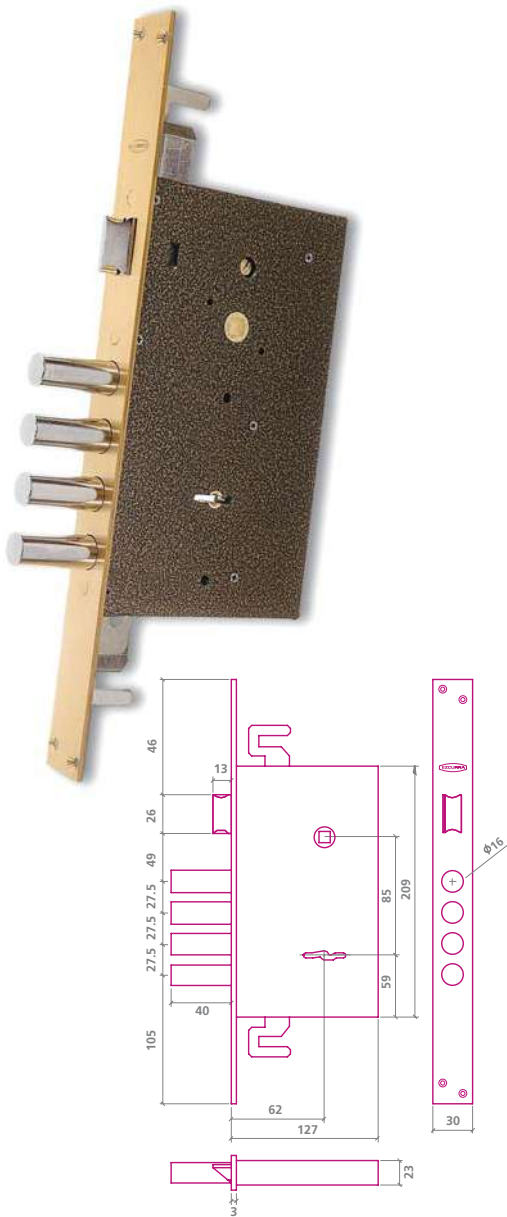

# 845B

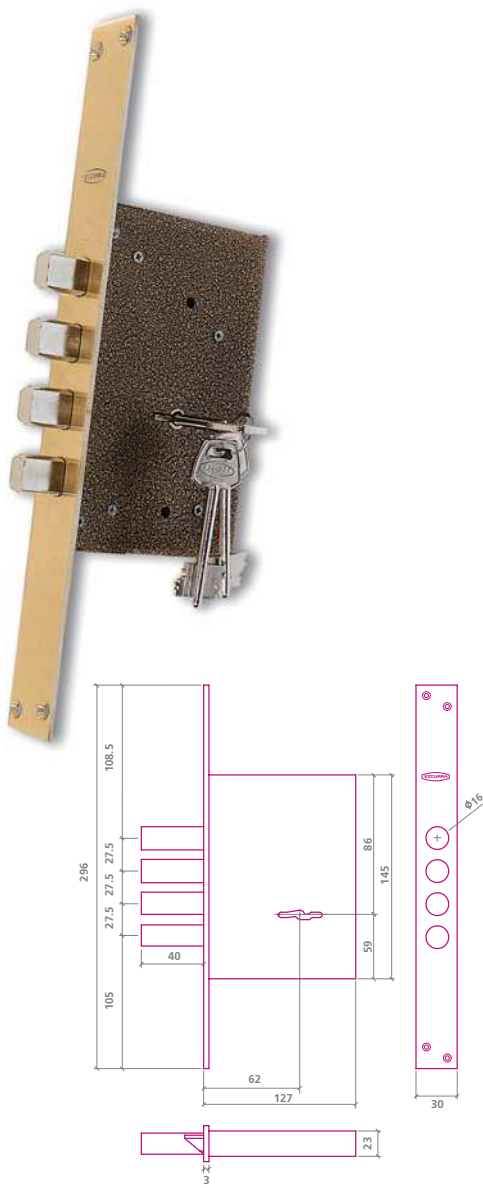

# 847B

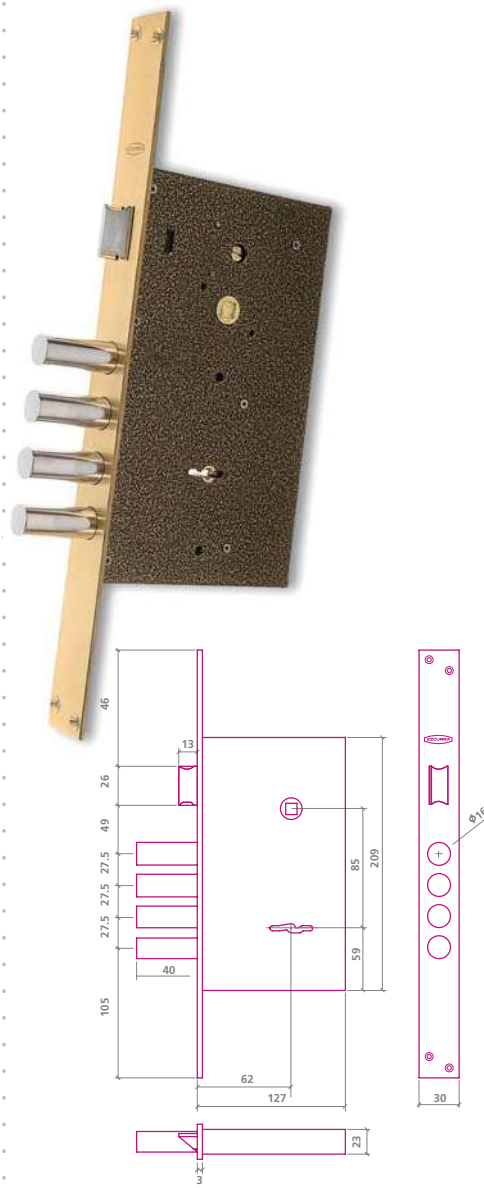

- High Security Lock with double effect lever system
- Round steel bolts Ø16 mm.
- Reversible Latch
- 4 Turns
- Up & down locking points with transmission rods
- Closed case
- Front plate profile 30 x 3 mm.
- Backset: 62 mm.
- Finishes: Brass  
Chromed brass
- Striking plate
- Escutcheon

- High Security Lock with double effect lever system
- Square steel bolts
- 4 Turns
- Closed case
- Front plate profile 30 x 3 mm.
- Backset: 62 mm.
- Finishes: Brass  
Chromed brass
- Striking plate
- Escutcheon

- High Security Lock with double effect lever system
- Round steel bolts Ø16 mm.
- Reversible Latch
- 4 Turns
- Closed case
- Front plate profile 30 x 3 mm.
- Backset: 62 mm.
- Finishes: Brass  
Chromed brass
- Striking plate
- Escutcheon





Lever set



Security escutcheon for lever locks



long Key



short Key

## Guides and Anti-dust Protectors

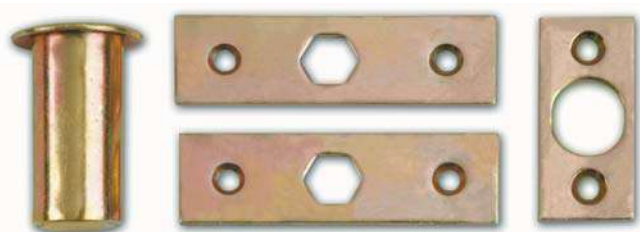

## Key Guide plate set



**Ezcurra-Esko, S.A.**

P.O.Box 5  
20540 Escoriaza. (Guipúzcoa) Spain



Tel.: +34 943 71 51 00  
Fax: +34 943 71 41 00

---

e-mail: [ezcurra@ezcurra.com](mailto:ezcurra@ezcurra.com) • [www.ezcurra.com](http://www.ezcurra.com)



**EZCURRA**

**Cilindros de alta seguridad**  
**High security cylinders**

**SERIE**



**K**

**SERIES**

seguridad · innovación · calidad · security · innovation · quality

# SERIE **K** SERIES

## Cilindros de **alta seguridad** con **17 PITONES**:

**12 EN LÍNEA + 5 LATERALES**, que actúan combinadamente, dando como resultado un sofisticado sistema de seguridad que además aumenta exponencialmente sus posibilidades de **amaestramiento**.

Cilindros con **perfil europeo ANTIGANZÚA y ANTIBUMPING**.

**Protección frontal ANTITALADRO** por anilla de acero templado en el tambor y barra en el canuto.

Disponibles en una amplia gama de medidas, acabados y versiones: doble embrague, microconmutadores, con pomo, medios cilindros, etc.

**FABRICACIÓN ÍNTEGRA EN ESPAÑA** bajo norma UNE-EN 1303:2006.

## **High security** cylinders with **17 PINS**:

**12 in two rows + 5 in an extra side row**, acting to achieve a sophisticated **ANTIBUMPING** security system which increases exponentially its **master keying** possibilities.

Cylinders featuring european **ANTI-PICKLOCK profile**.

**Front DRILLING RESISTANCE** by tempered steel ring in the drum and tempered steel bar in the tube.

Available in a wide range of sizes, finishes and versions: double clutch cylinders, switches, knob cylinders, half cylinders, etc.

**Completely MADE IN SPAIN** in accordance with regulation UNE-EN 1303:2006.

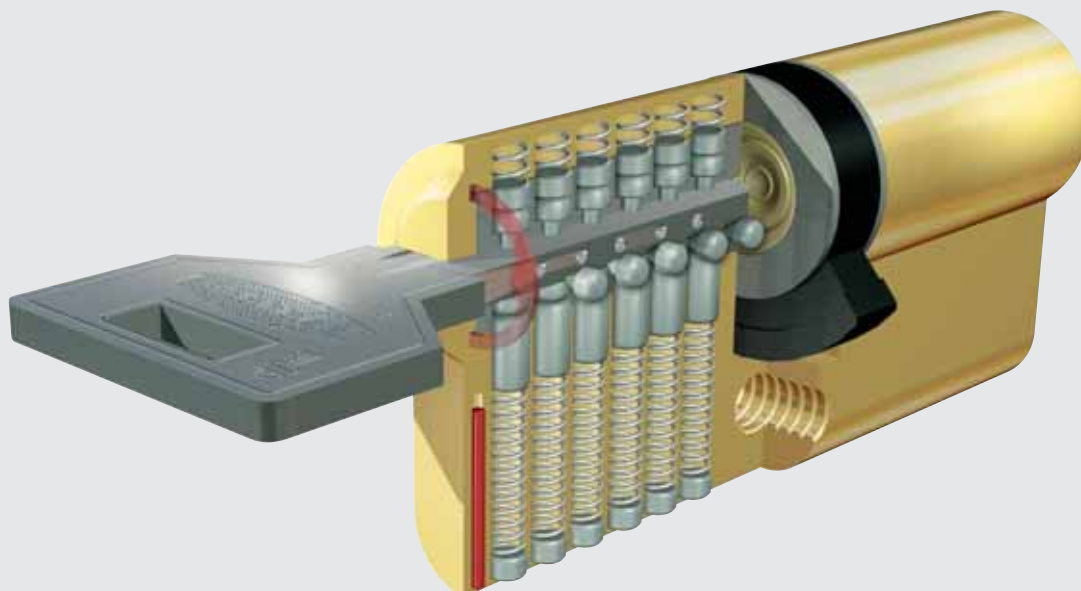
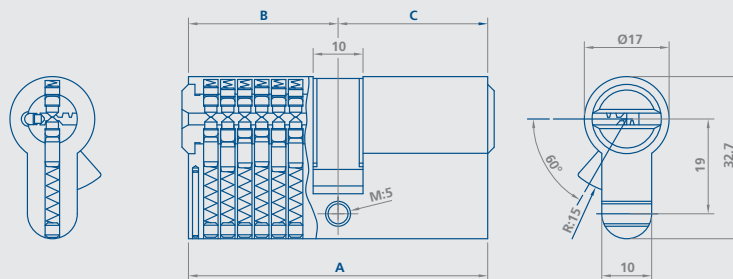



# K-30

**17 PITONES de  
ACERO INOXIDABLE:**  
12 en línea + 5 laterales

**5 LLAVES DE ALPACA reversibles**

**17 STAINLESS STEEL PINS:**  
12 in two rows + 5 in extra side row

**5 reversible NICKEL SILVER KEYS**



Tarjeta de Seguridad  
Security card





# K-20

**17 PITONES de LATÓN:**  
12 en línea + 5 laterales

**5 LLAVES CROMADAS reversibles.**

**17 BRASS PINS:**  
12 in two rows + 5 in extra side row

**5 reversible CHROMED KEYS**



Tarjeta de Seguridad  
Security card

## medidas / sizes

A	B	C	A	B	C	A	B	C
60 mm.	(30-30)		80 mm.	(35-50)		100 mm.	(50-50)	
65 mm.	(30-35)		85 mm.	(30-55)		100 mm.	(40-60)	
70 mm.	(35-35)		90 mm.	(45-45)		110 mm.	(55-55)	
70 mm.	(30-40)		90 mm.	(40-50)		110 mm.	(50-60)	
75 mm.	(35-40)		90 mm.	(30-60)		120 mm.	(60-60)	
80 mm.	(40-40)		90 mm.	(35-55)				
80 mm.	(30-50)		95 mm.	(40-55)				



## Sistema de amaestramiento

EZCURRA ha desarrollado un sistema de amaestramiento que proporciona Comodidad, Eficiencia y Seguridad.

**Comodidad** por reducir el manejo de diferentes llaves, permitiendo abrir con una sola todas las cerraduras y cilindros habitualmente utilizados.

**Eficiencia** por permitir todo tipo de combinaciones y amaestramientos, desde una sola maestra hasta una gran maestra.

**Seguridad** por su alto grado de precisión, estando todos los amaestramientos codificados.

El sistema de amaestramiento de EZCURRA permite una gran variedad de combinaciones y variaciones, manteniendo la autonomía de cierre de cada una de las dependencias, optimizando su control y manejo.

Por todas estas ventajas, el sistema de amaestramiento de EZCURRA es demandado para comunidades de vecinos, viviendas unifamiliares, oficinas, fábricas, hoteles, hospitales y cualquier instalación de uso múltiple.

## Master keying system

EZCURRA has developed a masterkeying system that provides Comfort, Performance and Security. For comfort, Ezcurra's master keying system affords the possibility to reduce the usual bunch of keys to only one, able to open the most commonly used locks and cylinders. High Performance and Security, due to the precision and excellent technical features of our cylinders, which allow all kind of keying systems, from the simple master key suite to the grand master key one.

In this way, house entrance doors, post boxes, elevators, garages, desk, and so on, all can be easily masterkeyed to user's convenience.

Nowadays housing, condominiums, offices, hospitals and companies of any size enjoy the quality and security of EZCURRA's master keying system.



## Amaestramiento de Comunidades

Grupo de cerraduras –independientes entre sí– cada una con sus llaves propias, las cuales abren también servicios comunes como entrada principal, garaje, ascensor, cuartos comunitarios, etc.

## Amaestramiento Simple

Grupo de cerraduras cada una con sus propias llaves individuales, y una llave maestra que abre todas las cerraduras. Apropiado para oficinas, almacenes, etc.

## Amaestramiento en Grupos

Varios Grupos de cerraduras independientes, cada grupo con su llave Maestra, y una Gran Maestra que abre todas las cerraduras. Indicado para edificios públicos, hoteles, empresas, etc.

Este amaestramiento puede tener otras complejas variantes.

## Comunal Entrance Master keying

Group of Locks each one having its own individual key that gives access to its own door and all communal services i.e.: main entrance, garage, lift, terraces, storerooms, etc.

## Simple Master keying

Group of Locks each one having its own individual keys, which opens only that door, and a Master key which opens all the locks. Suitable for offices, warehouses, etc.

## Group Master keying

Several independent groups of Locks each one having its own Master key, and a Grand Master key, which opens all the doors in the locking plan. Suitable for hotels, administrative buildings, schools, companies, etc.

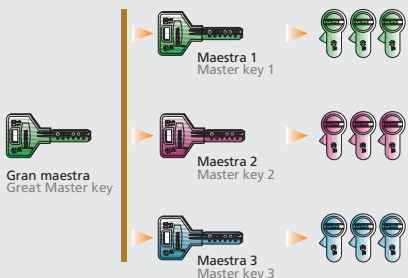
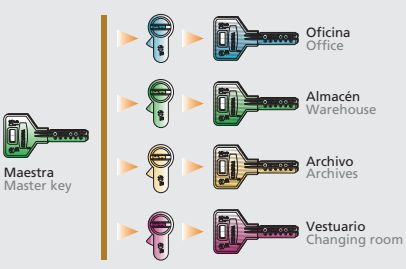
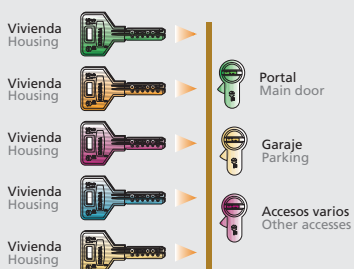

## **Ezcurra-Esko, S.A.**

Apartado (P.O.Box) 5  
20540 Escoriaza. (Guipúzcoa) Spain



Tel.: +34 943 71 51 00

Fax: +34 943 71 41 00

---

e-mail: [ezcurra@ezcurra.com](mailto:ezcurra@ezcurra.com) • [www.ezcurra.com](http://www.ezcurra.com)



#### APLICACIONES

Todo tipo de puertas, nuevas o para reemplazar existentes.

#### APPLICATIONS

Suitable for new doors or for the replacement of existing doors.

#### DISPONIBILIDAD

Este **Nuevo Sistema Automático de cierre** está disponible en cerraduras mono y multi-punto modelos: **700B, 2000B / 2075 / 2010.**

#### AVAILABILITY

This **New Automatic closing function** is available on both single and multi-point models: **700B, 2000B / 2075 / 2010.**



**La solución ideal que asegura la mayor comodidad y seguridad**

*The ideal solution to ensure maximum confort and security*



**Un clank...  
y estamos seguros**

**Clank...  
and we are safe**

Ezcurra-Esko, S.A.  
Apartado (P.O.Box) 5  
20540 Escoriaza (Gipuzkoa) Spain  
Tel.: +34 943 71 51 00 · Fax: +34 943 71 41 00



e-mail: [info@ezcurra.com](mailto:info@ezcurra.com) · [www.ezcurra.com](http://www.ezcurra.com)

**Sistema automático de cierre  
Automatic Closing System**





**clank!!**



Cuando se cierra la puerta, las barras de cierre se proyectan **automáticamente 1 vuelta**, quedando la puerta **totalmente cerrada** sin necesidad de operar el **cilindro**.

En versión **Multi-Punto** se proyectan simultáneamente las barras de cierre de caja central y auxiliares, obteniendo un **cierre simultáneo**.

Para **mayor seguridad** la **segunda vuelta** puede ser activada por medio del **cilindro**.

*When closing the door, the 4 deadbolts of the lock are **automatically** projected **one throw** and **the door pulls itself closed**.*

*And in the **Multi-Point** version the main and auxiliary locks are projected at the same time.*

*For **more security**, the **second throw** can be activated by the **cylinder**.*

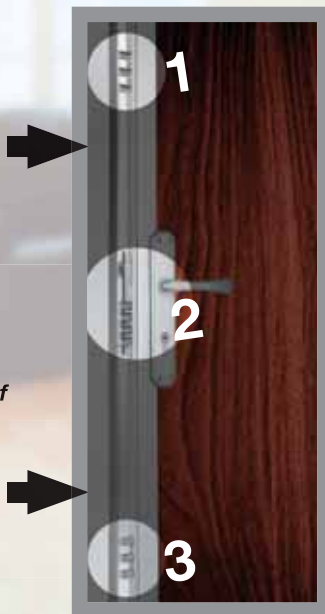

Para la apertura, accionando la manilla se retraen **simultáneamente el picaporte y las barras**, tanto si está activada la 1ª como la 2ª vuelta.

Esta Nueva Cerradura Ezcurrea mantiene el **Alto Estándar de seguridad EZCURRA**.

*To open the door pull down the handle and the main lock deadbolts and the latch bolt will withdraw **simultaneously**, so much being activated the first as the second throw.*

*This New Ezcurrea Lock maintains the **High EZCURRA Security Standard**.*



## Cierre Automático y Apertura Anti-Pánico

*Automatic Closing & Anti-Panic Opening Device*

**Nueva cerradura Ezcurrea con doble función**  
**New Ezcurrea Lock system with dual function**

## APLICACIONES

Para todo tipo de **puertas nuevas**, con una **amplia gama de posibilidades**.

### Actuando como Sistema de Bloqueo.

Cada cerradura opera individualmente, tanto con cilindros de llaves independientes como con llaves iguales o amaestradas.

### Actuando como Sistema de Bloqueo y Restricción.

El sistema opera cada cerradura separadamente, pero los cilindros están amaestrados. La llave de la Cerradura Extra opera ambas cerraduras, y el sistema Multi-Punto opera únicamente con su llave. Esta modalidad permite al usuario principal monitorizar el acceso de terceros en cualquier momento.

### Actuando como Sistema de Control de Accesos.

La función anterior puede ser ampliada creando un grupo de cerraduras Multi-Punto relacionadas por un sistema de amaestramiento. Esta función permite monitorizar el acceso a grupos tan complejos como se requiera.

## APPLICATIONS

*Suitable for new doors, with a **great range of possibilities**.*

### *Acting as Security Blocking System.*

*The system is individually activated by each lock. Both cylinders are operated by their own key, even if keys are alike or master keyed.*

### *Acting as Block & Restriction System.*

*The system operates each lock individually, but the security cylinders are master keyed: the Extra-Lock key operates both locks, and the Multi-Point lock is operated only by its own key. This allows the main user to block and monitor access of a third party anytime.*

### *Acting as Access Control System.*

*The previous feature can be enlarged creating a Multi-Point locks group linked by master keying. This allows monitoring access of as complicated groups as required.*

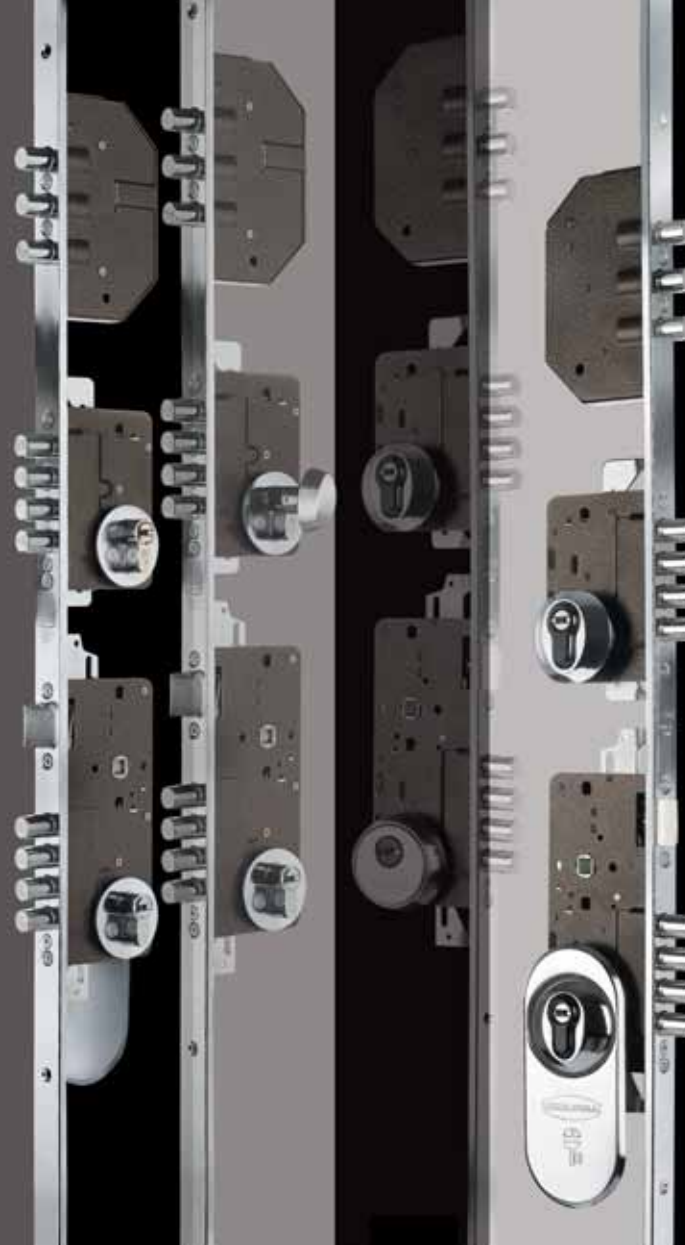

**bloqueo**  
*block*



**restricción**  
*restriction*



**control acceso**  
*access control*

**Ezcurra-Esko, S.A.**

Apartado (P.O.Box) 5  
20540 Escoriaza (Gipuzkoa) Spain  
Tel.: +34 943 71 51 00 · Fax: +34 943 71 41 00

**EZCURRA**

**Sistema Bloqueo Multi-Punto**  
**Blocking Device System**

**EZCURRA**

e-mail: [info@ezcurra.com](mailto:info@ezcurra.com) · [www.ezcurra.com](http://www.ezcurra.com)

La cerradura Multi-Punto opera como habitual: cerradura central y auxiliares son activadas simultáneamente por el cilindro de la caja central.

El Sistema Multi-Punto **puede ser bloqueado** con la **cerradura extra**: cuando se activa la cerradura extra, las barras de cierre son proyectadas y **automáticamente bloquea** el sistema Multi-Punto.

*The Multi-Point lock works as usual: Both main and auxiliary locks are activated by the cylinder of the main lock, thus the door is closed.*

*The Multi-Point locking system **can be blocked by the independent Extra Lock**: when the cylinder of the Extra Lock is activated, its deadbolts are projected and the Multi-Point system is **automatically blocked**.*

El **Sistema de Bloqueo** mantiene el alto estándar de seguridad de **EZCURRA**, e incluye **Sistema ANTI-PALANCA®**

*The **Blocking Device System** maintains the **High EZCURRA Security Standard**, and includes **EZCURRA ANTI-LEVERAGE® SYSTEM**.*



**bloqueo  
block**



**restricción  
restriction**



**control acceso  
access control**

**Para la apertura**, la Cerradura Extra debe ser abierta primero, y entonces el sistema multi-punto estará **desbloqueado**.

El Sistema **ANTI-PALANCA®** de **EZCURRA** está también incorporado.

*To **open the door**, the Extra Lock should be opened first, thus the Multi-Point system is **unlocked**.*

*The protection against forced entry by **EZCURRA ANTI-LEVERAGE® system** is also incorporated.*

**Significativo incremento del estándar de seguridad.**  
**Aumento de la resistencia anti-intrusión.**  
**Dificultando la violación por manipulación.**

***Increasing significantly the security standard.**  
**Hampering the intrusion attack.**  
**Complicating security-tampering.***



**Aportando seguridad**  
**Providing Security**





**Doble  
seguridad**

**Doble  
tranquilidad**

***Double  
security***

***Double  
tranquility***



Cierre con llave reversible de seguridad.  
Permite Igualamiento o Amaestramiento,  
tanto entre cerrojos como con cerraduras  
independientes.  
Versatilidad de aplicaciones.  
Comodidad de uso.  
Fácil instalación.

*Locking by security dimple key.  
Key Alike or Masterkeyed both among  
deadbolts as to independent door locks.  
Convenience of use.  
Multipurpose application.  
Easy installation.*



**Ezcurra-Esko, S.A.**

Apartado (P.O.Box) 5  
20540 Escoriaza (Gipuzkoa) Spain  
Tel.: +34 943 71 51 00 · Fax: +34 943 71 41 00

e-mail: [info@ezcurra.com](mailto:info@ezcurra.com) · [www.ezcurra.com](http://www.ezcurra.com)

**Nuevo CERROJO 500C Ezcurra  
con cilindro ACORAZADO de Alta Seguridad**

***The Ezcurra NEW DEADBOLT 500C  
with PROTECTIVE ARMOR High Security CYLINDER***

**Cilindro Multipunto** de alta seguridad, además ACORAZADO. Seguridad extra anti-intrusión.

*Multipoint High Security Cylinder with a pull out resistant PROTECTIVE ARMOR.*

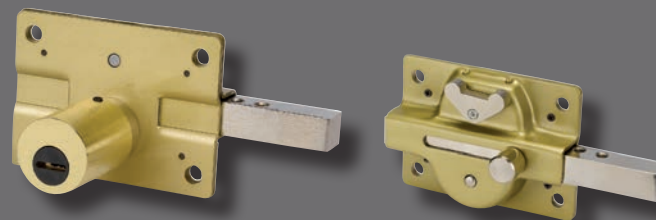

Ref.: 500C

Cilindro Exterior y Condena interior.  
*Outside Cylinder and inner clutch.*



**Protección Anti-Bumping**  
*Anti-Bumping protection*

**Anti-Extracción tanto Coraza como Rotor**  
*Pull Out Resistant Armor and Rotor*

**Anti-Taladro**  
*Drill Resistant*



Cilindro Alta Seguridad Multipunto de **dobles anclaje**, con CORAZA y rotor de **acero templado**.

*High Security Multipoint Cylinder, double fitting, with PROTECTIVE ARMOR & Plug / Rotor of hardened steel.*

**Cierre por barra** de acero 16 mm y proyección 40 mm.

*Locking by deadbolt* of steel bar 16 mm and 40 mm projection.



Ref.: 550C

Doble cilindro: Interior y Exterior.  
*Double Cylinder: Out & Inner side.*

## PACK

**CERROJO**  
*DEADBOLT LOCK*



**CILINDRO SEGURIDAD**  
**EUROPERFIL**  
*High SECURITY CYLINDER*

Se incluye cilindro multipunto de seguridad igualado al cerrojo, con el que podrá sustituir el de su cerradura actual, permitiéndole operar con la **misma llave** tanto el Cerrojo como la Cerradura.

*The pack includes a high security multipoint cylinder matched to the deadbolt lock, to replace the existing door lock cylinder, thus allowing to operate with the same key both Deadbolt and Door Lock.*

En todo tipo de puertas, como cierre individual o como complemento de seguridad en puertas con cerraduras ya incorporadas.

*Suitable for all types of doors, used as individual locking or as additional locking for doors with already fitted locks.*



Ref.: Pack 500C

Ref.: Pack 550C

**Aportando seguridad**  
*Providing Security*